

# Conference and Events

---



Expect a hotel full of  
character, where everything  
is delivered with an informal,  
unstuffy attitude.

---



## A warm welcome to voco®

---

### RELIABLY DIFFERENT

Whether it's a work trip, weekend get-together or a family celebration, at voco® Grand Central Glasgow you'll have everything you need and more. With its lavish Grand Room and Champagne Central Bar, it quite simply is the place to be seen.

Welcoming guests since 1883, our distinguished hotel has numerous meeting & event spaces and can welcome up to 400 guests. We're on hand to host, making your event as smooth and enjoyable as possible.

Queen Anne architecture and art deco interiors join together creating a grand atmosphere amongst thoughtfully restored original features. Climb the hotel's marble staircase, following in the footsteps of Hollywood stars and politicians, including Frank Sinatra, Gene Kelly and Winston Churchill. Perfect for photos.

From intimate family affairs to grand celebrations of up to 400 guests, whatever you have planned, let us bring your event to life.

Eat, drink and celebrate with friends or get some work done. Explore the city and all the grandeur it has to offer – all on our doorstep. Take a wander. Take your time, it's all yours.



# Come on in

## EAT, SLEEP AND EVERYTHING IN BETWEEN

The Grade II listed hotel is an iconic Glasgow landmark and is ideally located in the heart of the city; Princes Square, Kings Theatre, Glasgow School of Art, SECC and the Science Centre are all within easy walking distance. It is the perfect base to discover the beauty and splendour of this 15th Century city.

After a day of work or play, dining at voco® Grand Central Glasgow is a memorable affair; a visit to our Champagne Central bar is a must; sip on a cocktail whilst overlooking Glasgow Central Station and recall the golden age of travel.

When it's time to relax, you'll discover a choice of stylish rooms and suites ranging from bright and airy premium rooms, loft rooms and double doubles with en-suite and free Wi-Fi to our vibrant king premium deluxe rooms with lounge.

No matter what brings you to our door, whether it be business or pleasure, we're here to play host and make sure you have everything you need. It's time to eat, sleep and everything in between.



# The Grand Room

## ENTRESOL LEVEL

An elegant room offering all the space you need for a larger event. During recent refurbishments, it retained its original ornate features of marble pillars, high ceilings, unique fireplace and double windows, being the only ballroom with natural daylight in Glasgow.

It's a room which truly lives up to its name.





# The Victoria and The Regent

## ENTRESOL LEVEL

These enchanting adjoined suites at the top of the grand staircase offer a unique space for any large event. With three original arched windows, The Victoria and The Regent provide the perfect space for more informal events and celebrations.

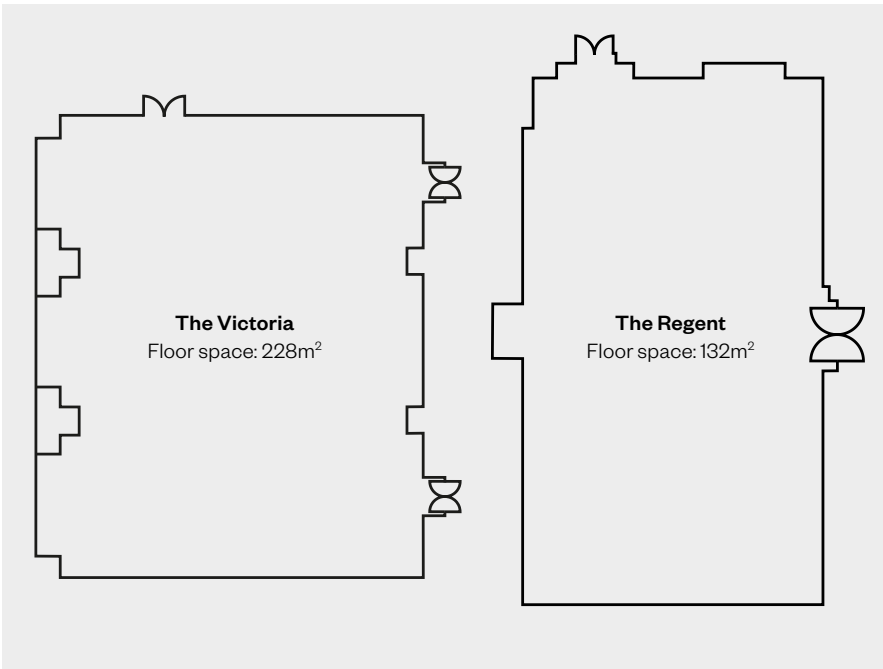

# The Buchanan

## ENTRESOL LEVEL

An elegant room with original features adaptable for a wide range of events, from larger board meetings to private dining for up to 40 guests.



# The Great Western

## ENTRESOL LEVEL

Perfect for meetings, or private dining for up to 50 guests.

Each of our rooms benefit from natural daylight and are all equipped with up-to-date AV and IT.





# The Wellington

ENTRESOL LEVEL

Unique and flexible, this room is adaptable for both formal and informal events. Welcoming up to 50 guests.



**The Wellington**  
Floor space: 53m<sup>2</sup>



# The Clyde and The Queens

FIRST FLOOR

This wonderful suite, located on the first floor, is ideal for more intimate wedding or celebration events. The Clyde and The Queens adjoining suites create an idyllic private space for a celebration occasion.



**The Clyde**  
Floor space: 88m<sup>2</sup>



**The Queens**  
Floor space: 57m<sup>2</sup>



# Capacities and dimensions

Entresol Level	Dimensions L x W x H (m)	Floor Space (m²)	Boardroom	Cabaret	Classroom	Dining	Dinner dance	Theatre	U-shape	Reception	Wedding
Grand Room	31.44 x 13.73 x 8.3	444	-	248	336	400	360	400	-	600	360
Victoria	17 x 13.44 x 2.55	228	-	160	200	240	200	300	-	300	200
Regent	15.5 x 8.53 x 3.75	132	48	72	84	100	80	100	50	180	100
Buchanan	8.96 x 5.41 x 3.65	45	24	32	24	40	-	40	24	40	40
Great Western	10.7 x 5.41 x 3.98	58	26	36	24	50	-	50	24	50	50
Wellington	10.69 x 4.95 x 3.89	53	26	36	24	50	-	50	24	50	50

First Floor	Dimensions L x W x H (m)	Floor Space (m²)	Boardroom	Cabaret	Classroom	Dining	Dinner dance	Theatre	U-shape	Reception	Wedding
The Clyde	15.54 x 5.67 x 3.82	88	50	56	30	80	60	80	40	100	80
The Queens	10.56 x 5.4 x 4.9	57	-	-	-	40	-	40	25	60	40

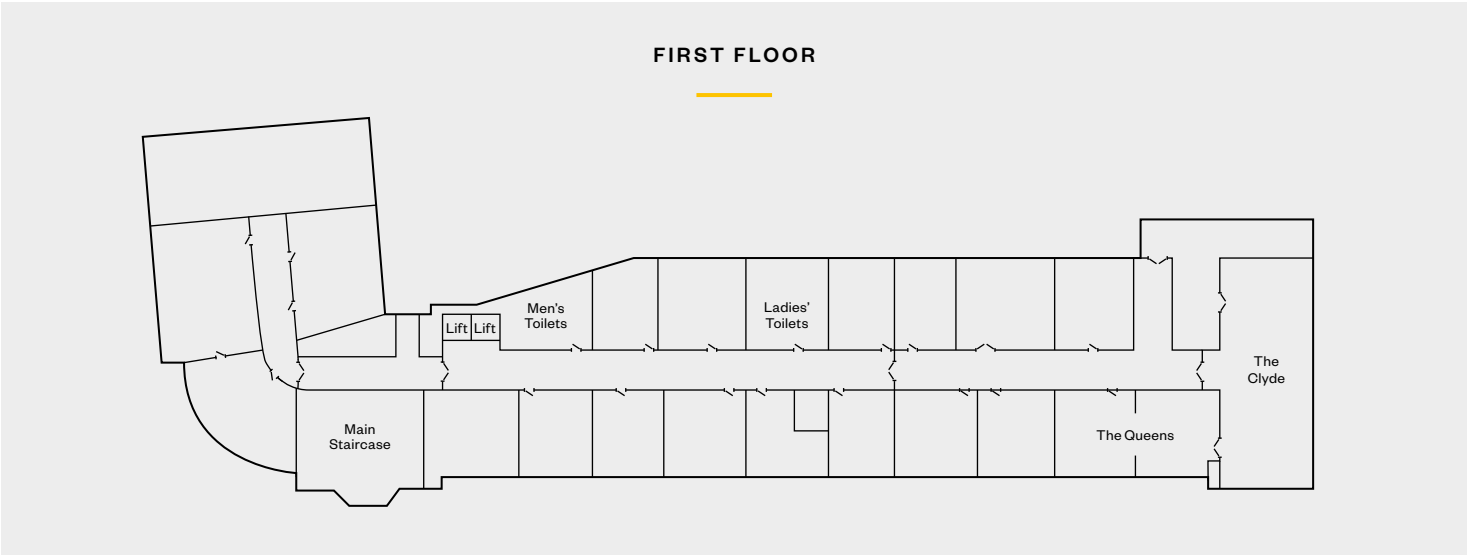
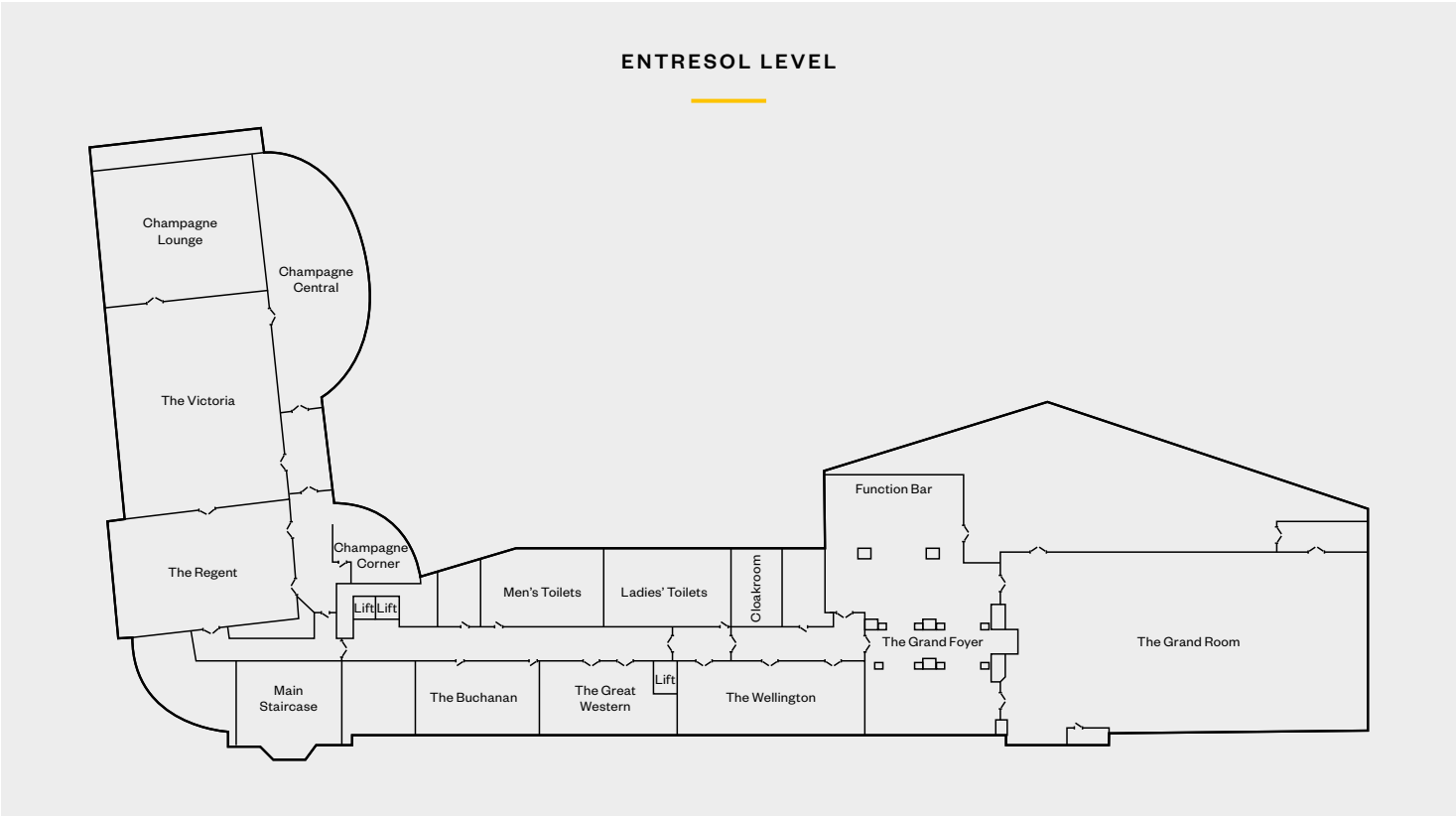







# VOCO®

AN IHG HOTEL

---

## Grand Central Glasgow

# Finding us

---

### TRAVEL BY AIR

Glasgow International Airport, 7 miles

### TRAVEL BY RAIL

Central Station, 0 miles

### TRAVEL BY ROAD

1 mile to / from M8 J19 | Edinburgh, 48 miles | Newcastle, 152 miles | Manchester, 217 miles