

BALLROOM

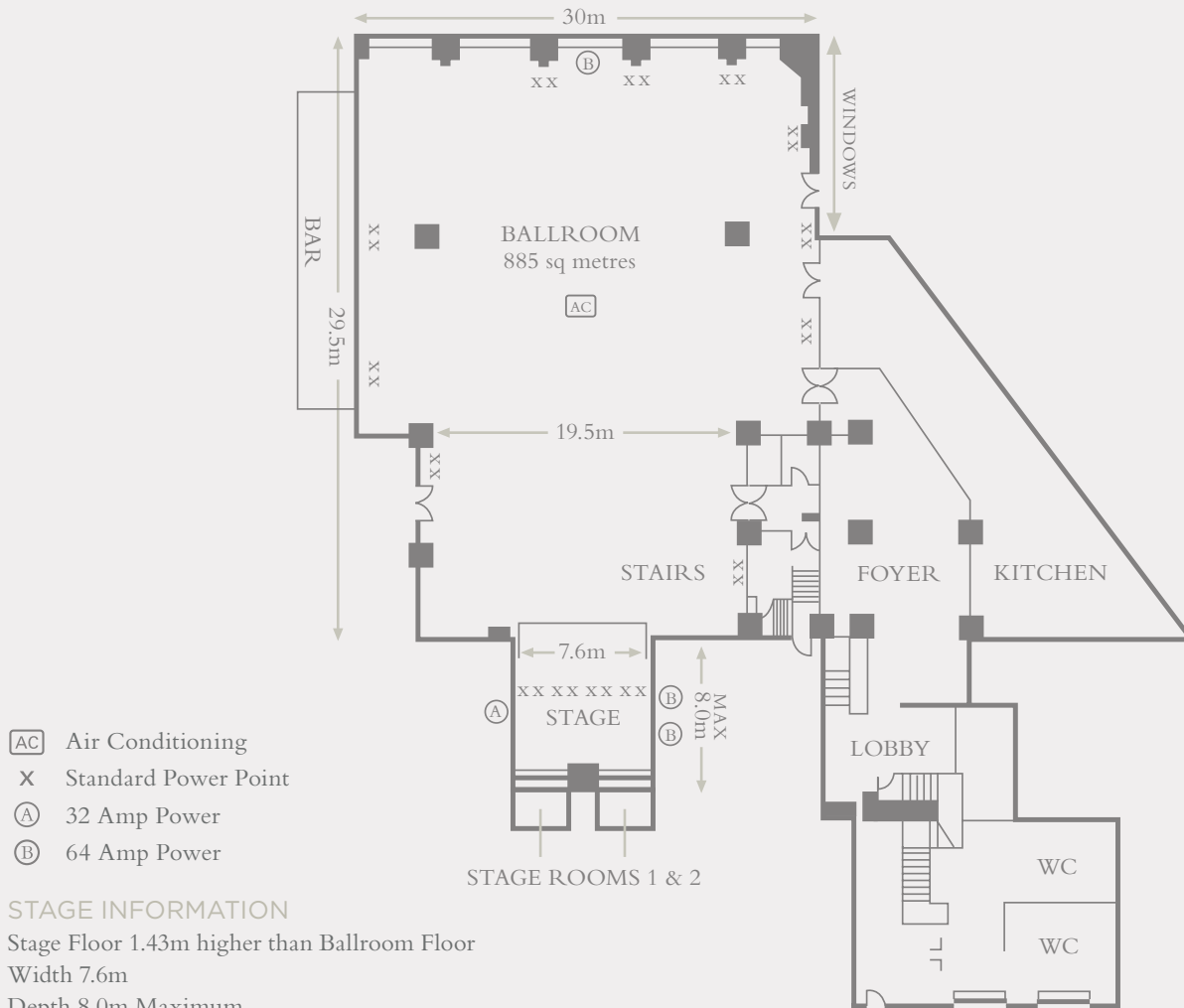

STAGE INFORMATION

Stage Floor 1.43m higher than Ballroom Floor

Width 7.6m

Depth 8.0m Maximum

Star Curtain is full width of stage 4.5m from the front

Stage Height is 4.5m to 4.9m

BALLROOM ADDITIONAL TECHNICAL INFORMATION

Direct Street level access through 1.4m wide double doors

There are 6 Lighting Gantry Fixtures in the ceiling tested up to 500kg per line of 3

All rooms are equipped with hard-wired internet connection and Wi-Fi.

For full room dimensions please see Capacities insert.

THE BUSINESS CENTRE

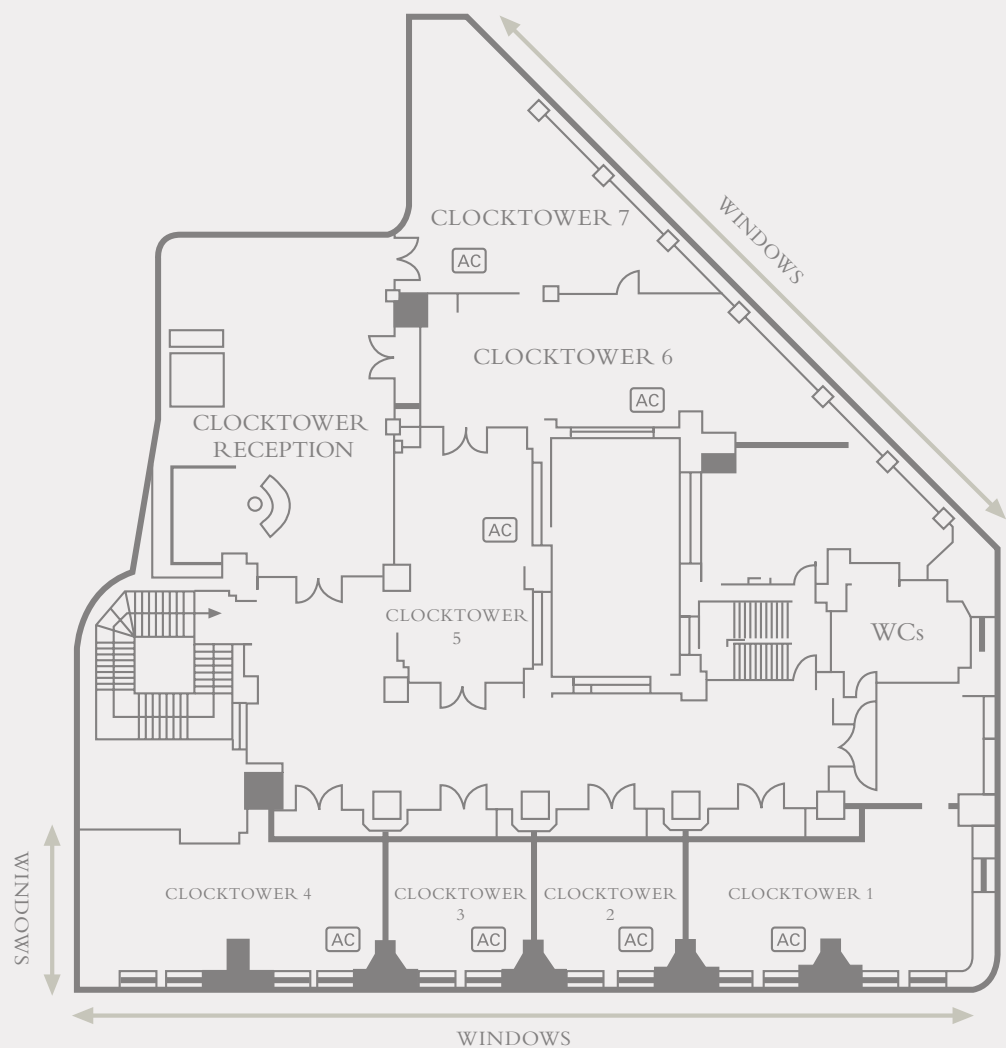

 Air Conditioning

All rooms are equipped with hard-wired internet connection and Wi-Fi.
For full room dimensions please see Capacities insert.

THE WHITWORTH ROOMS

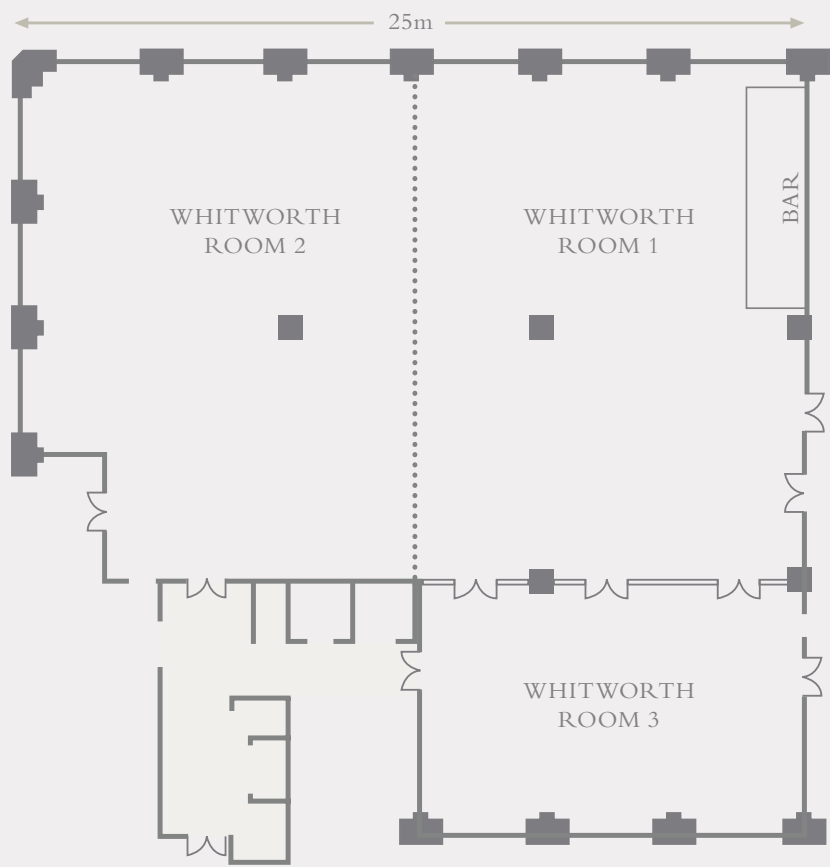

AT A GLANCE

Area: 596.72 sq. m
Reception: 650
Theatre: 450
Cabaret: 230
Classroom: 200
Dinner: 320
Wedding: 250

All rooms are equipped with hard-wired internet connection and Wi-Fi.
For full room dimensions please see Capacities insert.

THE DIRECTORS' & THE OAK ROOMS

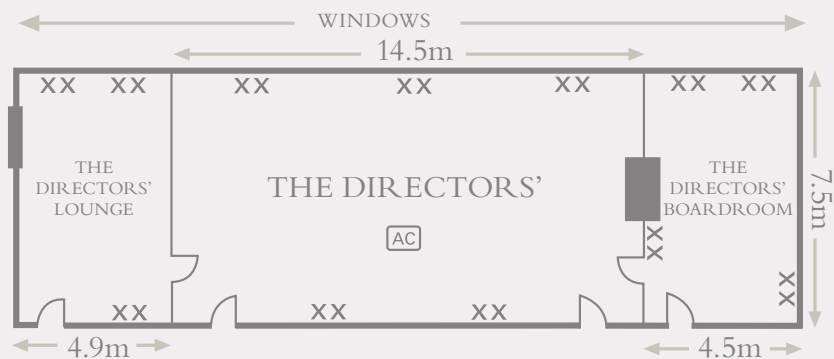

SECOND FLOOR

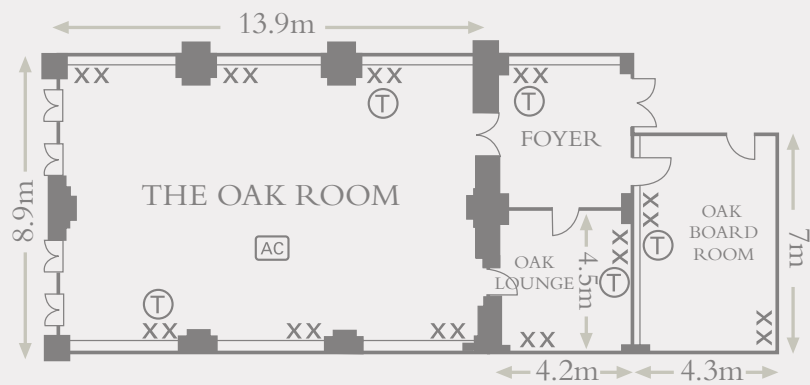

- AC Air Conditioning
- X Standard Power Point
- T Telephone Point

All rooms are equipped with hard-wired internet connection and Wi-Fi.
For full room dimensions please see Capacities insert.