



THE STRINGS BY
INTERCONTINENTAL®
TOKYO

ACCESS



From Haneda Airport:

- From Haneda Airport International Terminal - Shinagawa Station approx. 14 min.
- From Haneda Airport Domestic Terminal - Shinagawa Station Approx. 16 min.

From Narita Airport:

- From Narita Airport take the JR Tokyu Narita Express to Shinagawa Station approx. 70 mins
- From Narita airport take the JR Rapid from Narita Airport to Shinagawa Station approx. 90 mins

Limousine Bus (Narita Airport)

Departure from Narita

Shinagawa Station Konan Exit Departure.

*Airport Limousine Bus service has been temporarily suspended until further notice. For the latest information, please visit [their website](#). Thank you.

Train:

- Each JR Line, Shinkansen lines and Keihin Electric Express Railway are a one minute walk from Shinagawa Station Konan Exit.
- Approximately 10 mins from Tokyo Station to Shinagawa Station via JR Line.
- Approximately 20 mins from Shinjuku Station to Shinagawa Station via Yamanote Line.

【Reservations must be made one day prior.】

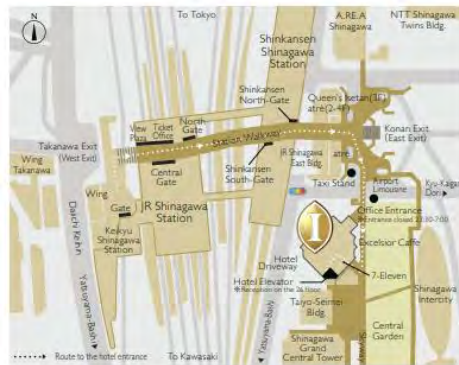

- For reservations: Limousine Bus Reservation Center (Tel: +81 3 3665 7220)
- Reservation Center hours: Mon. - Fri. 9:00-19:00 / Sat. Sun. & Holidays. 9:00-18:00
- *reservations must be made one day prior.



DESTINATION





MT. FUJI

 Approx. 2.5 hours
 Approx. 1.5 hours





NIKKO

 Approx. 3 hours
 Approx. 2 hours





OSAKA

 Approx. 2.5 hours
 Approx. 6.5 hours

WELCOME TO JAPAN





NAGOYA

 Approx. 1.5 hours
 Approx. 4.5 hours





THE STRINGS BY
INTERCONTINENTAL
TOKYO

HAKONE

 Approx. 2 hours
 Approx. 2 hours



YOKOHAMA

 Approx. 40 minutes
 Approx. 45 minutes

THE STRINGS BY INTERCONTINENTAL TOKYO 3 KEYS



Conveniently located a 10-minute walk via covered walkway from Shinagawa station, and 20 minutes via taxi from Haneda airport.

Personalized service that combines InterContinental's global know-how with the team's charming insights into Japanese culture.

Club InterContinental Lounge boasts panoramic views over Tokyo, immaculate service and a refined ambience to truly relax.

GUEST ROOMS





Guest rooms

Strings by Intercontinental Tokyo guest rooms exude a warm, calming atmosphere, with ample square footage and high-quality furniture and fixtures. Thoughtful touches create a tranquil home away from home and practical extras, including complimentary Internet access allow you to stay productive. Modern extras make it easy to stay connected, while a plush pocket-coil mattress ensures a restful night's sleep. Stunning views of the city skyline guarantee you make the most of your stay in Tokyo.

ROOM CONFIGURATION



TOTAL ROOMS 203

Suite (70sqm – 104sqm)

- Club InterContinental The Peak Suite x 1 room
- Club InterContinental Suite 2 Twin x 3 rooms
- Club InterContinental Suite 1 King x 2 rooms

Club InterContinental room (35.5sqm – 40sqm)

- 2 Twin Premium with Lounge Access x 12 rooms
- 1 King Premium with Lounge Access x 24 rooms
- 1 King Premium with Lounge Access Luxury Bath View x 5 rooms

Premium (32.5sqm – 38sqm)

- 1 King Premium x 12 rooms
- 2 Twin Premium x 36 rooms
- 2 Twin Premium Bath Shower Combination x 4 rooms

Classic (23sqm – 31.5sqm)

- 1 King Classic City View x 47 rooms
- 1 King Classic x 47 rooms
- 1 Double Classic x 10 rooms

CLUB INTERCONTINENTAL THE PEAK SUITE



1x

- Room Size: 104sqm 1-3 adults
- 1 King 1 Bedroom Suite Luxury View Bath
- Includes access to one of Tokyo's most exclusive club lounges, Club InterContinental.
- Located on the hotel's 32nd floor, the suite affords magnificent views of Tokyo Bay and the skyscrapers of Shinjuku and Roppongi. Includes an elegant dining area, a fully equipped living area (with AV system), and a jacuzzi bathtub in the bathroom, while refined decor and high-end finishing complete the experience.

CLUB INTERCONTINENTAL SUITE (KING / TWIN)



5x

- Room Size: 70sqm 1-3 adults
- 1 King Bed or 2 Twin Beds
- Includes access to one of Tokyo's most exclusive club lounges, Club InterContinental.
- Our Suites provide unparalleled luxury and exclusive amenities that ensure a memorable stay. You'll find high-end furnishings, thoughtful extras, and elegant decor that soothes from the moment you walk in. Relax in your view bath and admire spectacular views of Shinagawa and Tokyo Bay from the living room, bedroom.

PREMIUM ROOM WITH LOUNGE ACCESS (KING / TWIN)

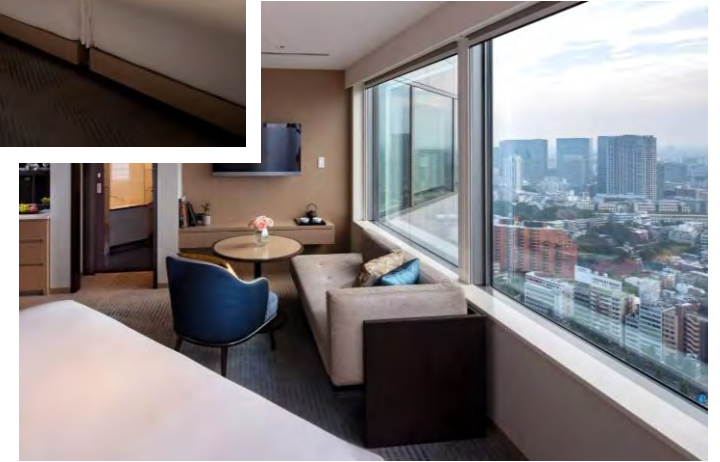

41x

- Room Size: 35.5 - 40sqm 1-3 adults
- 1 King Bed or 2 Twin Beds
- Includes access to one of Tokyo's most exclusive club lounges, Club InterContinental.
- Each of these rooms boasts spectacular views, perfect for inspiring mornings over a cup of coffee or sipping champagne above the bright lights of the Tokyo skyline.

PREMIUM ROOM (KING / TWIN)

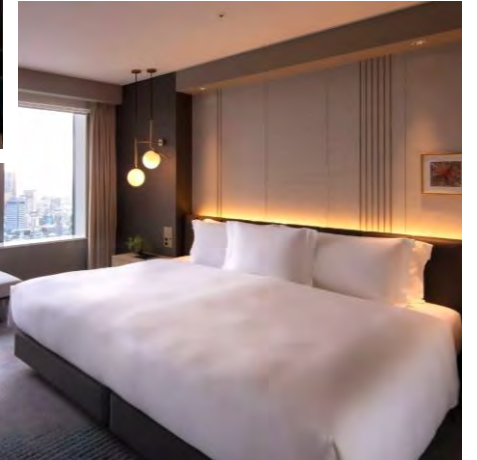

52x

- Room Size: 32.5 - 38sqm 1-3 adults
- 1 King Bed or 2 Twin Beds
- Discover the elevated comfort of our Premium Rooms at The Strings by InterContinental Tokyo. The rooms offer a warm and soothing atmosphere with a touch of sophistication. With ample space and high-quality furnishings, you'll find everything you need to make the most of your Tokyo stay.

CLASSIC ROOM (KING)

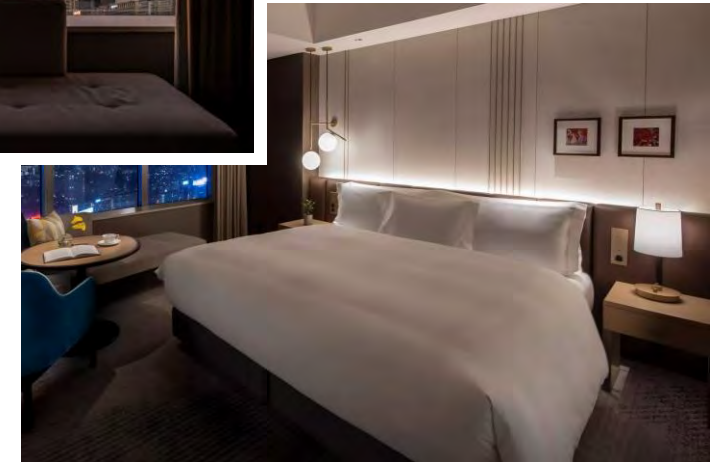

104x

- Room Size: 23 – 31.5 sqm 1-2 adults
- 1 King Bed or 1 double bed
- Classic Room provides a spacious, inviting retreat. Modern extras make it easy to stay connected, three-meter-high ceilings and spacious rooms provide an opportunity to spread-out and relax, while a plush pocket-coil mattress ensures a restful night's sleep. Stunning views of the city skyline guarantee you make the most of your stay in Tokyo.

CLUB INTERCONTINENTAL



CLUB INTERCONTINENTAL

Guests staying in our Club InterContinental rooms or suites enjoy access to one of Tokyo's most exclusive lounges. From the moment you step into the Maestro Lounge, you'll be greeted with private check-in, a refreshing welcome drink, and panoramic views of Tokyo — a colorful orchestra awaiting your command. Our team prides itself on getting to know the preferences of each guest and providing an enriching, luxurious experience. Whether you wish to taste delicious Japanese delicacies, learn about the best places to visit, spend time with your loved ones, or simply have some quality alone time, the Club InterContinental Lounge at The Strings provides personalized service and a refined ambiance.

Benefit

Access to Club InterContinental Lounge

- Complimentary breakfast
- Afternoon tea service
- Evening cocktail service

Concierge service

Personalized check-in and check-out at the Club InterContinental lounge

Pressing service

20% discount on laundry services

Turndown service

Priority reservations at hotel restaurants

Shoe shine service



COMPLIMENTARY INCLUSIONS



BREAKFAST

The culinary team at the Club InterContinental Lounge prepares exquisite international and local Japanese breakfast dishes using seasonal, high-quality produce. You'll also find a lovely buffet breakfast, which includes fresh produce, pastries, healthy juices and more. Espresso drinks, coffee, and a wide selection of black and herbal teas are available. (7:00 a.m.~11:00 a.m)



AFTERNOON TEA

Experience a refined afternoon tea experience at the Club InterContinental Lounge. You'll find seasonal, high-quality teas, Japanese desserts, and other local delicacies. (2:30 p.m.~4:30 p.m.)



EVENING COCKTAILS

A fantastic selection of canapés and cocktails are served each evening at the Club InterContinental Lounge. Our experienced bartenders use carefully selected local, seasonal, and international ingredients to craft tempting creations perfect for savoring before a night on the town or dinner at the hotel. (5:30 p.m.~7:30 p.m.)



RESTAURANTS AND BAR



THE SCORE DINING

MELODIA ITALIAN GRILL



The expert culinary team here artfully showcases grilled Italian specialties, crafting exquisite dishes in front of your very eyes in our dynamic open kitchen. The menu is composed around themes of seasonality and time, and the dishes themselves are characterized by moving presentations and textures that flow like music. The courses play like a song, with one melody leading into another, creating an upbeat mood for wine tastings and social gatherings.



CHINA SHADOW



China Shadow perfectly complements Rhythmos and Melodia, connecting the views of Tokyo below with the atrium within, mirroring the harmony of music's separate elements. Here techniques and flavors dating back four thousand years come together to create spectacular aromas, tastes, colors, and textures to be experienced by all five senses. New ingredients find harmony with these age-old recipes and embody the restaurant's theme of "new journeys and new discoveries." Enjoy delicate dim sum, exquisite wine pairings, and imperial dining in this beautiful space.



CHINA SHADOW
HARMONIA

KAZANE TEPPANYAKI



In the center of the atrium, Kazane Teppanyaki connects Rhythmos and Melodia. Rounding out the musical elements of rhythm, melody, and harmony, the timbre of the sizzling teppans and the dynamic sounds and scents of our cooking stations add warmth and depth. You'll discover elaborate dishes served in a varied tempo guided by the Japanese concepts of wabi-sabi and traditional music Gagaku's jo-ha-kyu form, which requires a clear beginning, middle, and pinnacle to each meal.



RHYTHMOS CAFE AND BAR



Rhythmos Cafe and Bar is your entrance to the world of The Score Dining. The design is inspired by rhythm, one of the four elements of music that provides structure to the composition. The menu here is like a musical arrangement, balancing the fast beats of bold, sharp flavors with slower, milder tempos. Located on the 26th floor, beneath a magnificent 27-meter-high atrium, the lively atmosphere and colorful decor are perfect for catching up with friends, meeting colleagues, or enjoying a drink before exploring Tokyo's vibrant nightlife.

R H Y T H M O S
CAFE AND BAR



BANQUET ROOMS

BANQUET CAPACITY CHART

Dramatically positioned on the 26th floor, The Strings' inviting venues are able to accommodate a variety of gatherings, and our dedicated team will work closely with you to provide an elevated level of service, ensuring that you and your guests have an unforgettable experience.

	Floor Area		Ceiling Height	Banquet	Reception	Classroom	Theater	Board Room	U-shape
	sq m	sq ft	m	pax	pax	pax	pax	pax	pax
Ribalta	180	1,937	3.4	100	100	70	100	40	30
Ribalta A	103	1,108	3.4	48	50	35	60	24	20
Ribalta B	71	764	3.4	27	40	24	40	14	10
Sonor	95	1,022	3.3	40	50	36	50	18	24
Harmonia	240	2,583	3.4	120	140	70	100	50	40
Etude	65	700	3.4	30	40	30	80	26	21



R I B A L T A

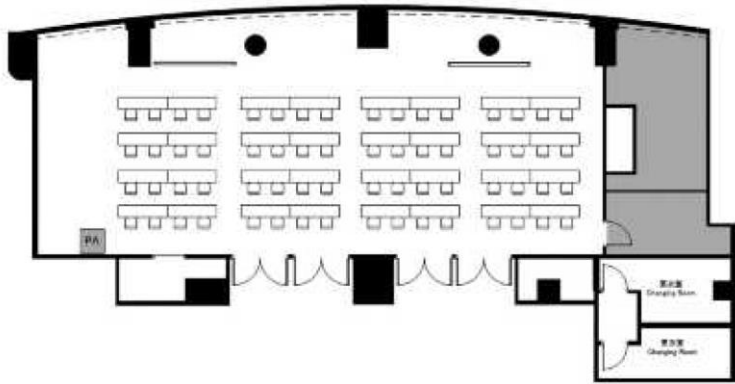

Classroom / Capacity 64 pax

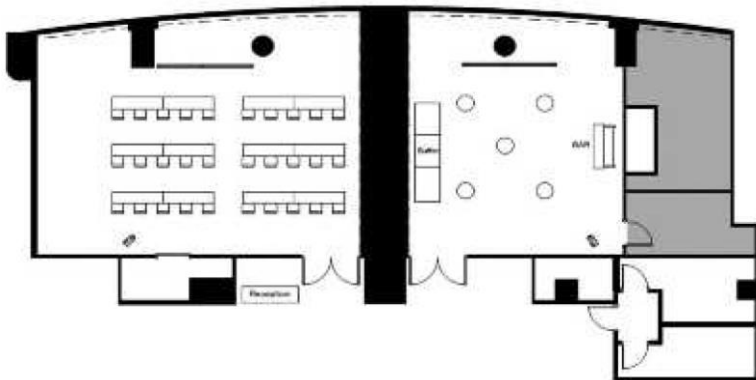

Divisible / Capacity 30 pax



Our Largest Dedicated Event Space

Ribalta features dramatic skyline views and a design reminiscent of a New York loft. This flexible event space is great for corporate meetings, product launches, training seminars, and social events.

Floor: 26F

Area size: 180sqm

Height: 3.4m

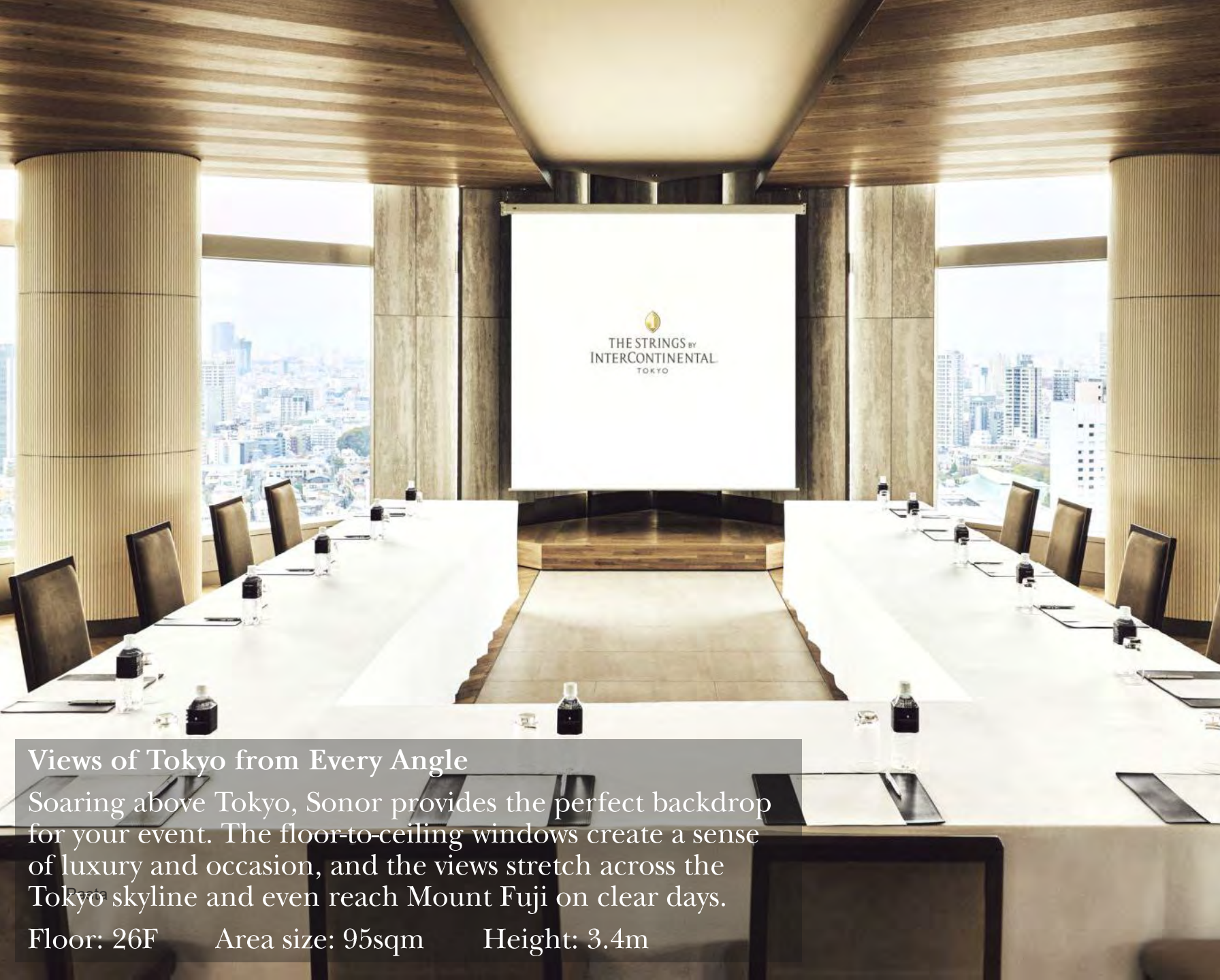

Views of Tokyo from Every Angle
Soaring above Tokyo, Sonor provides the perfect backdrop for your event. The floor-to-ceiling windows create a sense of luxury and occasion, and the views stretch across the Tokyo skyline and even reach Mount Fuji on clear days.
Floor: 26F Area size: 95sqm Height: 3.4m

 SONOR

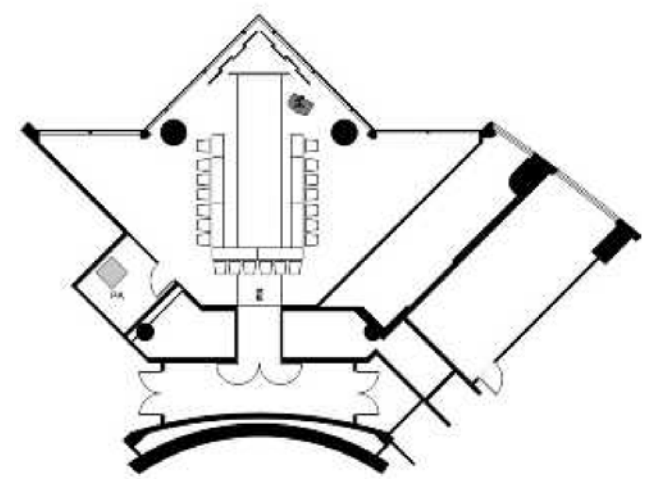

U-shape / Capacity 24 pax

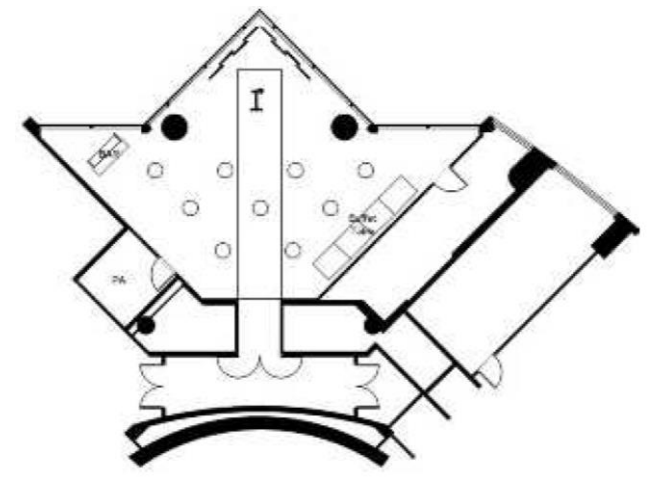

Cocktail / Capacity 50 pax



HARMONIA

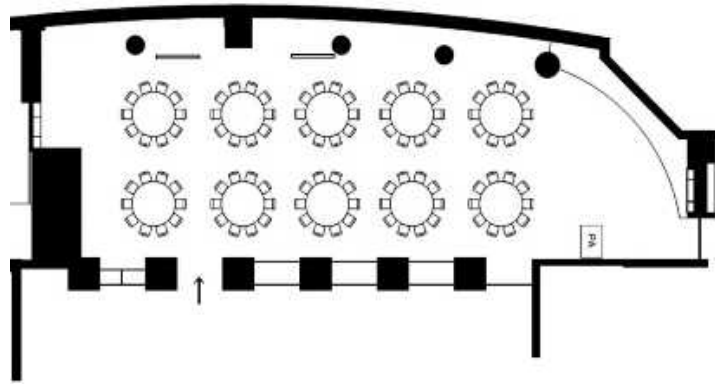

Banquet / Capacity 100 pax

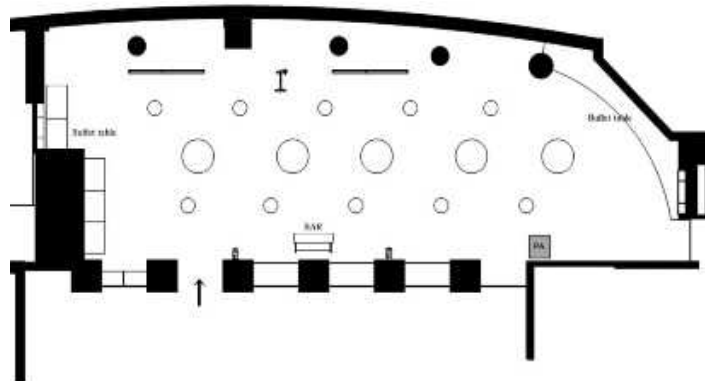

Cocktail / Capacity 140 pax



Banquet with a Chic and Relaxing Feel

Towering 110 meters above street level, Harmonia is characterized by a glamorous yet chic ambiance created by a unique décor of contrasting brown shades, overlooking the dazzling Tokyo's skyline. Its size is best suited for corporate functions, receptions or dinner parties.

Floor: 26F Area size: 240sqm Height: 3.4m

FLOOR PLAN

27-32 F	Guest Room Floors (Total 203 rooms) Fitness Room (27F)
26 F	Atrium Lobby Floor: Front Desk, Concierge Desk Restaurant & Bar Melodia Italian Grill, China Shadow Kazane Teppanyaki, Rhythmos Cafe and Bar Event Space: Ribalta, Sonor. Harmonia Multifunction Event Space: Etude Private Dining Rooms: Accord, Ivory Business Corner
2 F	Entrance: Connects to the Skyway walk for JR Shinagawa Station.
1 F	Main Entrance: For guests arriving by car, located at the entrance of Shinagawa East One Tower.
B1 F	Exclusive hotel guest parking on B1: Please inquire about our rates available for overnight guests.

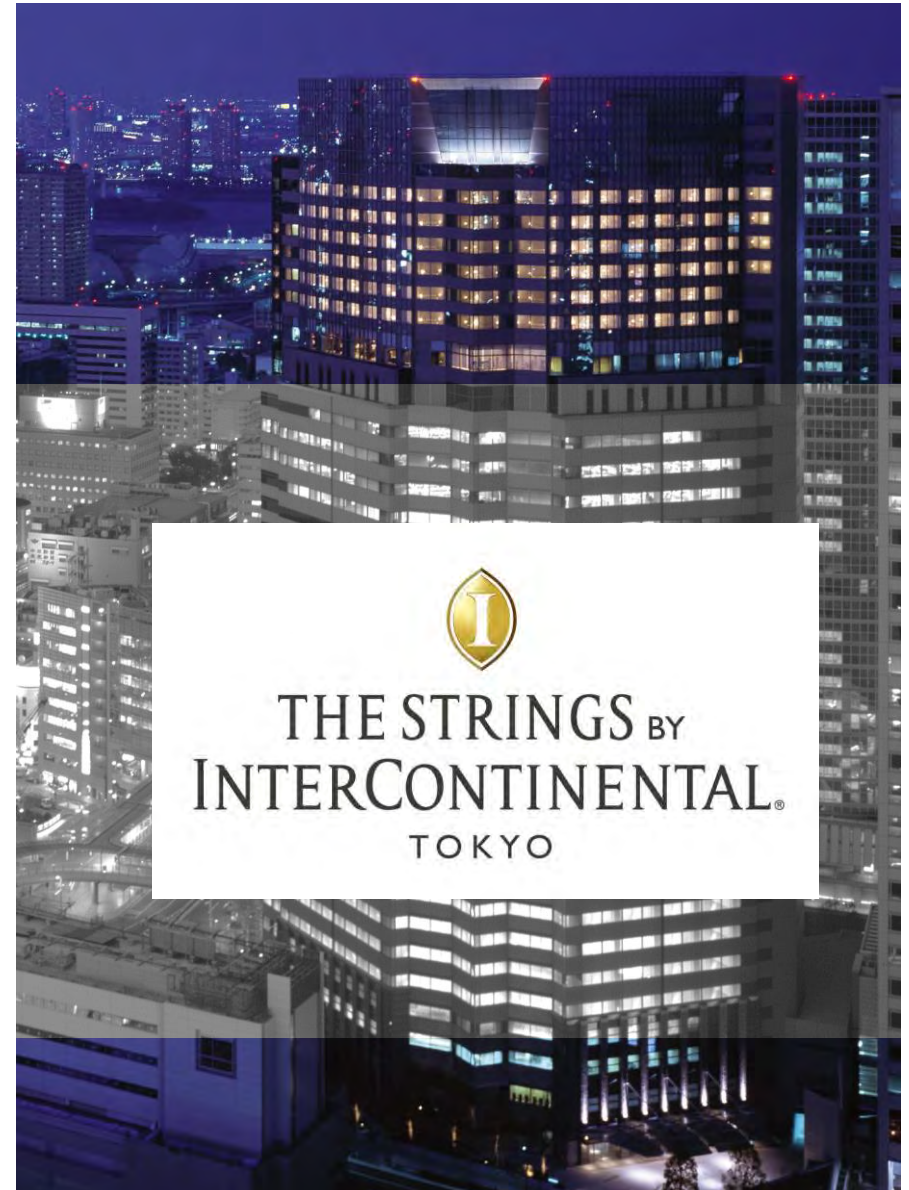



CONTACT US

The Strings by InterContinental Tokyo, Sales & Marketing

TEL: +81 3 5783 1120

E-mail: corporate@intercontinental-strings.jp

Web site: www.intercontinental-strings.jp/

