

INTERCONTINENTAL NEW YORK BARCLAY

MEETINGS & EVENTS



HERITAGE

Following a multi-million dollar redesign, the InterContinental New York Barclay welcomes guests in refined residential style hearkening back to its exclusive origin. The Barclay was built in 1926 as part of Grand Central's urban design plan which launched Manhattan's midtown east renaissance. With a fashionable yet homelike atmosphere and distinguished Federalist décor, the hotel quickly became the place to be among the New York social register set. Today's business and leisure travelers, movie stars, political figures, diplomats and United States Presidents relish the hotel's warm ambiance, prime location and dignified world-class service.

LIMITLESS LUXURY

Our facilities feature 702 well-appointed guest rooms and suites, including our Presidential Suite and Harold S. Vanderbilt Penthouse Suite. Nine function rooms, including a 5,000-square-foot Grand Ballroom, 3,500-square-foot Empire Ballroom and 4,500-square-foot pre-function area, total nearly 20,000-square-feet of meeting and event space. The Barclay is the ideal location for corporate gatherings, board meetings, conferences and the city's most distinctive weddings and social events for 20 for 450 guests.

You can count on white glove support throughout your entire planning process. From booking to staging, our sophisticated international team of event experts will customize every detail, delivering seamless, stress-free events that exceed all expectations.

LOCALE

The Barclay is located in the heart of midtown Manhattan's East Side just off Park Avenue and within steps of Madison Avenue, Fifth Avenue shopping, dining, Broadway theaters, museums, Rockefeller Center, Times Square, Central Park and the United Nations.

CUISINE

The Gin Parlour, offering local sustainable options and organic cuisines, is open 7 days a week. Daily offerings include our signature International Breakfast Buffet, lunch, lite bites and dinner in addition to a 1920's inspired Gin Bar that serves 88 different types of gin.

RESPONSIBLE BUSINESS

The Barclay practices the principles of the Triple Bottom Line: economic prosperity, social responsibility and environmental protection. Our sustainability strategy aligns with the United Nations 2030 Agenda for Sustainable development. Using the 17 Sustainable Development Goals as a platform, we aim to become the benchmark of the hospitality industry. Nearly all food offered at the hotel is organic, seasonal, natural or local. The Barclay's waste management program is one of its many initiatives aimed at reducing its carbon footprint, including recycling, composting and reduced paper consumption. Hotel lighting is achieved with Light Emitting Diodes (LED).

EXPERIENCE







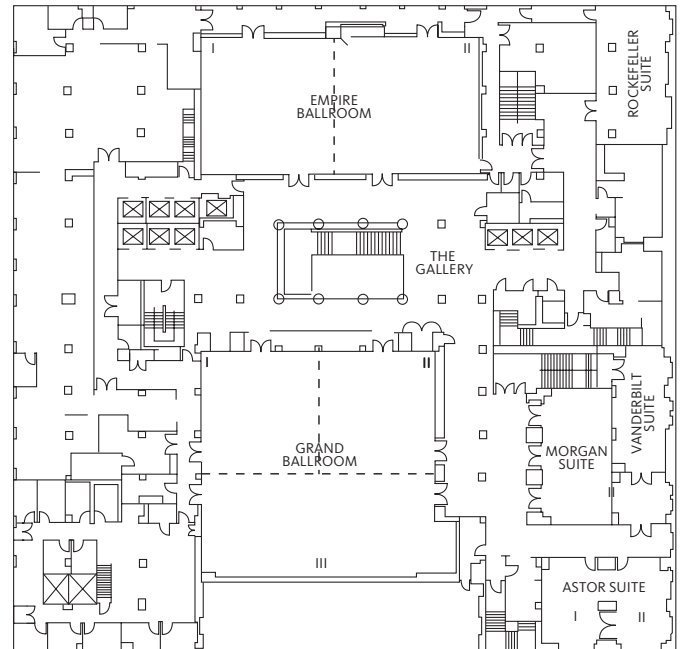
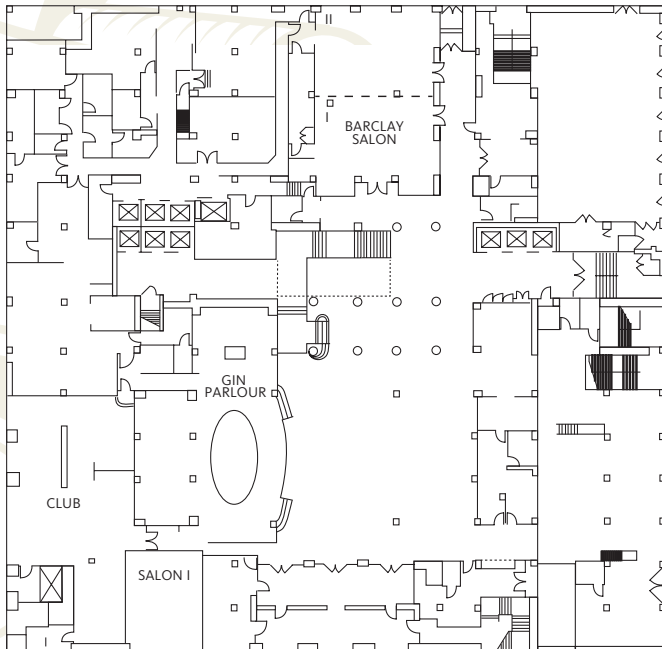

An all-night party in a museum, a flyover Manhattan, a vintage train journey along the Hudson River and a private tour with New York's most noted art, history and fashion experts, are just a few of our exclusive offerings to captivate your guests.

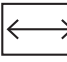
AMENITIES

- Club InterContinental®
- Wireless Internet
- Foreign Currency Exchange
- 21 International Channels
- Concierge
- In-room Dining
- 24-hour Business Center
- 24-hour Fitness Center
- 24-hour Valet Parking
- Pet-friendly
- PressReader App

FLOORPLANS & CAPACITIES



ROOM	 LENGTH	 WIDTH	 SQ. FT	 RECEPTION	 ROUNDS	 THEATER	 CLASSROOM	 U-SHAPE	 HOLLOW SQUARE	 CONFERENCE
LOBBY LEVEL										
BARCLAY SALON	55'	36'	2,043	230	140	200	120	39	54	40
BARCLAY SALON I	37'	26'	1,012	115	70	90	54	30	36	28
BARCLAY SALON II	37'	29'	1,016	115	70	90	54	30	36	28

MEZZANINE LEVEL										
THE GALLERY (PRE-FUNCTION)	-	-	4,500	300	-	-	-	-	-	-
GRAND BALLROOM	72'	68'	4,954	500	450	500	350	78	108	75
GRAND BALLROOM I	34'	34'	1,222	140	90	100	60	33	42	26
GRAND BALLROOM II	36'	34'	1,287	140	90	100	60	33	42	26
GRAND BALLROOM III	72'	32'	2,400	220	200	290	120	51	72	54
EMPIRE BALLROOM	86'	41'	3,546	350	280	350	180	84	96	68
EMPIRE BALLROOM I	45'	42'	1,856	170	120	180	111	42	60	32
EMPIRE BALLROOM II	41'	40'	1,554	150	100	160	75	42	54	30
ASTOR SUITE	37'	27'	1,025	60	60	50	-	-	-	-
ASTOR SUITE I	27'	19'	507	30	30	25	21	21	24	20
ASTOR SUITE II	27'	19'	518	30	30	25	21	21	24	20
ROCKEFELLER SUITE	39'	22'	930	85	60	75	42	27	30	32
MORGAN SUITE	42'	21'	875	75	60	72	42	30	42	34
VANDERBILT SUITE	38'	16'	875	-	-	-	-	-	-	20





VANDERBILT BOARDROOM



GRAND BALLROOM



THE GALLERY



INTERCONTINENTAL®

NEW YORK BARCLAY

DO YOU LIVE AN INTERCONTINENTAL LIFE?

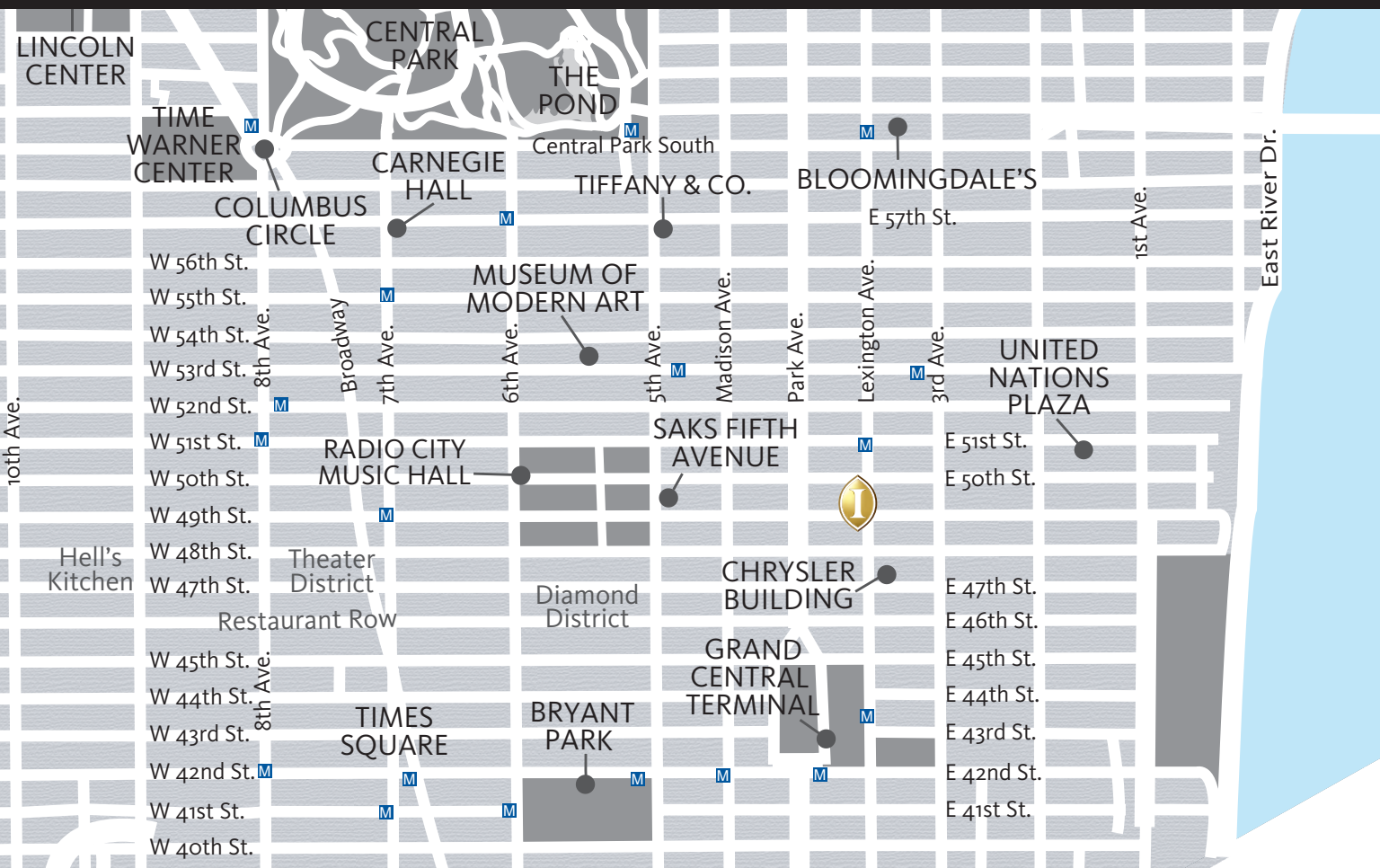

111 EAST 48TH STREET NEW YORK, NY 10017

PHONE: +1 212 755 5900 EMAIL: BARCLAY@IHG.COM

INTERCONTINENTALNYBARCLAY.COM