



## LUXURY STYLE & SOPHISTICATION IN THE HEART OF BANGKOK

Embark on your journey to discover the authentic  
experiences of dynamic Bangkok.

---

### IN THE VERY HEART OF BANGKOK

InterContinental Bangkok is located in the central Ratchaprasong district of Bangkok, surrounded by commercial, retail and cultural destinations, as well as international companies, embassies, and leading hospitals. Major shopping destinations such as CentralWorld, Siam Paragon, Central Embassy and Gaysorn Village, the latter directly connected to the hotel, are within walking distance, while access to other parts of Bangkok is fast and efficient by Skytrain, the nearest station being literally steps from the hotel's entrance.



The Erawan Shrine, one of Bangkok's most famous cultural attractions, is directly opposite the hotel. As for the city's many other cultural and historical points of interest, our knowledgeable Concierge team will be delighted to connect guests with what makes Bangkok so alluring.

Guests staying at InterContinental Bangkok will appreciate its spacious rooms and suites, superb array of dining experiences, outstanding facilities and impeccable personalised service.



INTERCONTINENTAL.  
BANGKOK



# ACCOMMODATION

InterContinental Bangkok comprises 381 luxury guestrooms, including Club InterContinental rooms and a range of suites. Starting from the 17<sup>th</sup> floor of President Tower, each room benefits from thrilling views of Bangkok's skyline and features superior amenities for full comfort and convenience.

- Spacious guestrooms starting from 45 sqm.
  - Universal electric outlets
  - Wi-Fi and broadband high-speed internet access
  - Ergonomic work space
- Minibar with Nespresso machine
  - 24 hours in-room dining
  - Double-glazed windows
  - Luxurious Byredo amenities

Room Type	Size   sqm.	Number of Rooms
Classic Room	45	151
Classic Room High Floor	45	118
Premium Club Lounge Access	45	73
Junior Suite	67	33
Premier Suite	70	1
Executive Suite	90	1
Ambassador Suite	99	2
Diplomatic Suite	150	1
Royal Suite	250	1
Two Bedroom Suite	112	33



## BANGKOK'S FRESHEST HOTEL EXPERIENCE

Fresh design and innovative  
dining adventures await.



## DINING

With a host of culinary options available, InterContinental Bangkok offers the finest of cuisines within the stylish and sophisticated surrounds of the hotel.

SoCal serves up Californian freshness in an upscale but casual atmosphere, attracting guests seeking an elevated and lively dining experience. Fireplace Grill and Bar is Bangkok's original steakhouse, delivering perfectly cooked succulent prime cuts and European classic for over 50 years.

Summer Palace presents the best of Cantonese cuisine, with a thrilling show kitchen where our chefs craft handmade dim sum and specialty dishes like roast duck and suckling pig. All day dining buffet restaurant, Espresso, is a hub of energy, serving international delights for breakfast, lunch and dinner, as well as a selection of a la carte meals.

Balcony Lounge and Humidor is an elegant meeting point for hotel guests and a place to enjoying light meals, sweet delights in addition to fine coffees and specialty teas in an elegant atmosphere, serving afternoon tea daily. For a quieter option, Butter café and bakery offers freshly prepared savory snacks, pastries, and sweets for eat-in or takeaway.



### SOCAL

Serving up Californian freshness in an upscale but casual atmosphere that is street-side and sunny. Attracting guests seeking an elevated and lively dining experience, with quality seasonal produce that is sustainable.

Total capacity: 101 seats

### FIREPLACE GRILL AND BAR

Serving quality classic European dishes since 1966. Savour perfectly grilled steaks and seafood, as well as finely crafted desserts. A live kitchen and table service adds dynamism to any dining occasion. You're sure to be impressed with our extensive menu of quality wines and Champagne.

Total capacity: 64 seats with 2 private rooms

### SUMMER PALACE

Discover truly authentic Cantonese cuisine and witness your meal being skillfully crafted by our talented chefs in the live kitchen. Don't miss out on our specialties of dim sum, roast duck and suckling pig.

Total capacity: 220 seats with 10 private rooms

### ESPRESSO

Open for breakfast, lunch and dinner 7 days per week. All-day dining of International cuisines from Asia, Europe and the Middle East.

Total capacity: 204 seats

### BALCONY LOUNGE AND HUMIDOR

Delivering a sophisticated ambiance in which to casually enjoy light dining options, cool refreshments and creative afternoon tea. In the evening, quality aperitifs and cocktails are served. At Humidor, connoisseurs will appreciate the wide range of whiskies and cigars from around the world.

Total capacity: 76 seats

### BUTTER

A sophisticated but relaxed delicatessen offering teas and coffees, as well as finely crafted patisseries, cakes and sweets. The ideal place for purchasing delicious gifts that are sure to be enjoyed.

Total capacity: 45 seats



## HOTEL FACILITIES

### OASIS

Our rooftop pool delivering a tranquil environment with stunning views of the Bangkok skyline.

Open daily from 07:00 to 22:00 hours.

### INFINITY FITNESS

Get fit to inspiring views high above Bangkok. Our exercise and fitness facility provides advanced equipment along with personalised service. Group exercise classes are available, including yoga and pilates.

Open daily, with 24 hours gym access to hotel guests.

### SPA INTERCONTINENTAL

Set high above the city, SPA InterContinental gives on to sweeping panoramic views of the Bangkok skyline. Offering a comprehensive spa menu, with the latest facilities and equipment supported by a dedicated staff of highly trained professionals. A total of 9 treatment rooms including 3 couples rooms and traditional Thai massage room.

Open daily from 09:00 to 23:00 hours.

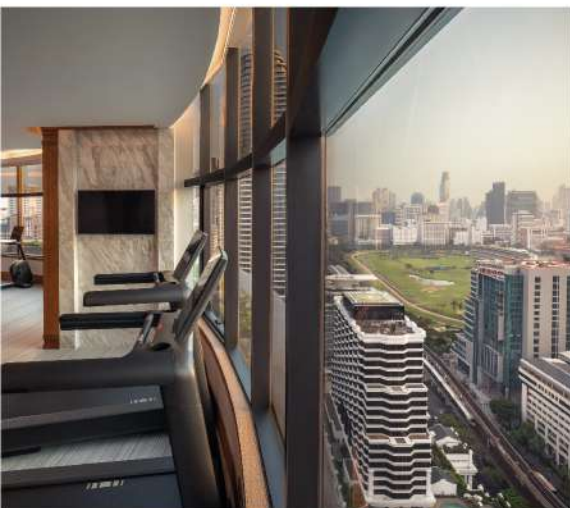

### CONCIERGE

Our expert Concierge team provide valuable local knowledge and personalised recommendations to enrich stays and broaden outlooks. Additional amenities include iPads for interactive maps, virtual tours, video recommendations and travel information.

### OTHER HOTEL FACILITIES AND AMENITIES

- Complimentary Wi-Fi
- 24 hours in-room dining
- Laundry and dry cleaning service
- Limousine service
- Doctor on-call 24 hours
- Direct connection to Gaysorn Village
- Complimentary parking for up to 800 cars for events or meetings

### LOCATION

- On Phloen Chit Road offering convenient access for business and leisure travellers.
- Directly adjacent to the BTS Chidlom Skytrain station.
- 30 km from Suvarnabhumi International Airport by car via expressway.
- 40 minutes from Suvarnabhumi International Airport via the Airport link – simply catch the express train from the airport to Phaya Thai station (city station) and connect to BTS Chidlom Skytrain station, which is directly adjacent to the hotel.
- 23 km from Don Muang International Airport by car via expressway.

### GENERAL INFORMATION

- Local currency: Thai Baht (THB)
- Time Zone: GMT +7
- Average temperature ranges: low 22°C - 27°C, high 32°C - 36°C



## MEETINGS & EVENTS

Banqueting, meeting and convention facilities at InterContinental Bangkok are among the city's most spacious and versatile. The hotel offers 19 function rooms, with its largest, an elegant Grand Ballroom, accommodating up to 1,000 guests cocktail style with our foyer area. The hotel's dedicated exhibition area encompasses an expansive hall with the capacity for up to 2,000 visitors and exhibitors.

On-site technical features include a stunning 4K LED screen; high-intensity LED lighting fixtures with advanced colour mixing technology; video streaming, conferencing and recording capabilities; satellite communications; mobile projection systems; and centrally controlled LCD display screens. Full secretarial services are available.

Our team of event professionals assist from enquiry stage to event completion. Custom designed menus are expertly curated and prepared by the Executive Chef and the culinary team.

## PLAN & DETAILS

### INTERCONTINENTAL CONVENTION CENTRE

Fourth Level



### INTERCONTINENTAL MEETING CENTRE

Ground Level

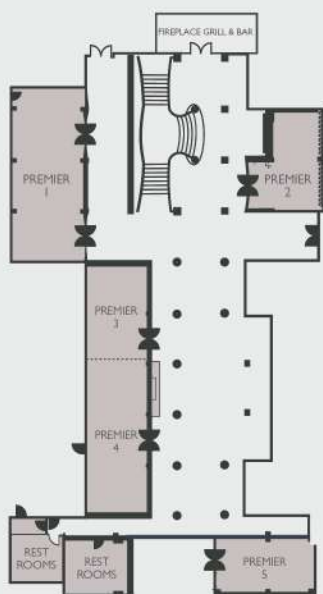

Lobby Level

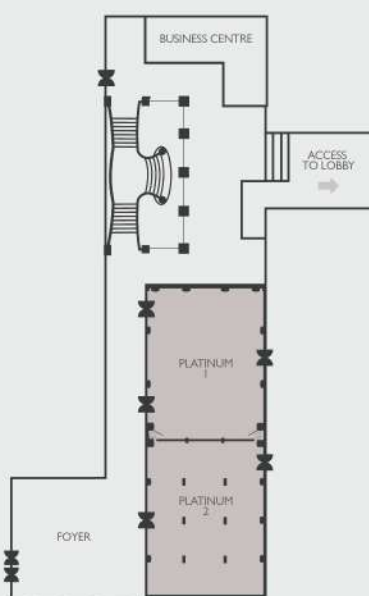

INTERCONTINENTAL CONVENTION CENTRE

Room Name	Cocktail Reception	Banquet Style	Theatre Style	Classroom Style	Cabaret	U Shape	Conference Hollow	Boardroom	Size (sqm.)	Height (m.)
Grand Ballroom	800	550	960	552	440	141	168	104	860	7.8
Grand Ballroom (S)	800	480	720	378	384	102	162	-	860	7.8
Ballroom 1	300	250	420	288	200	81	108	56	520	7.8
Ballroom 2	200	150	300	168	120	57	78	32	340	7.8
Ballroom	—	—	—	—	—	—	—	—	300	3.8
Foyer	—	—	—	—	—	—	—	22	84	3.8
Boardroom	—	—	—	—	—	—	—	22	84	3.8
President 1	50	50	84	48	40	30	36	26	108	3.8
President 2	50	50	84	48	40	30	36	26	108	3.8
President 1-2	80	100	154	96	80	48	60	38	216	3.8
President 3	20	30	30	24	24	20	22	20	63	3.8
President 4	25	40	30	36	32	24	24	20	72	3.8
Pinnacle 1	50	50	84	48	40	27	36	26	99	3.8
Pinnacle 2	50	50	84	48	40	27	36	26	99	3.8
Pinnacle 3	50	50	84	48	40	27	36	26	99	3.8
Pinnacle 4	50	50	84	48	40	27	36	26	99	3.8
Pinnacle 5	50	50	84	48	40	27	36	26	99	3.8
Pinnacle 6	50	50	84	48	40	27	36	26	99	3.8
Pinnacle 1-2, 2-3, 4-5, 5-6	80	100	154	96	80	51	54	30	198	3.8
Pinnacle 1-3, 4-6	120	150	252	156	120	75	84	66	297	3.8
Pinnacle Foyer	—	—	—	—	—	—	—	—	600	3.8
Pinnacle Hall	1,000	550	—	—	—	—	—	—	1,250	3.8

\*(S): Sideway

INTERCONTINENTAL MEETING CENTRE

Room Name	Cocktail Reception	Banquet Style	Theatre Style	Classroom Style	Cabaret	U Shape	Conference Hollow	Boardroom	Size (sqm.)	Height (m.)
Platinum 1	100	90	160	120	72	39	48	36	216	2.7
Platinum 2	50	80	72	36	64	28	32	24	216	2.7
Platinum 1-2	150	180	240	234	144	-	-	60	432	2.7
Premier 1	—	50	72	42	40	28	44	30	65	2.3
Premier 2	—	10	-	-	-	-	10	8	30	2.3
Premier 3	—	20	40	18	16	16	22	12	41	2.3
Premier 4	—	40	64	36	32	22	26	24	57	2.3
Premier 3-4	—	60	104	60	48	45	42	42	98	2.3
Premier 5	—	20	30	18	16	15	18	16	30	2.3





InterContinental Bangkok  
 973 Phloen Chit Road, Lumpini, Pathum Wan,  
 Bangkok 10330, Thailand

InterContinental.bkkhb@ihg.com  
 T: +66 (0) 2 656 0444

