



ATHENAEUM  
INTERCONTINENTAL®  
ATHENS



## THE ART OF GENUINE HOSPITALITY

Located in the heart of the city, the Athenaeum InterContinental Athens exudes an unparalleled sense of true hospitality. The hotel's staff embraces each guest with its characteristic expertise and warmth, while our elegant rooms, unrivaled dining options and exemplary event services all combine to create a city hotel that provides an all-round, authentic hospitality experience.



## ARTISTIC GRANDEUR

Featuring over 350 original works of contemporary Greek art in our public areas, function rooms and guest rooms, the Athenaeum InterContinental Athens undoubtedly provides a unique cultural experience to its guests. Since its inception, the hotel has been committed to the support and acquisition of works by Greek artists; the hotel has a unique collection that contains a variety of pieces by established artists including the Blue Man and the Red Bourgeois by G. Lappas and the Electromagnetic Sphere by Takis.



## TIMELESS & MODERN

The hotel's 563 guest rooms, including 60 suites, perfectly capture the essence of unpretentious luxury, exuding an aura of grace and warmth. Showcasing the highest standards of quality, our rooms and suites are outfitted with modern amenities to provide convenience and comfort. Stylishly decorated with specially commissioned works of modern art, all of our accommodation options promise to make even the shortest stay, a memorable hospitality experience.

## EXCLUSIVE CLUB INTERCONTINENTAL BENEFITS

Club InterContinental is the epitome of refined hospitality, combining the privileges of an exclusive club with the services and facilities of a first class business hotel. With 61 rooms and 18 suites, Club InterContinental provides an added touch of elevated, personalized service and superior accommodation, affording its guests with a sophisticated and intimate retreat.

## TASTEFUL EXTRAVAGANCE



### PREMIÈRE

Boasting breath-taking Acropolis and Lycabettus views, alongside unique premium quality flavors, and the finest selection of international wines, the hotel's award winning rooftop Première Restaurant & Lounge Bar is the ultimate choice for our discerning guests.



### CAFEZOE

A venue characterized by its high aesthetics and imaginative artistic style; enjoy a wide range of specialties including a lavish buffet breakfast. During the summer, savor a cocktail or light lunch from the snack bar on Cafezoe's terrace.



### ARTLOUNGE & ARTBISTROT

A cozy sanctuary at the heart of the hotel, Artlounge offers a delicious variety of tea, coffee and fresh pastries. Artbistrot combines Greek cuisine with contemporary international gastronomy and offers sumptuous à la carte flavors.



### TOBAR

A retro art bar with authentic decor, distinct music and innovative cocktails, Tobar is a place where guests can truly unwind.

## REVITALIZED WELL-BEING

Rejuvenate and replenish your mind, body and spirit with our premium services and facilities. The hotel features an outdoor pool that is a haven of tranquillity, a 24hr fitness center with state-of-the-art body sculpting equipment by Technogym, and I-Spa – a boutique wellness club that will surely enhance your overall well-being.

## MEETING & EVENT EXCELLENCE

3,500

Square Meters

350

Works of Art

35

Meeting Rooms



The Athenaeum InterContinental Athens is continuously recognized as Greece's leading hotel for business and leisure events; bringing superior professionalism to the organization of every business meeting, conference and banquet. With more than 3,500m<sup>2</sup> and 35 break-out rooms, including the Athenaeum Ballroom which hosts up to 1,500 people - the largest space available in Athens - and the Acropolis Terrace with 600m<sup>2</sup> of open-air space and mesmerizing views of the Acropolis, the hotel offers the largest and most flexible meeting and banqueting facilities in Greece.

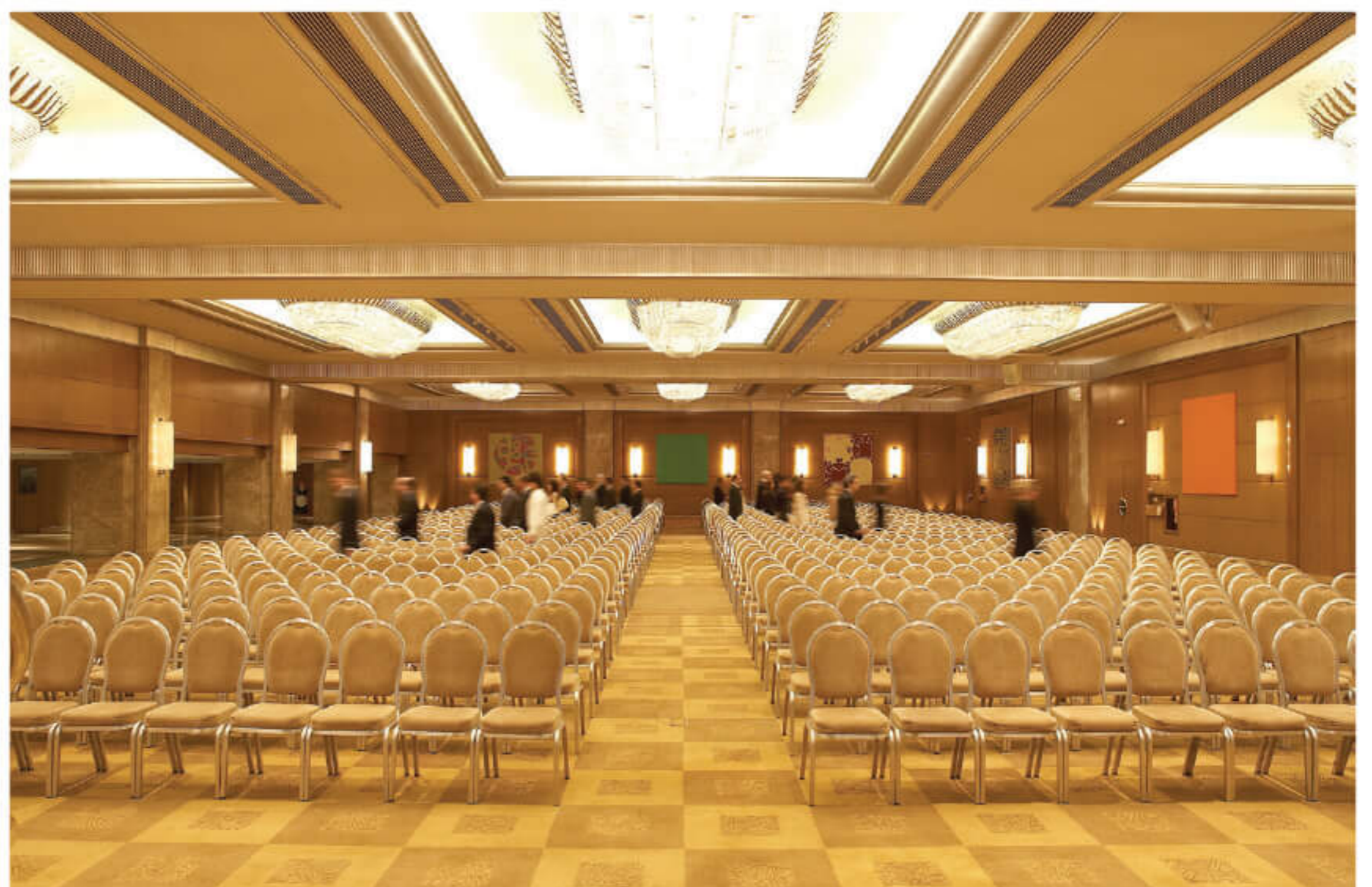

# GROUND LEVEL

## GROUND LEVEL



Meeting Room	Theatre Style	Classroom Style	Cabaret Style	Reception Style	Banquet Style	U-Shape Style	BoardRm Style	Area		Dimensions: Length x Width		Height	
								(sqm)	(sqft)	(m)	(ft)	(m)	(ft)
Acropolis Boardroom (6 <sup>th</sup> floor)	-	-	-	-	-	-	12	56	602	7.80 x 7.20	25.50 x 23.60	2.30	7.55
Acropolis Terrace (6 <sup>th</sup> floor)	-	-	-	450	350	-	-	600	6,460	34.20 x 17.50	112.20 x 57.40	-	-
Aphrodite	-	-	-	700	570	-	-	731	7,868	52.00 x 15.00	170.60 x 49.20	3.20	10.50
Aphrodite I	100	60	56	100	80	36	36	105	1,130	7.40 x 15.00	24.27 x 49.21	3.20	10.50
Aphrodite II	215	114	112	260	240	60	54	298	3,208	22.40 x 12.90	73.50 x 42.32	3.20	10.50
Aphrodite III	100	63	56	100	80	36	36	109	1,173	7.40 x 15.00	24.27 x 49.21	3.20	10.50
Aphrodite V	100	63	56	100	80	36	36	109	1,173	7.00 x 15.00	22.96 x 49.21	3.20	10.50
Aphrodite I-II	250	132	133	350	320	81	78	404	4,349	29.00 x 12.90	95.14 x 42.32	3.20	10.50
Aphrodite III-IV	170	108	91	200	170	36	36	218	2,347	15.00 x 15.00	49.21 x 49.21	3.20	10.50
Aphrodite IV-V	170	108	91	200	170	36	36	218	2,347	14.50 x 15.00	47.57 x 49.21	3.20	10.50
Aphrodite III-IV-V	245	135	119	300	280	60	54	327	3,520	21.80 x 15.00	71.52 x 49.21	3.20	10.50
Athenaeum R & L	-	-	-	100	-	-	-	102	1,110	19.00 x 5.40	62.30 x 17.70	3.28	10.76
Athenaeum Boardroom	-	-	-	-	-	-	10	28	300	6.50 x 4.00	21.30 x 13.00	3.28	10.76
Athenaeum	127	90	84	150	108	60	54	146	1,570	22.00 x 6.60	72.20 x 21.60	3.28	10.76
Athenaeum I	32	18	14	40	27	15	12	48	520	7.40 x 6.60	24.30 x 21.60	3.28	10.76
Athenaeum II	40	24	21	45	36	18	18	52	560	8.00 x 6.60	26.20 x 21.60	3.28	10.76
Athenaeum III	30	18	14	35	27	15	12	44	470	6.60 x 6.60	21.60 x 21.60	3.28	10.76
Athenaeum I-II	90	57	56	80	72	36	36	101	1,090	15.50 x 6.60	50.80 x 21.60	3.28	10.76
Athenaeum II-III	90	57	56	80	72	36	36	97	1,040	14.60 x 6.60	47.90 x 21.60	3.28	10.76
Arcade Lounge	24	12	14	25	18	12	12	35	377	6.00 x 5.90	19.60 x 19.36	2.90	9.51
Arcade I	100	63	56	110	90	42	36	137	1,475	15.55 x 8.80	51.00 x 28.87	3.17	10.40
Arcade II	32	21	21	40	27	15	12	60	646	-	-	3.17	10.40
Arcade III	-	-	-	-	-	-	10	37	398	6.70 x 5.40	21.98 x 17.71	2.84	9.32
Arcade I-II	150	99	77	170	126	54	54	200	2,153	-	-	3.17	10.40
Cafezoe	-	-	-	-	170	-	-	480	5,166	-	-	-	-
Cafezoe Terrace	-	-	-	-	80	-	-	169	1,819	-	-	-	-

# LEVEL -1



Meeting Room	Theatre Style	Classroom Style	Cabaret Style	Reception Style	Banquet Style	U-Shape Style	BoardRm Style	Area		Dimensions: Length x Width		Height	
								(sqm)	(sqft)	(m)	(ft)	(m)	(ft)
Alpha	14	6	-	-	-	-	12	23	250	6.00 x 4.00	19.70 x 13.10	2.84	9.31
Beta	14	6	-	-	-	-	12	23	250	6.00 x 4.00	19.70 x 13.10	2.84	9.31
Alpha-Beta	33	18	14	30	27	15	12	46	500	6.00 x 8.00	19.70 x 26.20	2.84	9.31
Epsilon	14	6	-	-	-	-	12	22	240	6.00 x 3.80	19.70 x 12.50	2.84	9.31
Zeta	14	6	-	-	-	-	12	22	240	6.00 x 3.70	19.70 x 12.10	2.84	9.31
Epsilon-Zeta	33	18	14	30	27	15	12	44	480	6.00 x 7.50	19.70 x 24.60	2.84	9.31
Kappa	-	-	-	-	-	-	13	41	440	6.90 x 6.50	22.60 x 21.30	2.84	9.31
Omikron-Ypsilon Foyer	-	-	-	50	-	-	-	68	730	9.00 x 8.00	29.50 x 26.20	3.20	10.49
Omikron	-	-	-	200	180	-	-	216	2,325	16.00 x 13.90	52.50 x 45.60	3.19	10.46
Omikron I	100	63	42	100	80	36	30	105	1,130	15.50 x 7.00	50.90 x 23.00	3.19	10.46
Omikron II	120	69	56	100	90	42	36	111	1,200	16.00 x 6.90	52.50 x 22.60	3.19	10.46
Ypsilon (sideways)	220	123	112	-	-	-	-	361	3,890	25.60 x 13.90	84.00 x 45.60	3.01	9.87
Ypsilon (double projection)	300	180	154	350	300	-	-	361	3,890	25.60 x 13.90	84.00 x 45.60	3.01	9.87
Ypsilon I	40	18	28	40	40	15	12	51	550	7.50 x 6.90	24.60 x 22.60	3.01	9.87
Ypsilon II	46	18	28	40	40	15	12	56	600	7.50 x 7.40	24.60 x 24.20	3.01	9.87
Ypsilon III	65	42	35	60	60	24	20	75	810	11.20 x 6.70	36.70 x 22.00	3.01	9.87
Ypsilon IV	70	42	42	60	60	24	20	78	840	11.20 x 7.00	36.70 x 22.90	3.01	9.87
Ypsilon I-II	100	54	49	100	80	39	36	108	1,160	14.40 x 7.50	47.20 x 24.60	3.01	9.87
Ypsilon II-III	130	81	70	110	100	48	42	131	1,400	18.70 x 7.50	61.40 x 24.60	3.01	9.87
Ypsilon I-II-III	194	111	98	150	150	66	60	183	1,970	25.60 x 7.50	84.00 x 24.60	3.01	9.87
Ypsilon III-IV	100	54	49	120	120	33	30	155	1,680	11.20 x 13.90	36.70 x 45.60	3.01	9.87
Ypsilon IV-V	130	81	70	110	100	48	42	131	1,410	18.70 x 7.00	61.40 x 23.00	3.01	9.87
-1 Banquet Lobby	-	-	-	300	-	-	-	350	3,770	27.00 x 36.00	88.60 x 118.10	2.87	9.41

## LEVEL -2

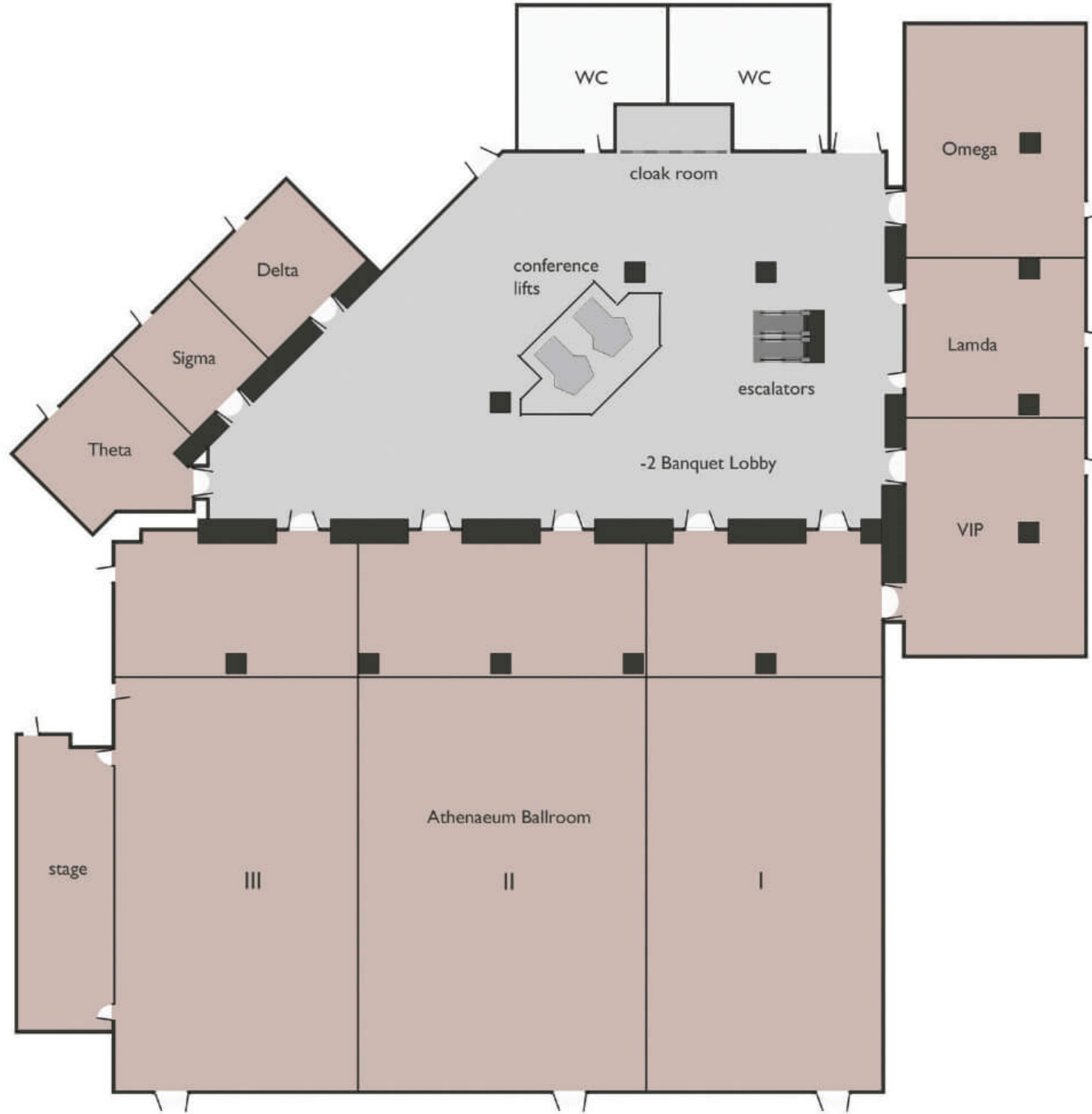

Meeting Room	Theatre Style	Classroom Style	Cabaret Style	Reception Style	Banquet Style	U-Shape Style	BoardRm Style	Area		Dimensions: Length x Width		Height	
								(sqm)	(sqft)	(m)	(ft)	(m)	(ft)
Ballroom	1,500	750	637	1,500	1,300	150	-	1,455	15,660	44.40 x 31.50	145.60 x 103.40	5.05	16.56
Ballroom I	400	222	168	350	280	75	54	434	4,670	31.50 x 13.80	103.40 x 45.30	5.05	16.56
Ballroom II	500	261	210	500	350	81	54	526	5,660	31.50 x 16.70	103.40 x 54.80	5.05	16.56
Ballroom III	400	222	168	350	280	75	54	495	5,330	31.50 x 13.80	103.40 x 45.30	5.05	16.56
Ballroom I-II	900	480	441	700	700	111	84	953	10,260	30.50 x 31.50	100.00 x 103.40	5.05	16.56
Ballroom II-III	900	480	441	700	700	111	84	1,021	10,990	30.60 x 31.50	100.40 x 103.40	5.05	16.56
VIP	100	51	42	100	110	30	24	137	1,470	13.00 x 10.50	42.70 x 34.50	2.29	7.50
Lamda	70	36	28	50	60	24	18	94	1,010	10.50 x 9.10	34.50 x 29.90	2.29	7.50
Omega	100	51	42	100	110	30	24	135	1,450	13.00 x 10.50	42.70 x 34.50	2.29	7.50
VIP-Lamda	170	102	84	150	170	60	54	229	2,460	22.00 x 10.50	72.20 x 34.50	2.29	7.50
Lamda-Omega	170	102	84	150	170	60	54	231	2,490	22.00 x 10.50	72.20 x 34.50	2.29	7.50
VIP-Lamda-Omega	250	171	140	300	300	-	-	366	3,940	35.40 x 10.50	116.10 x 34.50	2.29	7.50
Theta	50	27	28	50	40	18	12	62	670	8.10 x 6.30	26.60 x 20.70	2.51	8.23
Sigma	30	18	14	30	30	15	12	38	410	6.10 x 6.30	20.00 x 20.70	2.51	8.23
Delta	40	27	21	40	40	15	12	50	540	7.60 x 6.30	24.90 x 20.70	2.51	8.23
Theta-Sigma	100	54	56	80	80	36	30	101	1,090	14.40 x 6.30	47.20 x 20.70	2.51	8.23
Sigma-Delta	100	54	56	70	80	33	30	88	950	13.80 x 6.30	45.30 x 20.70	2.51	8.23
Theta-Sigma-Delta	150	90	84	120	120	57	54	152	1,640	22.00 x 6.30	72.20 x 20.70	2.51	8.23
-2 Banquet Lobby	-	-	-	500	-	-	-	463	4,980	39.50 x 21.00	129.60 x 68.90	2.67	8.75

Located in the Ancient Agora and built in 138 BC, the Stoa of Attalos was a meeting place, promenade and commercial center for the Athenians of the time.

Athenaeum  
InterContinental  
Athens

89-93 Syngrou Ave  
117 45 Athens, Greece

[athens@athensintercon.gr](mailto:athens@athensintercon.gr)  
T: +30 210 920 6000  
[intercontinental.com/athens](http://intercontinental.com/athens)

VIEW OUR VIRTUAL TOURS

