



**THE LODGE
AT BIG BEAR LAKE**

a Holiday Inn Resort

Let us help you create
a

Memorable Event

909-866-3121

deron@thelodgebbl.com

First Floor Ballroom(s)

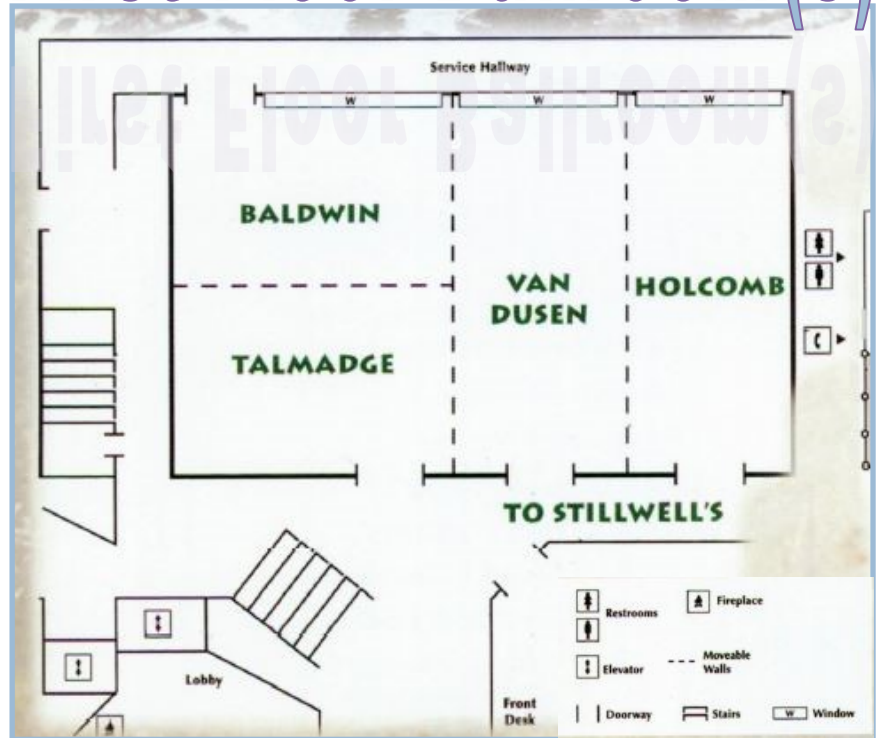

Second Floor Ballrooms and Meeting Rooms

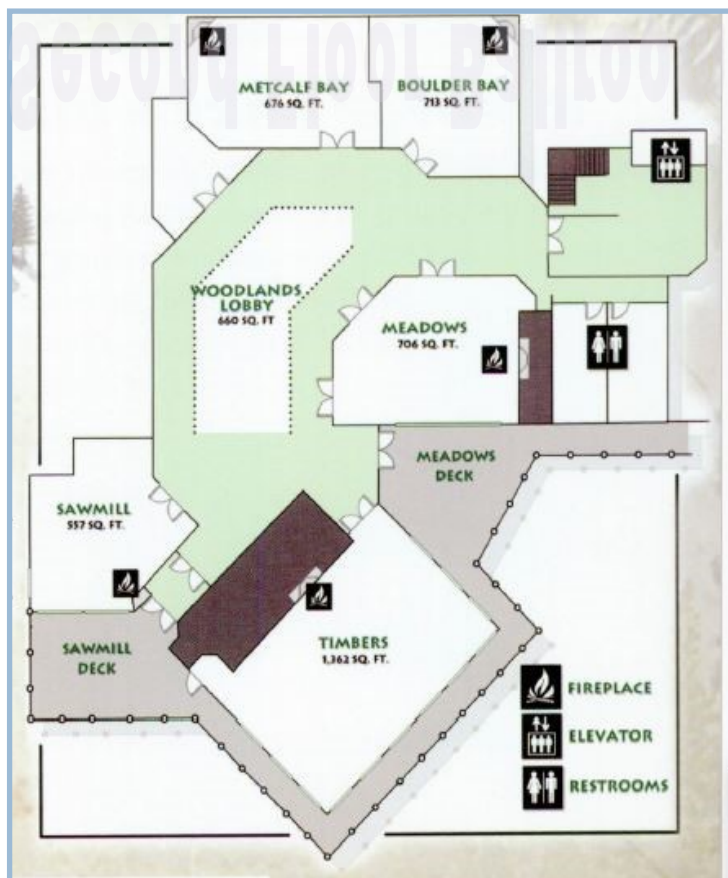

Our event space is designed to accommodate from 5 to 400! The Lodge at Big Bear Lake's Conference Center is the ideal Southern California venue for meetings, training sessions and any kind of social gathering. Our professional sales staff will blend year round recreational activities into your group's program and ensure your event is an all-around success!

Get in touch today at

909-866-3121

deron@thelodgebbl.com

Room	Dimensions	Square Footage	Banquet	Dinner/ Dance	Theatre	Class Room	Conf.	U-Shape
Timbers	44 x 30	1,362	90	80	100	50	30	36
Sawmill	25 x 22	557	30	n/a	35	20	16	20
Meadows	25 x 28	706	40	n/a	50	25	20	20
Boulder Bay	24 x 28	713	40	n/a	50	35	20	20
Metcalf Bay	22 X 30	676	40	n/a	50	35	20	20
NRCC	80 x 50	4000	250	220	360	170	n/a	n/a
Talmadge	38 x 23	900	50	n/a	60	30	20	25
Baldwin	38 x 23	900	50	n/a	60	30	20	25
Tal/Bal	38 x 50	1800	100	80	120	60	40	50
Van Dusen	24 x 50	1200	60	n/a	80	40	30	30
Holcomb	20 x 50	1000	60	n/a	80	40	30	30
Amphitheater	n/a	n/a	n/a	n/a	150	n/a	n/a	n/a

There are a variety of spaces to choose from here at The Lodge at Big Bear Lake— Contact us today to schedule a tour of the property and let us help you schedule your next event.

909-866-3121

deron@thelodgebbi.com

Our outdoor spaces include a large patio with a stage, and outdoor amphitheater and even sections of the parking lot can be turned into an exciting occasion!

Our restaurant and bar are available as well!

