

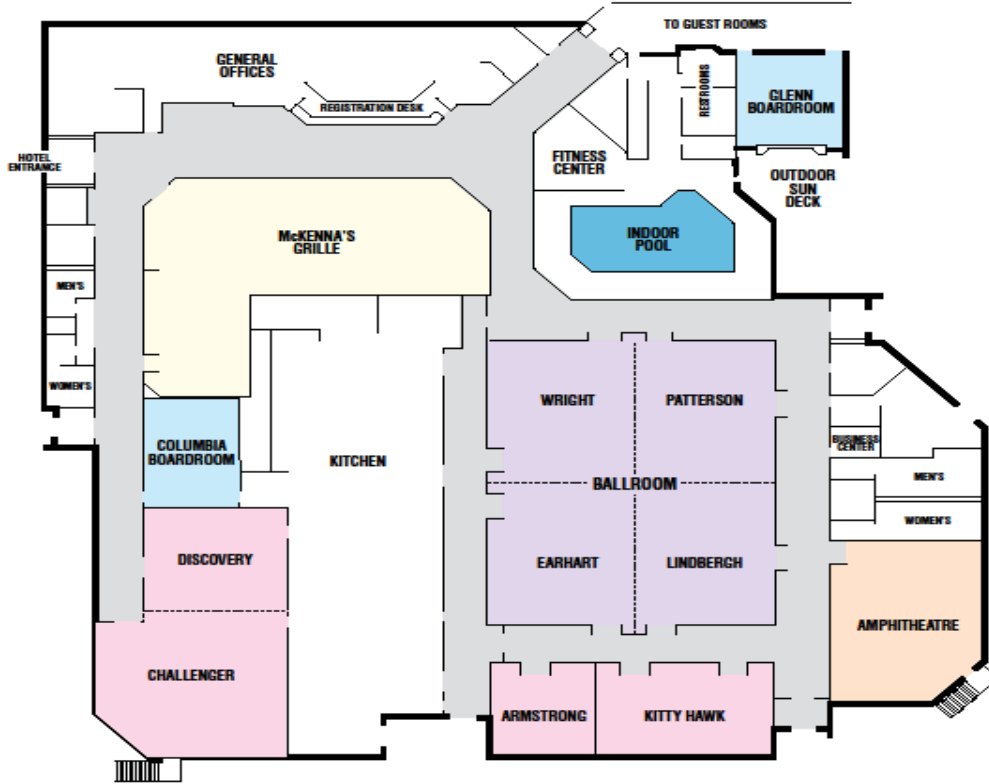

Holiday Inn

DAYTON FAIRBORN



Meeting Room	Sq. Ft	Dimensions	Theatre	Classroom	U Shape	Reception	Banquet
Ballroom	4408	58x76x10	400	250	NA	400	300
1/2 Ballroom	2204	58x38x10	180	120	NA	200	120
Wright	1102	29x38x10	80	50	30	100	60
Patterson	1102	29x38x10	80	50	30	100	60
Lindbergh	1102	29x38x10	80	50	30	100	60
Earhart	1102	29x38x10	80	50	30	100	60
Kitty Hawk	902	41x22x10	70	32	18	70	50
Armstrong	506	23x22x10	50	24	14	40	30
Glenn Boardroom	506	25x17x10	NA	NA	36	NA	NA
Challenger/Discovery	1711	59x29x10	150	96	36	150	100
Challenger	986	59x29x10	70	32	30	70	50
Discovery	696	34x24x10	50	30	20	50	40
*Amphitheatre	1518	44x35	NA	NA	NA	NA	NA

**98 stationary seats with retractable desk tops; Capacity for 20 additional seats*