

# SEQUIM

## Holiday Inn Express & Conference Center

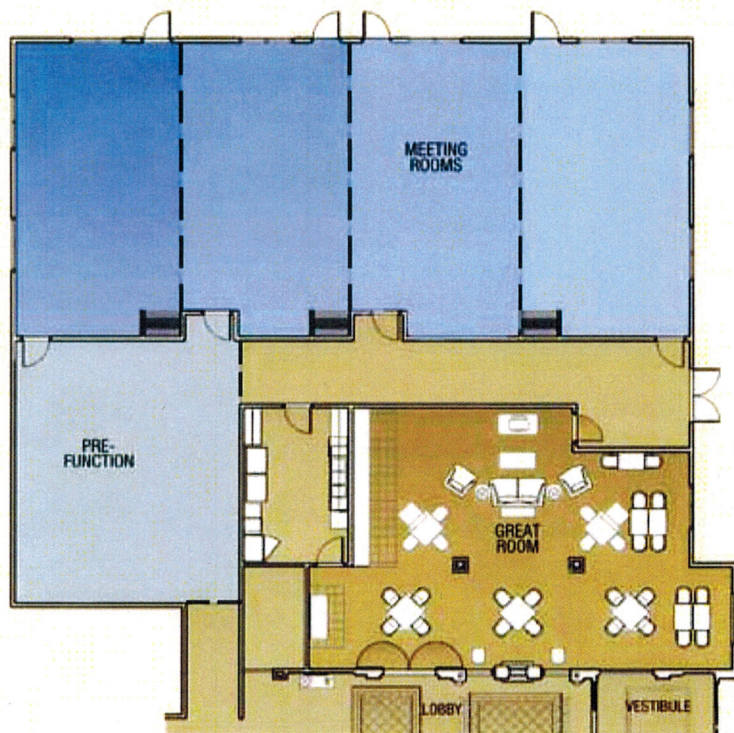

OUR CONFERENCE CENTER IS  
**POWERED BY THE SUN**

### MEETING SPACE CAPACITIES

Room Name	Size	Seating Style				
		Theatre	Banquet	Classroom	U-shape	Boardroom
Dungeness Suite	84 x 30	250	170	122	72	60
Salons (1-4)	21 x 30	50	32	30	16	18
Great Room	36 x 30		56			
Elwha Room 1	15 x 12	15	12	12	10	12
Elwha Room 2	15 x 12	15	12	12	10	12

\*Based on maximum capacity - numbers may vary based on table layout

### MEETING SPACE INFORMATION

- With over 3,000 total square feet of meeting space, let us make your event spectacular.
- We offer a variety of dining options to meet your needs.
- We provide a personal meeting coordinator to make your event run smoothly.
- Our unique Rooftop Garden is a great venue for a small private wedding ceremony, family celebration, or even a sales meeting. With 360-degree views of the Sequim Dungeness Valley, this idyllic area is a sought-after venue.

### MEETING GUARANTEE

- If items in your signed contract are not fulfilled satisfactorily you will be promptly compensated.

### SUITE CAPABILITIES

- We have two dedicated two-room Suites, designed so that you can enjoy a small meeting or cocktail party for up to 6 people in the comfort of your own Suite.

1441 EAST WASHINGTON STREET, SEQUIM, WA 98382

