



# CHECK US OUT AND CHECK IN TO THE ZÜRICH EXPERIENCE.

The Crowne Plaza Zürich offers a wide variety of modern and individual meeting venues. Enjoy the dedicated service and the attention to detail.

[WWW.CPZURICH.CH](http://WWW.CPZURICH.CH)

# Conference rooms and meeting facilities

- 11 meeting rooms, all air-conditioned and with natural daylight, ADSL lines + wireless internet
- Over 1300 m² of space (including pre-function rooms)
- Ballroom dimensions: 29.75 x 16.8 m with 5.2 m ceiling height. 475 m² area – can be partitioned

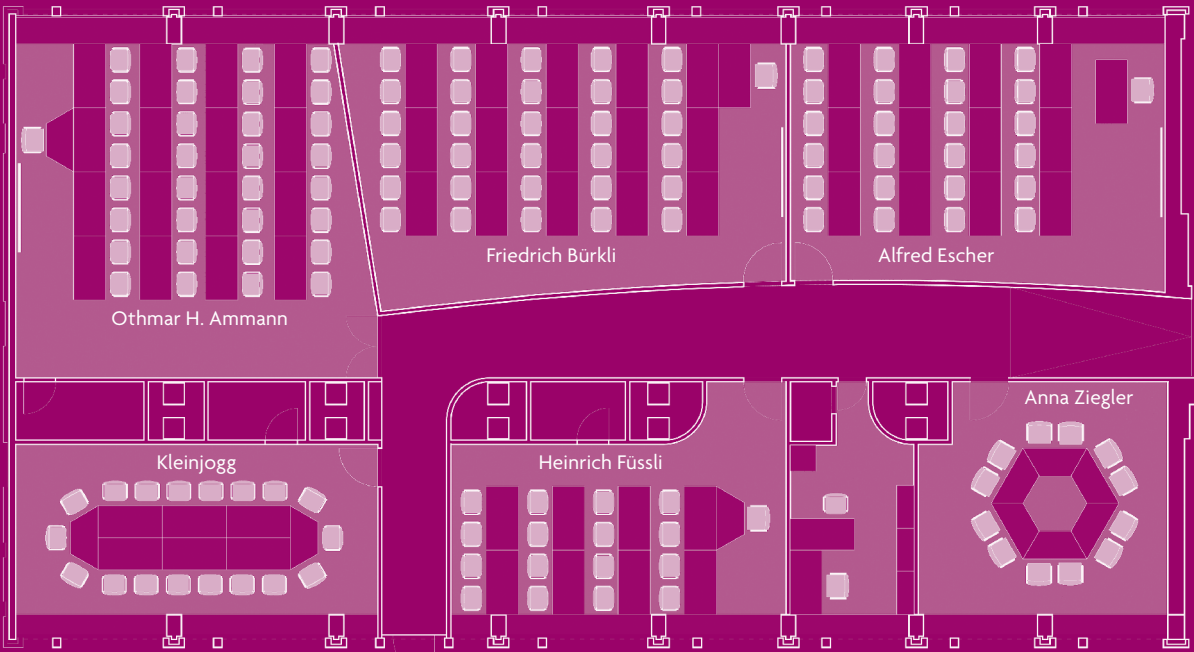

Room Name	Theatre	Classroom	U-shape	Banquet	Cabaret
Salon Bleu	60	40	30	96	–
Patio Süd / West	130	58	40	128	54
Patio Süd	70	24	20	44	–
Patio West	80	30	26	56	40

Room Name	Dimensions	Height	Door H/W	Daylight	Location
Salon Bleu	11.4 x 11.25	3.0	2x2	✓	G
Patio Süd / West	18.8 x 7.1	2.5	2x1	✓	M
Patio Süd	9.5 x 7.0	2.5	2x1	✓	M
Patio West	11.2 x 7.1	2.5	2x1	✓	M

Room Name	Theatre	Classroom	U-shape	Boardroom
Ammann	40	30	18	24
Bürkli	40	28	22	24
Escher	30	25	18	20
Kleinjogg	25	18	–	15
Füssli	25	17	–	15
Ziegler	–	–	–	12

Room Name	Dimensions	Height	Door H/W	Daylight	Location
Ammann	8.0 x 7.8	2.5	2x1	✓	G
Bürkli	10.2 x 6.3	2.5	2x1	✓	G
Escher	8.9 x 5.8	2.5	2x1	✓	G
Kleinjogg	8.5 x 4.0	2.5	2x1	✓	G
Füssli	8.0 x 4.0	2.5	2x1	✓	G
Ziegler	5.8 x 5.5	2.5	2x1	✓	G

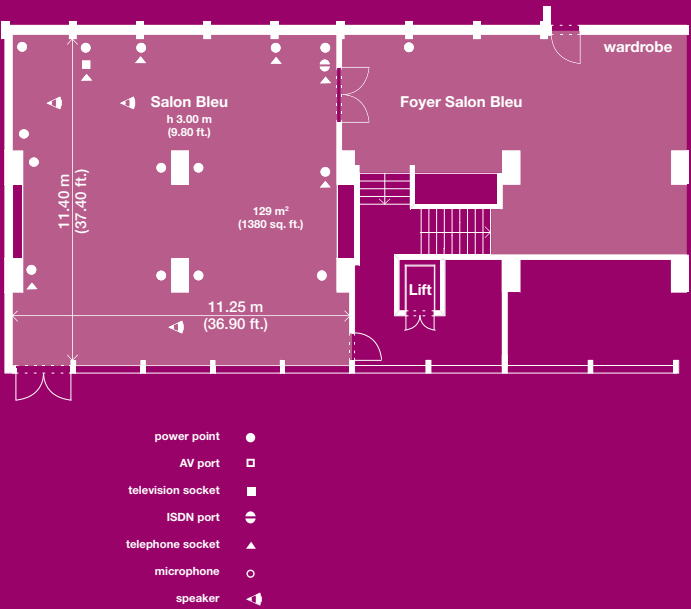
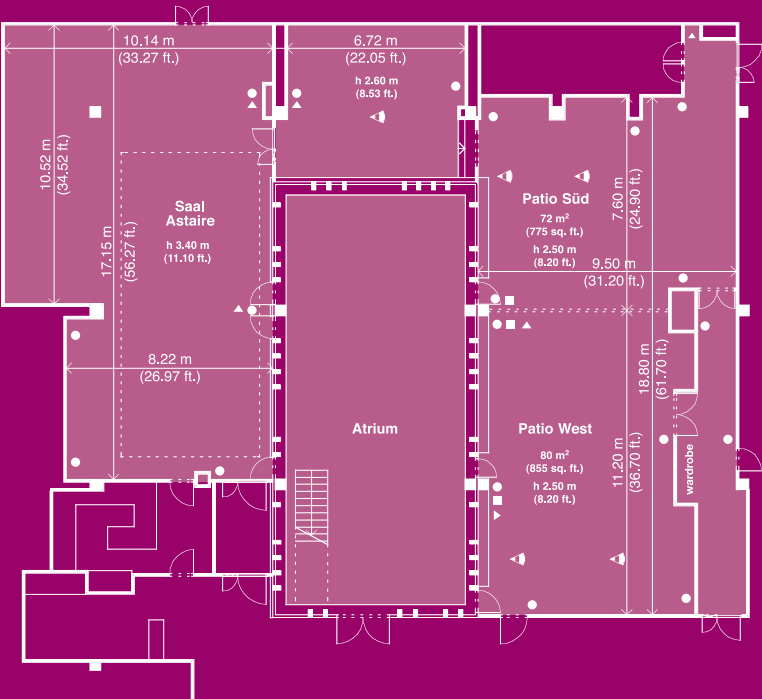



## Services and equipment

- Printer / fax, screen, digital projector, microphone, flip chart, lectern, LCD projector, ADSL lines + wireless internet
- Video and telephone conferencing, audio visual equipment, satellite link, power points, stage lights, stage
- Independent temperature control (heating and air-conditioning)
- Support services available including on-site audio visual specialist, courier service, photographers, florist, interpreter services and entertainment recommendations
- Magnetic walls in 6 of the meeting rooms

## Dining

- Relais des Arts – fine dining restaurant, featuring Swiss and international gourmet cuisine open for lunch and dinner, seats 80
- Restaurant LetziLeu – for informal dining, serving a selection of fresh and local seasonal dishes, buffet & breakfast open daily, seats 120
- Hotel Bar – open daily
- Garden restaurant – open during the summer season featuring international and Swiss gourmet cuisine

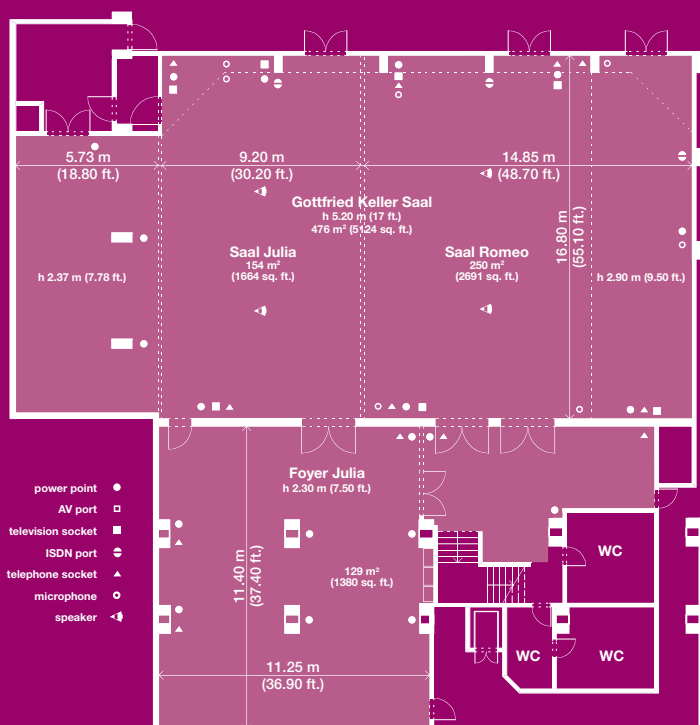

Room Name	Theatre	Classroom	U-shape	Banquet	Cabaret
Gottfried Keller	480	340	60	420	150
Saal Romeo	280	160	40	200	72
Saal Julia	150	100	40	120	54

Room Name	Dimensions	Height	Door H/W	Daylight	Location
Gottfried Keller	29.7 x 16.8	5.2	2x2	✓	M
Saal Romeo	18.8 x 15.0	5.2	2x2	✓	M
Saal Julia	16.8 x 9.1	5.2	2x2	✓	M

## Eat well. Work well.

For body, mind and soul

Fresh and balanced meals stimulate your mental fitness. Start your meeting feeling fit and full of energy.

Daily delegate rate from CHF 125.– per person & day

- Conference room with natural daylight
- Welcome break with coffee and tea
- One litre of mineral water for each participant in the conference room
- Morning break with homemade "Birchermüesli"
- Lunch with Mediterranean wraps, canapés and fresh leaf salad
- Dessert with regional and exotic fruits
- Afternoon break with coffee, tea, juices, various smoothies and energy bars
- Notepads and pens for all participants

This offer is subject to availability and is valid for events from 20 participants and is commissionable. Ask for our special room rate from CHF 239.– incl. breakfast. (Standard price CHF 329.–)





# GET INSPIRED.

## Location

- Located in the trendy Zurich West district close to the city centre and main train station
- Excellent transport facilities to the airport, main train station and international motorway networks
- Direct access to public transportation

## Accommodation

- 365 renovated guest rooms and suites
- Underground parking facilities – 550 spaces
- Equipment in the rooms:
  - Wireless internet
  - Flat screen TV and multi media panel
  - Air-conditioning, safe & minibar
  - Direct dial telephone
  - Coffee & tea making facilities

## Transportation

Distance from international airport: 10 km  
 Time by taxi: approximately 20 minutes  
 Time by train: approximately 20 minutes

Distance from main train station: 3.4 km  
 Time by taxi: approximately 10 minutes  
 Time by tram: approximately 12 minutes

## Recreational facilities

- Health club with heated indoor swimming pool, sauna, aerobics, yoga, jacuzzi, solarium, steam bath, dressing rooms/ shower facilities
- Fitness equipment – fully equipped with treadmill, rowing machine, cross trainer, cardio-bikes, body-shaping equipment with weights

