

### Ballroom

Section A, B, C & D combined







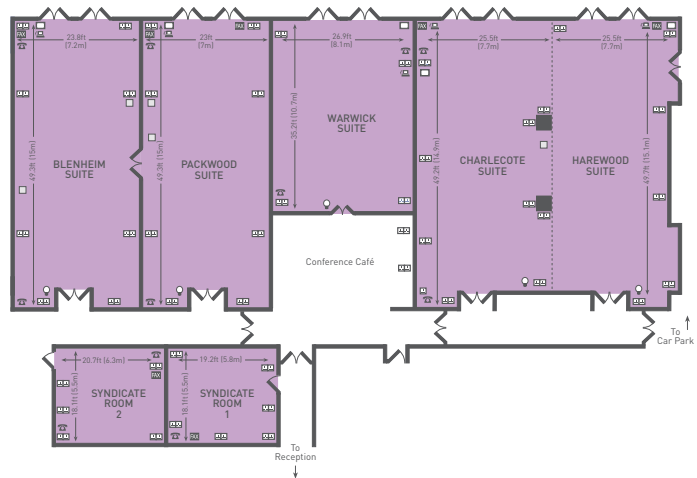

### Avon Meeting Rooms



### East Wing Meeting Rooms



### Key

-  Single 13 amp socket
-  Double 13 amp socket
-  Telephone point
-  Television point
-  3 Phase electricity supply
-  Controllable lighting
-  --- Moveable partition
-  ■ Column