

# CROWNE PLAZA®

BY IHG

San Diego Mission Valley

**The Crowne Plaza San Diego Hotel (SANCP)** recently completed a multimillion-dollar revitalization. Our new fresh product offers a unique, serene and tranquil atmosphere that can elevate a wonderful experience. With personalized attention from arrival to departure, you'll encounter the bliss of a flawless stay that will be handled with ease and enthusiasm by our attentive staff.

## Accommodation 419 "New" Guest Rooms

**Standard Rooms** (163) Spacious King and (244) Spacious 2 Queens with private patio or balcony

**Suites** (8) 2-Bedroom Suites with Golf Course View  
(1) 2-Bedroom Suites with Pool View and (3) 1-Bedroom Suites with Pool View

**The Islands Restaurant** Open daily for Breakfast and Dinner

**The Islands Lounge & Bar** Open daily from 5pm – 10pm

**The MarketPlace** Open daily – 24 hours

**24-hour Business Center** Self-service private room business center

**Health Club** - Open Daily – 24 hours

**Pool and Gardens** Outdoor pool and Jacuzzi are heated to perfection, open daily from 10am to 10pm

**Parking and Transportation** Parking is \$28.00 per day with in and out privileges.  
San Diego International Airport (SAN) 5 away miles and can be access via taxi or uber. Amtrak (OLT) is located 1.3 miles

**Event and Meetings Space** – Over 40,000 sq. ft. of extensive indoor and outdoor event space



Ana Maria Mendoza - Director of Sales and Marketing

[ammendoza@cp-sandiego.com](mailto:ammendoza@cp-sandiego.com)

# CROWNE PLAZA®

BY IHG

San Diego Mission Valley



One of the finest meeting and conference places in San Diego, our meeting space includes 30,000 square feet of flexible space with adaptable lighting options and state-of-the-art audio/visual systems. Our professional staff and Crowne Meetings Director will ensure that your function is a success.

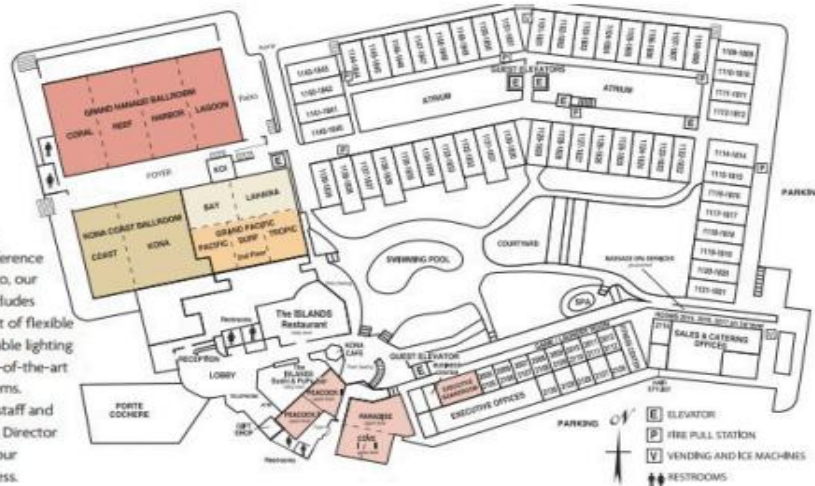

Room/Floor	Dimensions	Square Feet	Ceiling Height	Theater	Classroom 3 per	Classroom 2 per	Banquet Rts of 8	Banquets Rts of 10	Banquets Rts of 12	Conference	Native Sq.	U Shape	Table Top	Ex. Bath 8x10	Ex. Bath 10x10	Crescent
Grand Hanalei Ballroom	113 X 57	6441	16	637	384	249	432	470	564	88	120	100	81	48	34	324
Coral	28 X 57	1596	16	156	96	64	96	120	144	48	58	49	22	12	10	72
Reef	28 X 57	1596	16	156	96	64	96	120	144	48	58	49	22	12	10	72
Harbor	28 X 57	1596	16	156	96	64	96	120	144	48	58	49	22	12	10	72
Lagoon	28 X 57	1596	16	156	96	64	96	120	144	48	58	49	19	10	8	72
Coral Reef	56 X 57	3192	16	312	192	128	200	250	300	48	80	60	26	22	18	150
Harbor Lagoon	56 X 57	3192	16	312	192	128	200	250	300	48	80	60	26	22	18	150
Coral Reef Harbor	84 X 57	4788	16	468	288	196	304	370	444	70	100	80	30	28	24	228
Reef Harbor Lagoon	84 X 57	4788	16	468	288	196	304	370	444	70	100	80	27	25	21	228
Foyer	90 X 33	2970	16	-	-	-	-	-	-	-	-	-	-	-	-	-
Patio	72 X 24	1728	16	-	-	-	-	-	-	-	-	-	-	-	-	-
Ex Board Room	27 X 20	540	7	n/a	-	-	-	-	-	-	-	-	-	-	-	-
Poolside Garden	45 X 72	3240	n/a	450	-	-	-	-	-	-	-	-	-	-	-	-
East Garden Atrium	-	-	n/a	40	-	-	-	-	-	-	-	-	-	-	-	-
West Garden Atrium	-	-	n/a	80	-	-	-	-	-	-	-	-	-	-	-	-
Koi	6 X 20	120	-	-	-	-	-	-	-	-	-	-	-	-	-	-
Kona/Coast	77 X 53	3816	14	400	200	150	272	340	-	66	86	70	38	-	14	204
Kona	44 X 53	2332	14	200	120	84	152	190	-	48	62	46	28	-	-	114
Coast	28 X 53	1484	14	132	70	49	104	130	-	48	44	38	22	-	-	78
Lahaina/Bay	40 X 69.6	2780	12	300	160	120	200	250	-	62	78	67	37	-	6	150
Lahaina	40 X 41	1640	12	150	80	60	112	140	-	36	46	35	24	-	-	84
Bay	40 X 28.6	1140	12	104	60	42	88	110	-	36	36	30	21	-	-	66
Grand Pacific	30 X 71	2130	10	200	150	110	184	230	-	62	48	39	27	-	-	138
Tropic	22 X 34.6	759	10	55	36	27	48	60	-	26	28	22	12	-	-	36
Surf	24 X 30	726	10	55	36	27	56	70	-	22	28	22	12	-	-	42
Pacific	41 X 25	1025	10	100	60	42	80	100	-	32	40	32	16	-	-	60
Tropic Surf	45 X 31	1485	10	124	76	53	104	130	-	36	46	38	18	-	-	78
Pacific Surf	46 X 36	1656	10	165	95	66	136	170	-	36	46	38	21	-	-	102
Paradise	46 X 30	1380	10	72	50	30	64	80	-	38	36	30	17	-	-	48
Cove 1 & 2	42 X 24	1000	10	80	50	30	64	80	-	32	36	30	19	-	-	48
Cove 1	21.6 X 23	523	10	30	21	15	24	30	-	12	18	13	11	-	-	18
Cove 2	21 X 23.4	491	10	30	21	15	24	30	-	12	18	13	11	-	-	18
Peacock 1	43 X 32	1376	8	125	68	48	104	130	-	36	50	40	21	-	-	78
Peacock 2	51 X 32	1632	9	187/176*	98	70	112	140	-	46	56	50	26	-	-	84

Event and Meetings Space – Over 40,000 sq. ft. of extensive indoor and outdoor event space