

CROWNE PLAZA PLYMOUTH

Meetings & Events Fact Sheet

The hotel offers 6 fully equipped meeting spaces for up to 500 guests, with a dedicated Crowne Plaza Meetings Director on-site and a variety of food and drink options to suit your requirements.



 No. of bedrooms
211

 Gym

 Pool

 130 parking spaces on-site

 4 charging points

 Plymouth Station (1.4 miles)

 Exeter (40 miles)

 6 meeting rooms

 Outdoor dining capacity of 60

 Marco Pierre White

 Drakes Lounge & Bar

	Dimensions	Classroom	Theatre	Boardroom	Cabaret	Reception	Banqueting
GROUND	LxWxH (m)						
Mariner Suite	26.2x15.2x5.1	260 (200)	450 (350)	60	240 (200)	500	380
Walter Raleigh Suite	6.4x3.6x2.4	20	30	20	18	120	N/A
FIRST FLOOR							
Commonwealth Suite	21.5x8x2.4	60 N/A	120 N/A	35	72 N/A	130	90
Executive Boardroom	8.5x7.2x2.4	N/A	N/A	18	N/A	N/A	N/A
Syndicate Room A	3.5x3.6x2.4	N/A	N/A	6	N/A	N/A	N/A
Syndicate Room B	3.5x3.6x2.4	N/A	N/A	6	N/A	N/A	N/A
PENTHOUSE FLOOR							
Astor Suite	7x9.6x2.4	20	40	24	32	45	40



FLOOR PLAN

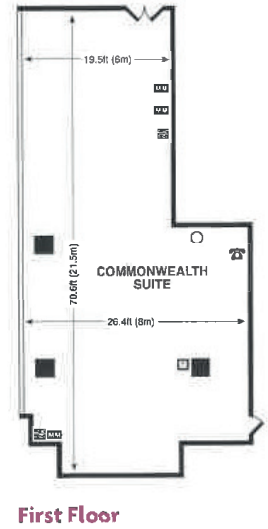
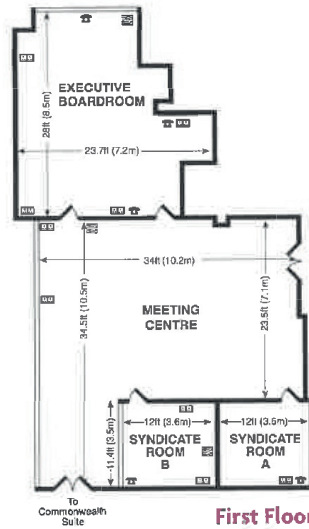
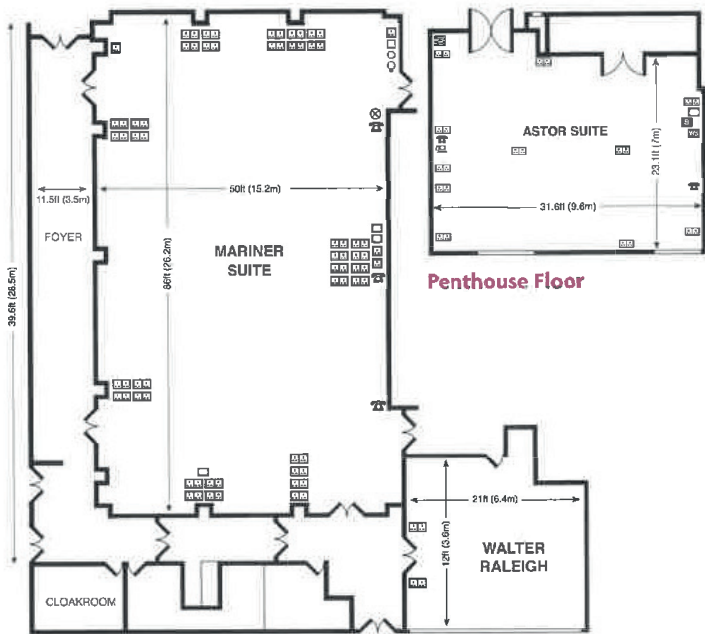

Key

- Double 13 amp socket
- Telephone point
- TV aerial
- ISDN socket
- Fax
- White-board
- Pillar
- Screen
- Public address speaker
- Dimmer
- Air-conditioning controls
- Light controls
- 3 Phase electricity supply