



CROWNE PLAZA®
MINNEAPOLIS WEST



MEETINGS & EVENTS



Conveniently located in Plymouth, our facilities are specifically designed, staffed, and equipped with all the amenities to delight discriminating business travelers. The newly completed renovations of all public spaces and guest rooms are awaiting you!

CONFERENCE AND EVENT ROOMS

- 35 Meeting Rooms
- A non-traditional ideation room to drive a meeting forward, change the direction of thinking, challenge perceptions, and inspire collaboration.
- Comfortable ergonomic seating and generous meeting table spaces
- Professional In-House Audio Visual and IT department to guide your meetings with ease
- 2 Restaurants – Creekside Café and Europa Dining Room
- 3 Social Event Rooms – Accommodating up to 400 People Each
- Dedicated Conference Dining Room
- Total of 38,000 Square Feet of Meeting and Event Space

- Complimentary Wireless Internet
- Built-in Projection Screens, LCD Projectors, Dry Erase Boards and Large Picture Windows
- All Inclusive Meeting Packages
- Outdoor Team Building and Dining Options
- Yard Games and Picnic Grounds

GUEST ROOMS

- 243 guest rooms which include 15 Executive King and Double Queen rooms as well as 5 two room Diplomat Suites. We also have a 1,400 square foot 2 bedroom presidential suite.
- All guest rooms have newly renovated contemporary furnishings with multiple outlets at the desk and bedside level.
- Complimentary High Speed Wired and Wireless Internet
- 42-inch Flat Panel LCD Televisions
- Scenic Views of Woodlands and Protected Wetlands
- Mini-Refrigerator and Refreshment Bars

PLYMOUTH CREEK ATHLETIC CLUB

- On-site Full-Service Athletic Club Totalling 21,000 Square Feet
- Complimentary Access for Hotel Guests
- The Spa on Plymouth Creek Offering Massage Services by Appointment
- Instructor-Led Fitness Classes
- Mineral Lap Pool, Whirlpool and Saunas
- 4 Racquetball Courts
- 2 Wallyball Courts
- Basketball Court
- 3 Sand Volleyball Courts

- 2 Tennis Courts
- Dedicated Weight Room
- Aerobic Studio
- Cardio/Vascular Terrace
- Locker Facilities
- Sundeck
- Bonfire Pit

AWARD WINNING CUISINE

Our savory cuisine is creatively inspired, freshly prepared by our talented chefs and served with flair. We offer conference attendees bountiful buffet breakfasts and lunches as well as convenient all day kiosks filled with fresh baked tantalizing pastries and treats.

MORE AMENITIES

Complimentary 24 hour business center, is refreshing and multi-functional. Three computer stations offering printing, copying, scanning, and fax capabilities. Two Concierge Desks staffed to assist all hotel guests and meeting attendees.



MEETING ROOMS & CAPACITIES

Room	Dimensions	Sq. Ft.	Height	Theater	Classroom 5' Tables	6' Tables	U-Shape	Double U-Shape	Hollow Square	Conf- erence	Clusters Of 6	Banquet	Reception
Regency	75'8" x 54'4"	4,110	18'	400	198	288	90	90	78	--	186	300	450
Kiosk	25' x 125'	3,125	Vaulted	Public area used as pre-function space									
Mezzanine	13' x 70'	910	Vaulted	Public area used as pre-function space									

CONFERENCE ROOMS

B	27' x 27'3"	763	12'	46	24	36	27	--	37	16	30	50	50
C	41'8" x 27'3"	1,135	12'	92	48	72	33	44	52	24	48	80	90
D or E	40'10" x 34'	1,388	12'	120	60	90	42	54	55	28	64	90	100
F or G	34'6" x 27'10"	960	12'	80	40	60	27	54	46	20	42	60	70
H or I	34' x 27'	918	12'	80	40	60	27	30	46	20	42	60	70

BOARDROOMS

Boardroom 1	26'10" x 26'8"	715	12'	46	24	30	27	--	24	20	24	50	50
Boardroom 2	26'10" x 26'8"	715	12'	46	24	30	27	--	24	20	24	50	50
Fireside Lounge	27' x 43'	1,161	Public area used as pre-function space								--	--	

STUDIO ROOMS

Studio 1, 4, 9	13' x 27'3"	354	9'	30	16	--	--	--	--	18	--	--	30
Studio 2	27' x 41'4"	1,114	9'	92	48	72	33	44	52	24	48	80	90
Studio 3	18 x 24'3"	436	9'	36	18	--	18	--	--	10	--	40	30
Studio 5	20' x 38'9"	775	9'	65	36	42	36	--	30	20	36	80	90
Studio 6, 7, 11, 12, 13, 14, 15	20' x 13'	260	9'	30	12	--	--	--	--	16	12	20	20
Studio 8, 10, 17, 18, 19	13' x 13'	169	9'	18	8	--	--	--	--	6	--	10	10
Studio 16	20' x 24'9"	733	9'	32	24	30	20	--	26	16	--	50	50

BANQUET ROOMS

Scandinavian Ballroom	111'8" x 33'10"	3,778	10'9"	400	200	250	--	--	--	--	186	300	450
Viking Lounge	55' x 36'	1,980	Public area used as pre-function space										
Oslo	33'10" x 27'8"	936	10'9"	80	40	60	27	30	40	20	42	80	90
Stockholm	33'10" x 27'8"	936	10'9"	80	40	60	27	30	40	20	42	80	90
Elsinore	33'10" x 27'8"	936	10'9"	80	40	60	27	30	40	20	42	80	90
Helsinki	33'10" x 27'8"	936	10'9"	80	40	60	27	30	40	20	42	80	90
Plymouth	30'4" x 27'9"	842	10'9"	75	18	36	27	--	20	18	24	60	70
Europa	107' x 34'	3,638	11'6"	Custom furniture/set. Dinner seating for 300 people									
Copenhagen	59'10" x 27'6"	1,645	11'6"	150	74	96	42	81	40	32	66	140	175
Sun Deck (Seasonal)	27' x 48'	1,296	Outdoors	Custom Patio Furniture/Seating for 36 people									



CROWNE PLAZA
MINNEAPOLIS WEST

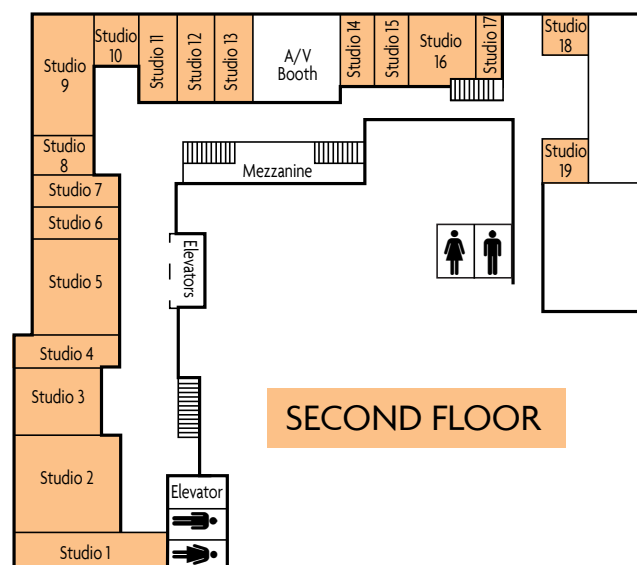
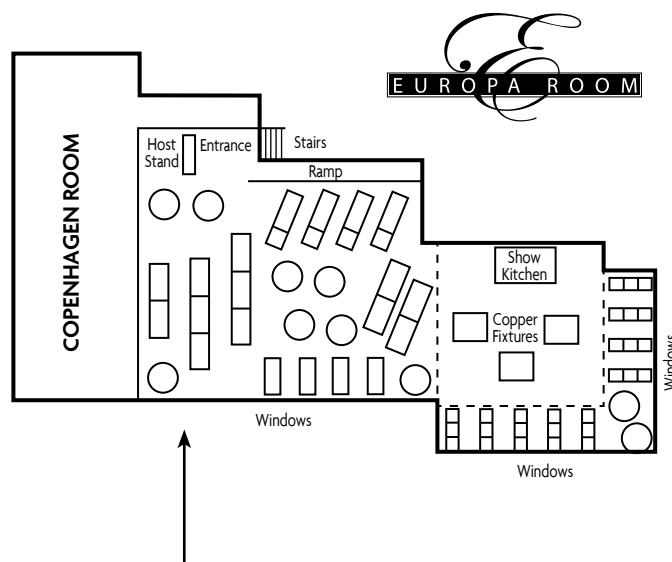
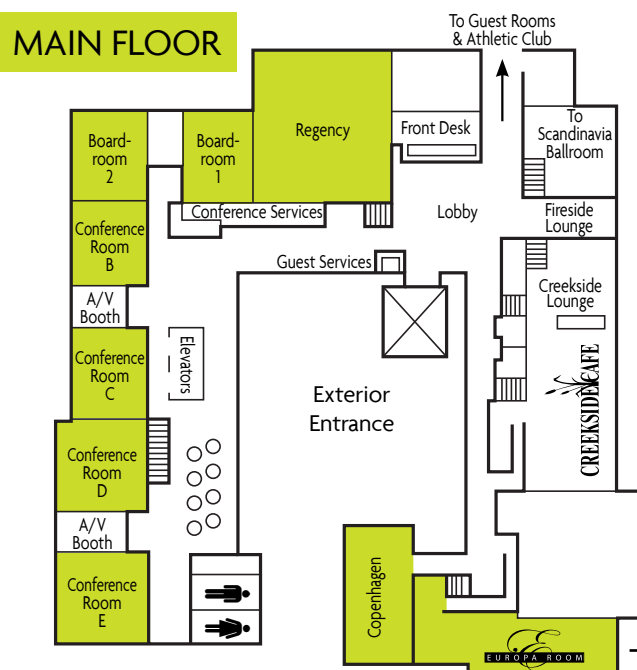
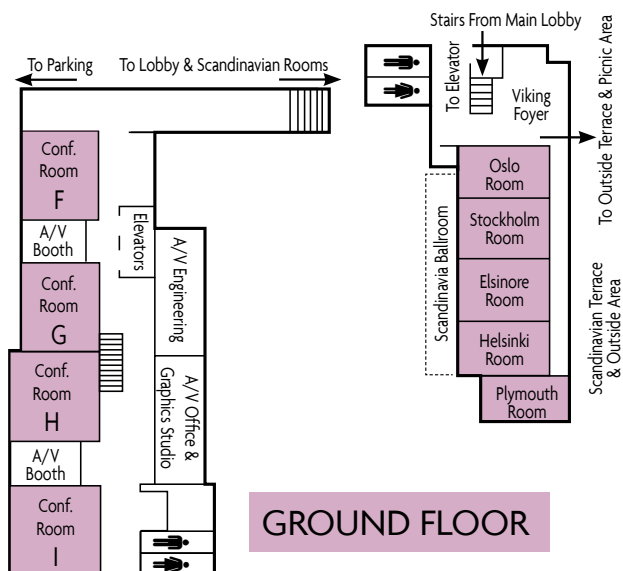

EUROPA CONFERENCE DINING



NEWLY RENOVATED
CONTEMPORARY GUEST ROOMS



CONTINUOUS REFRESHMENT
BREAKS THROUGHOUT THE DAY



EXQUISITE CUISINE



3 STORY ATHLETIC CLUB

OVERFLOW
PARKING

