

LENGTH: 19.9 ft    WIDTH: 12.5 ft    HEIGHT: 8.5 ft    TOTAL SQUARE FEET: 220.4 ft<sup>2</sup>    MAXIMUM CAPACITY: 8    POWER OUTLETS: 11

Fieldhouse Lane | Marlow, SL7 1GJ United Kingdom | +44 8704448940

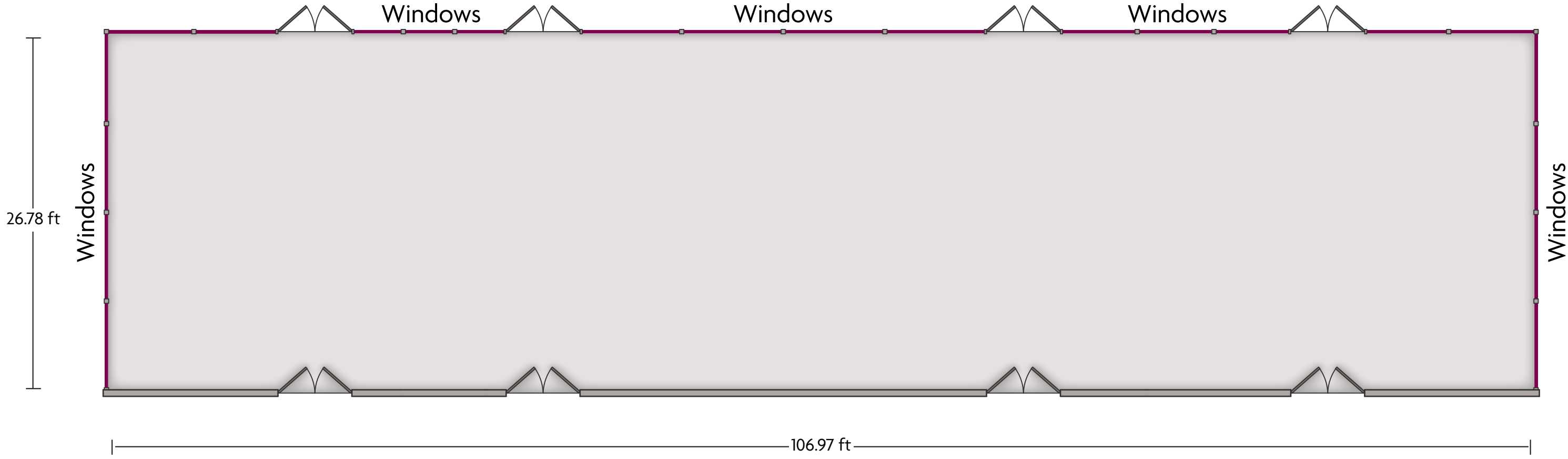

LENGTH: 107 ft    WIDTH: 26.8 ft    HEIGHT: 12 ft    TOTAL SQUARE FEET: 2,862.4 ft<sup>2</sup>    MAXIMUM CAPACITY: 200    POWER OUTLETS: 30

Fieldhouse Lane | Marlow, SL7 1GJ United Kingdom | +44 8704448940

\*Multiple layout options available for this space.

# Crowne Plaza® Marlow - Creative Meeting Space (Back)

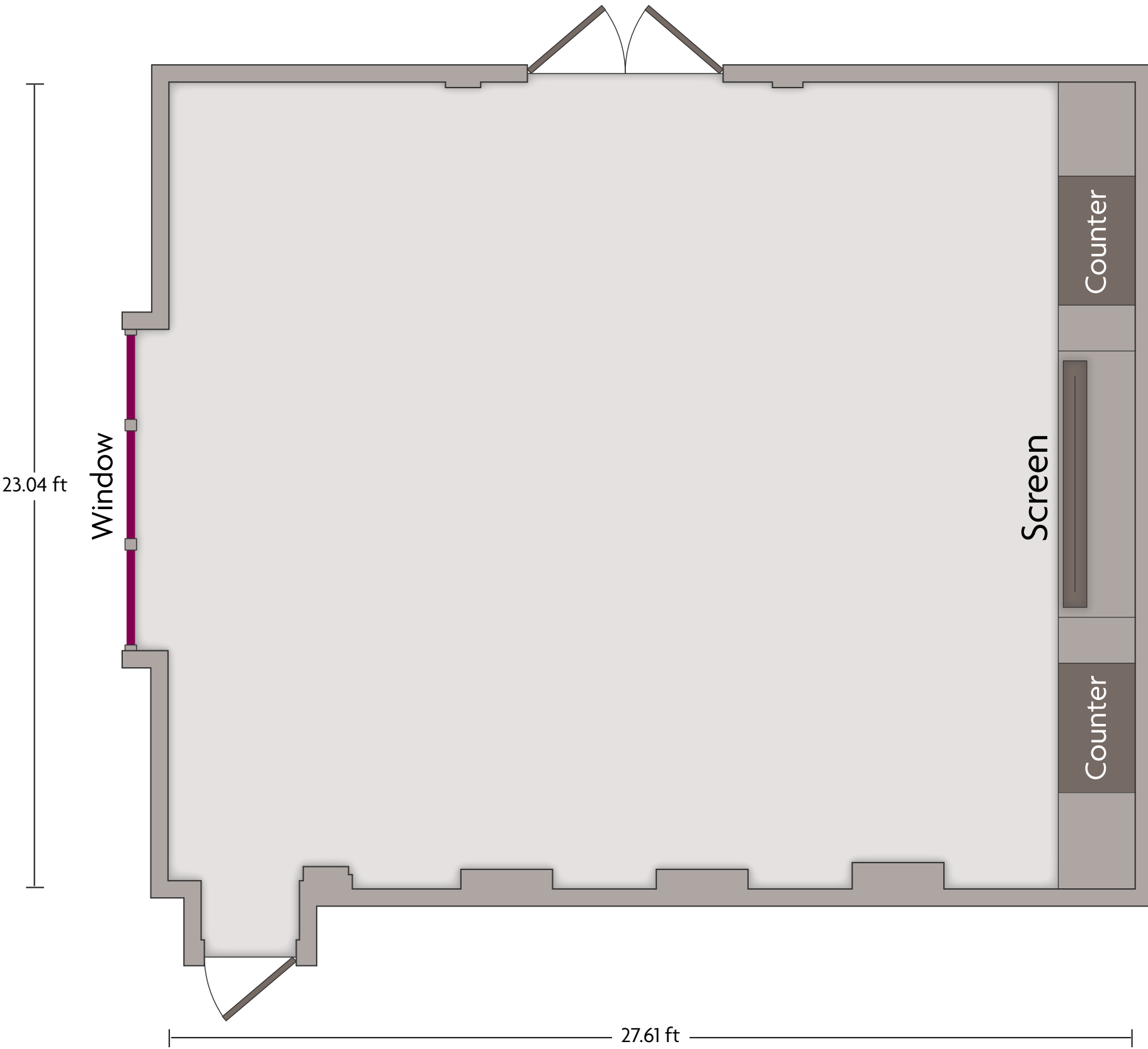

LENGTH: 27.6 ft    WIDTH: 23 ft    HEIGHT: 7.4 ft    TOTAL SQUARE FEET: 593.3 ft<sup>2</sup>    MAXIMUM CAPACITY: 20    POWER OUTLETS: 3

Fieldhouse Lane I Marlow, SL7 1GJ United Kingdom | +44 8704448940

\*Multiple layout options available for this space.

# Crowne Plaza® Marlow - Creative Meeting Space (Front)

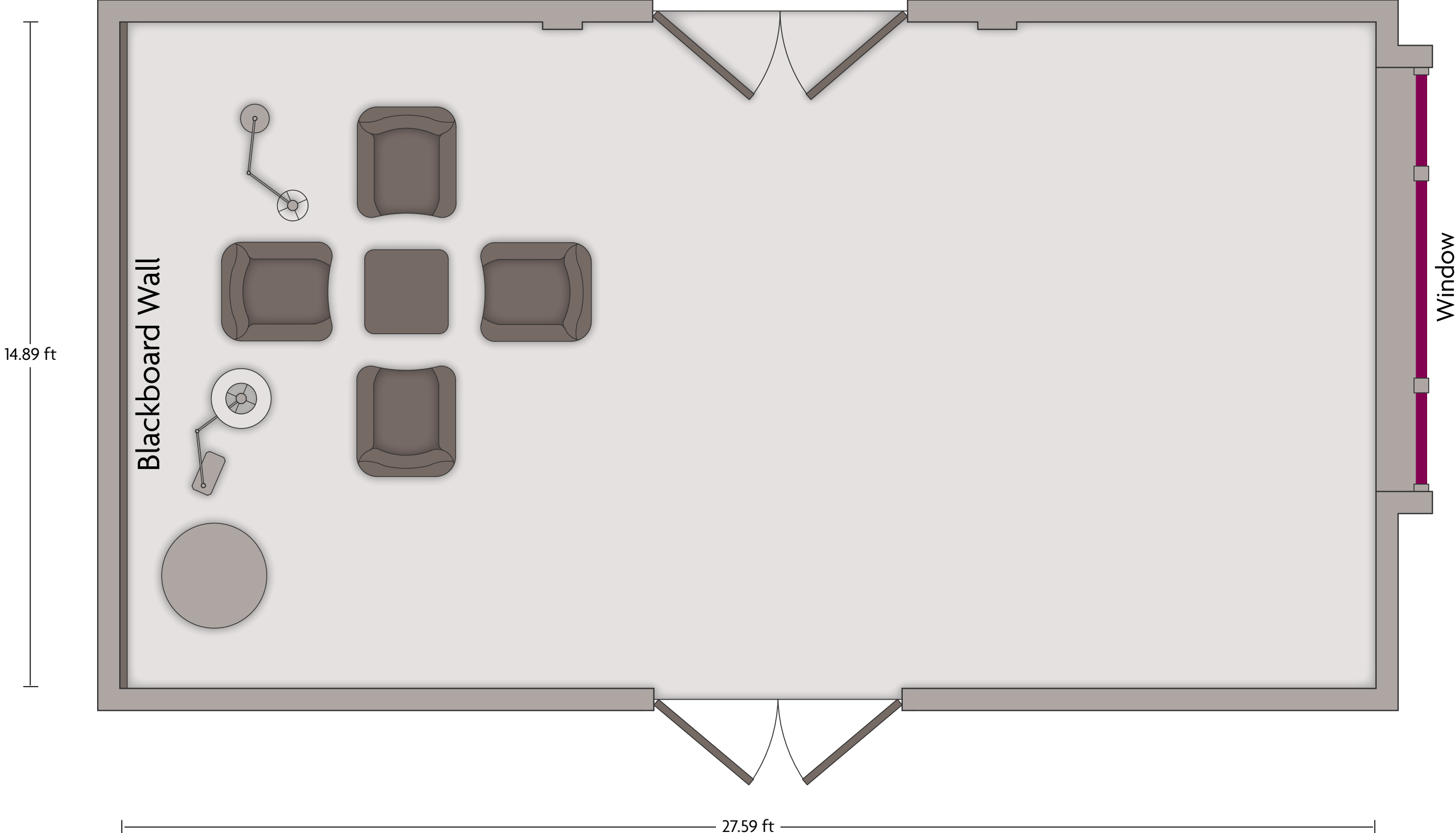

LENGTH: 27.6 ft    WIDTH: 14.9 ft    HEIGHT: 9.9 ft    TOTAL SQUARE FEET: 415.5 ft<sup>2</sup>    MAXIMUM CAPACITY: 14    POWER OUTLETS: 2

Fieldhouse Lane | Marlow, SL7 1GJ United Kingdom | +44 8704448940

\*Multiple layout options available for this space.

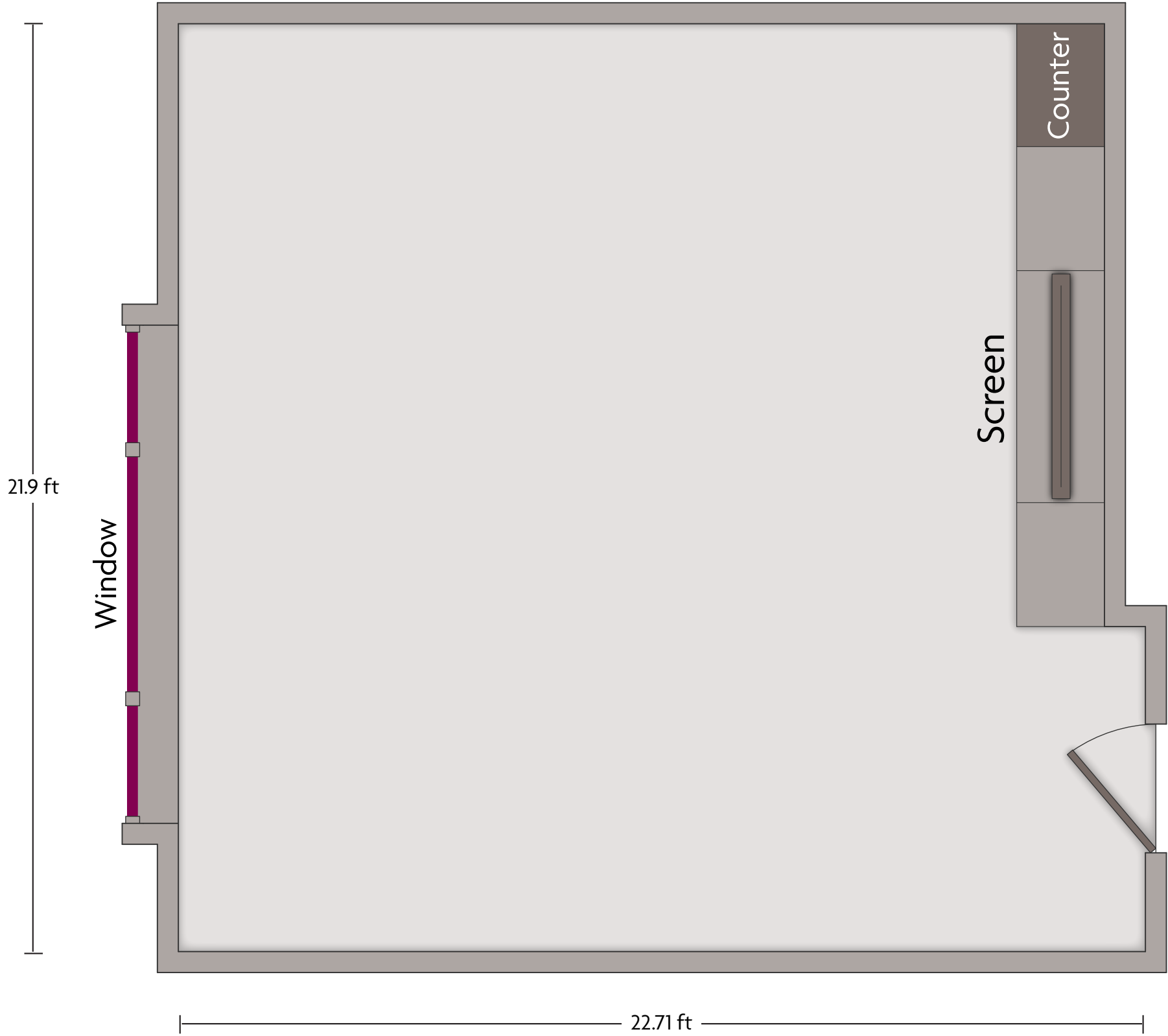

LENGTH: 22.7 ft    WIDTH: 21.9 ft    HEIGHT: 10 ft    TOTAL SQUARE FEET: 452.1 ft<sup>2</sup>    MAXIMUM CAPACITY: 50    POWER OUTLETS: 8

Fieldhouse Lane | Marlow, SL7 1GJ United Kingdom | +44 8704448940

\*Multiple layout options available for this space.

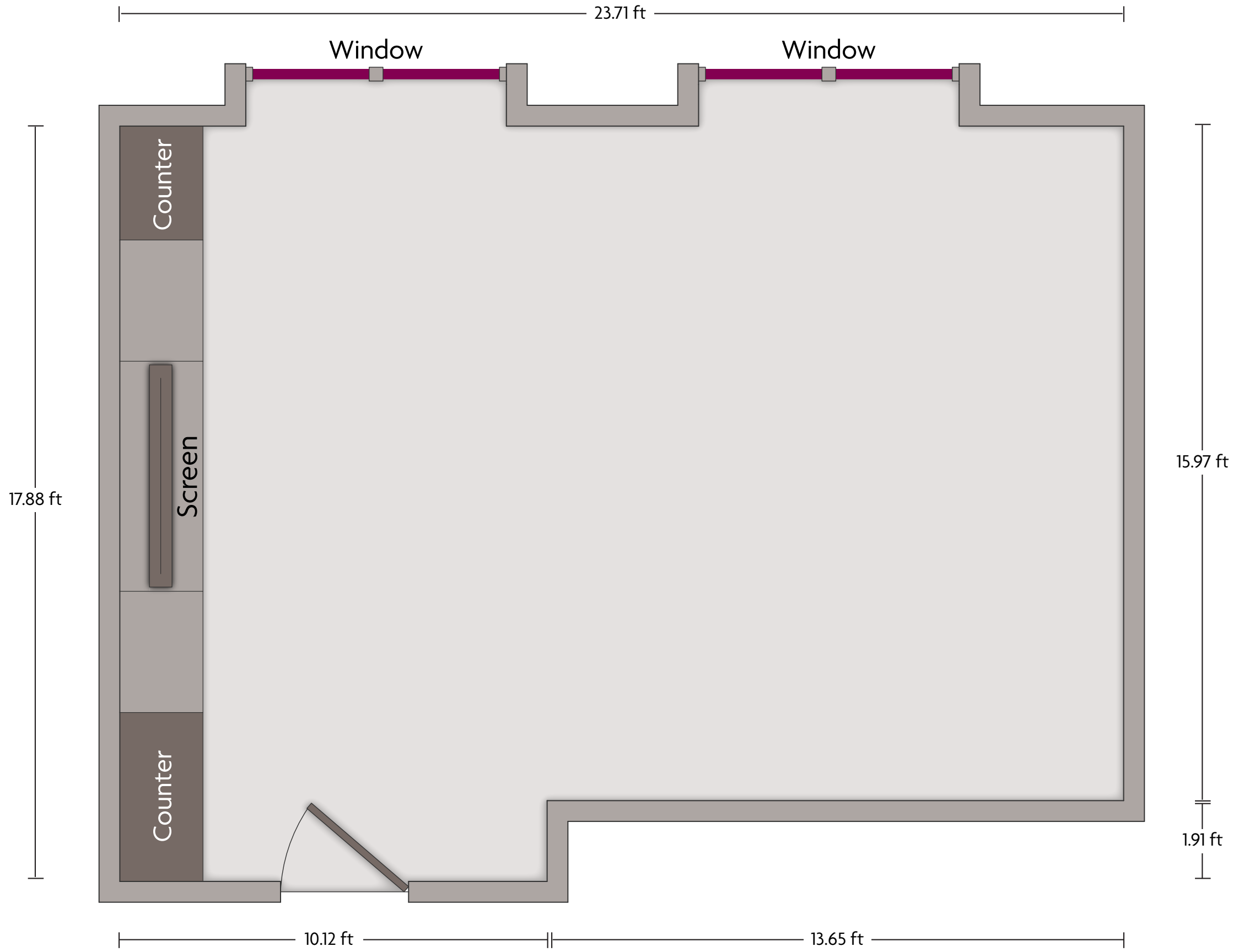

LENGTH: 23.8 ft    WIDTH: 16 ft    HEIGHT: 10 ft    TOTAL SQUARE FEET: 375.9 ft<sup>2</sup>    MAXIMUM CAPACITY: 30    POWER OUTLETS: 10

Fieldhouse Lane | Marlow, SL7 1GJ United Kingdom | +44 8704448940

\*Multiple layout options available for this space.

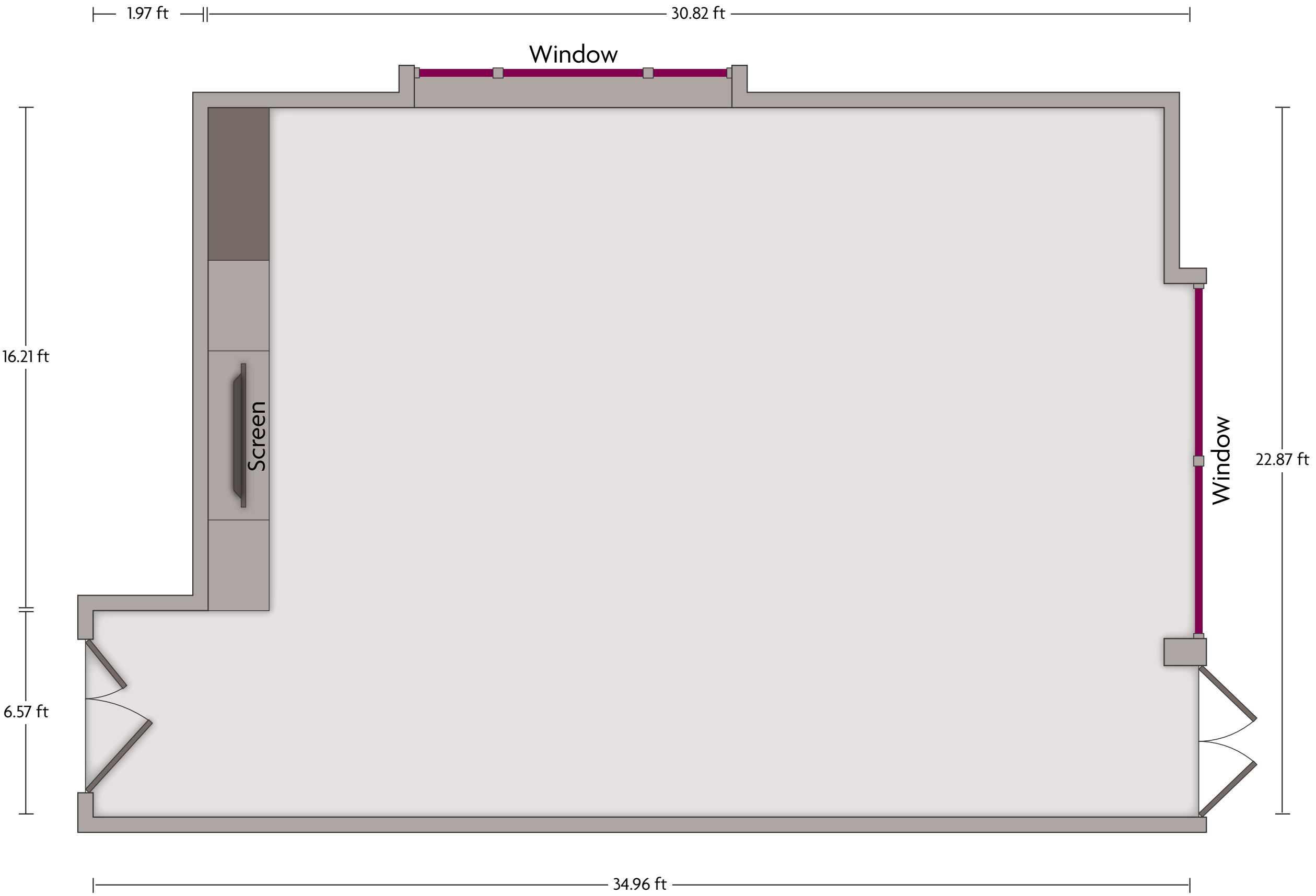

LENGTH: 28.9 ft    WIDTH: 22.9 ft    HEIGHT: 10.4 ft    TOTAL SQUARE FEET: 711.8 ft<sup>2</sup>    MAXIMUM CAPACITY: 60    POWER OUTLETS: 12

Fieldhouse Lane | Marlow, SL7 1GJ United Kingdom | +44 8704448940

\*Multiple layout options available for this space.

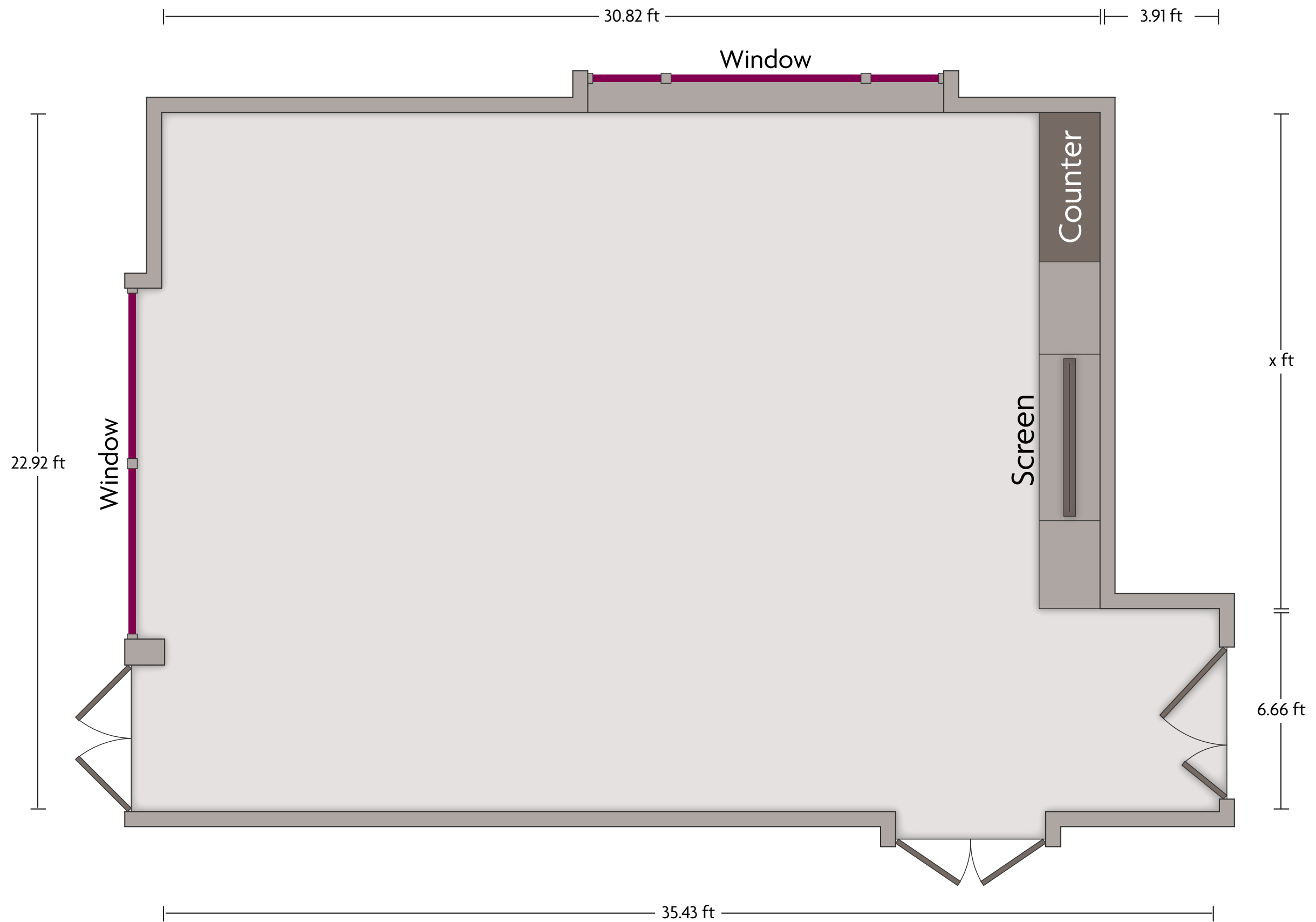

LENGTH: 30.8 ft    WIDTH: 22.9 ft    HEIGHT: 10.3 ft    TOTAL SQUARE FEET: 713.9 ft<sup>2</sup>    MAXIMUM CAPACITY: 60    POWER OUTLETS: 9

Fieldhouse Lane | Marlow, SL7 1GJ United Kingdom | +44 8704448940

\*Multiple layout options available for this space.



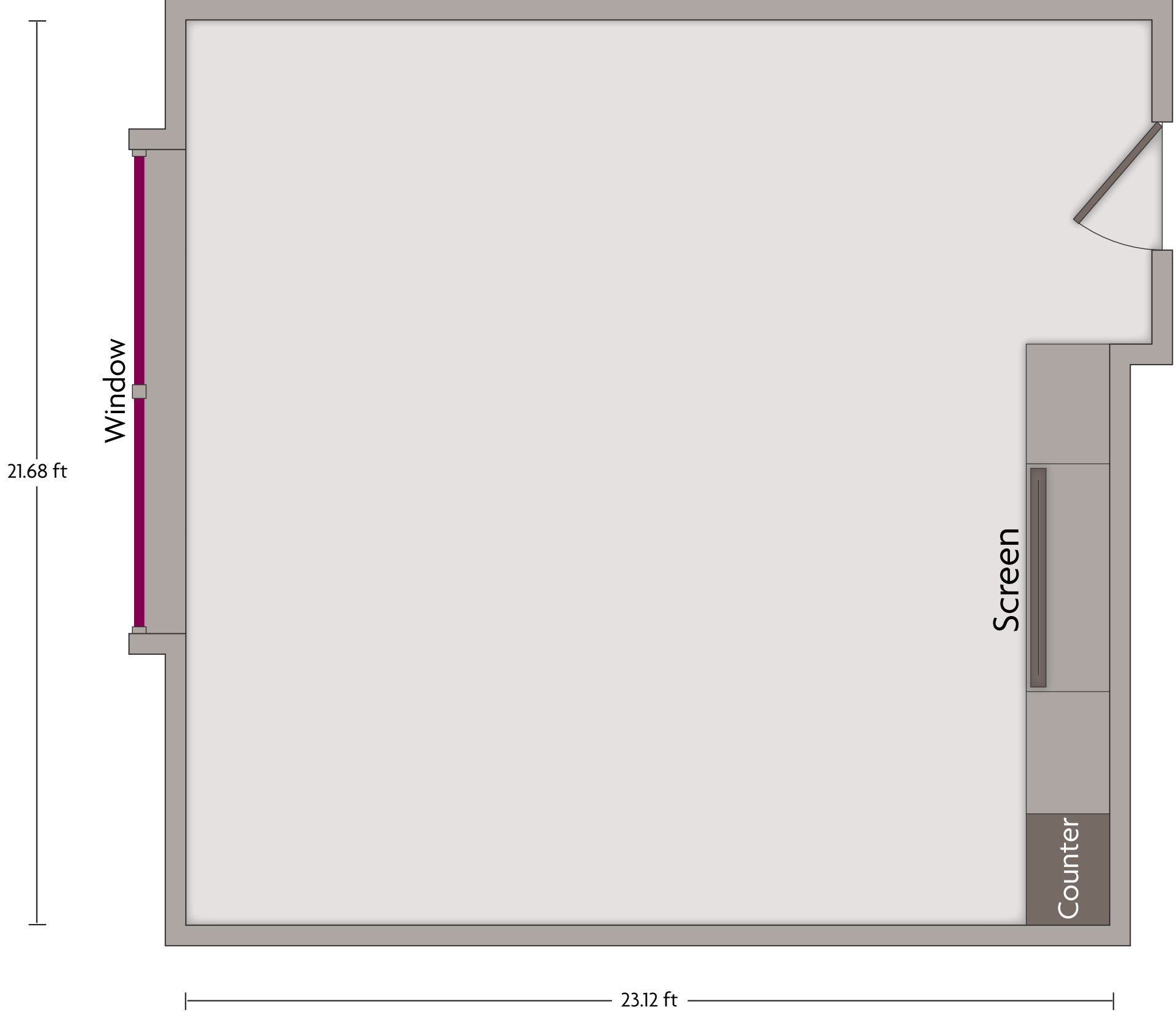

LENGTH: 23.1 ft    WIDTH: 21.7 ft    HEIGHT: 10 ft    TOTAL SQUARE FEET: 459.4 ft<sup>2</sup>    MAXIMUM CAPACITY: 50    POWER OUTLETS: 8

Fieldhouse Lane | Marlow, SL7 1GJ United Kingdom | +44 8704448940

\*Multiple layout options available for this space.

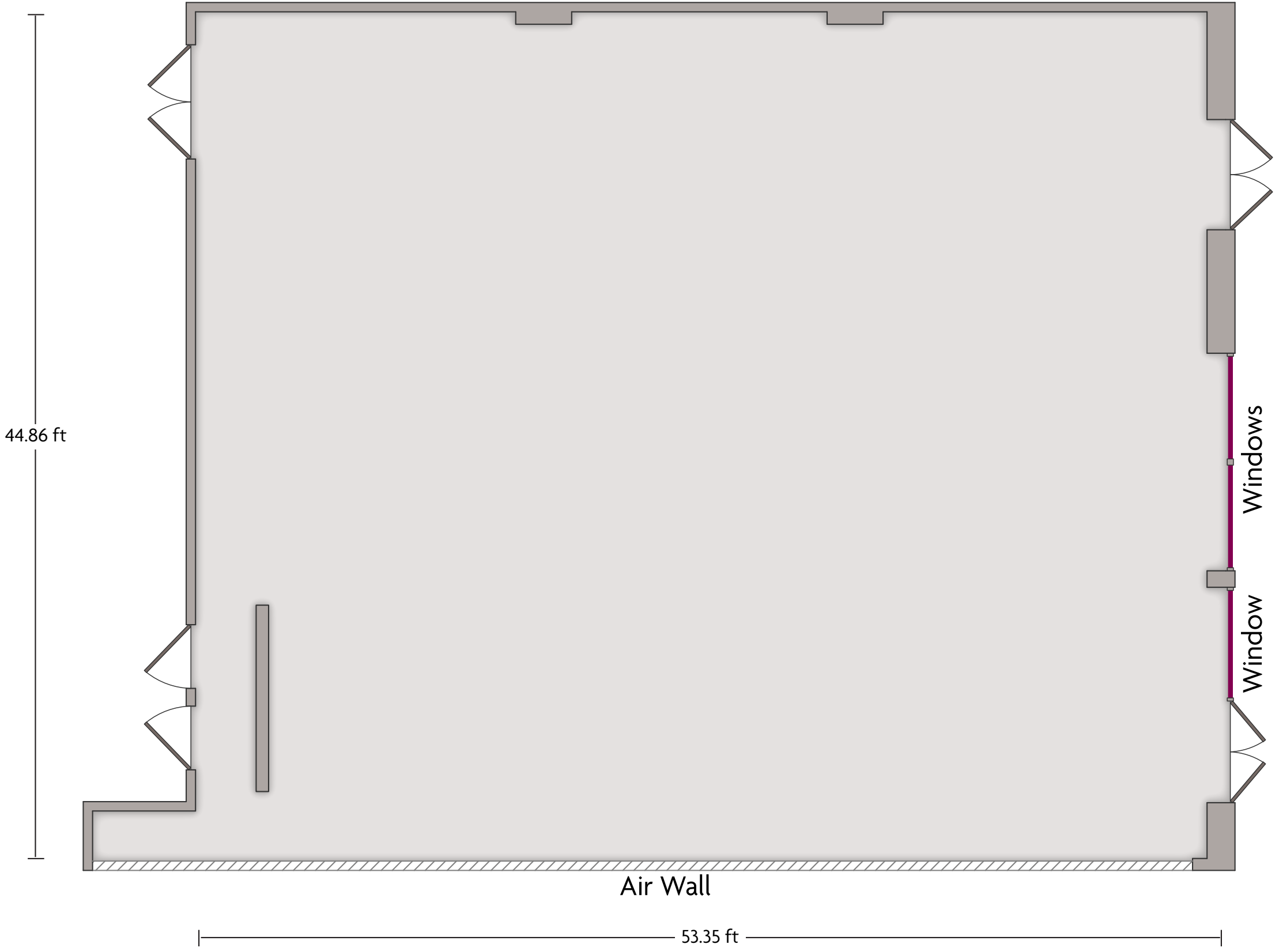

LENGTH: 53.3 ft    WIDTH: 44.9 ft    HEIGHT: 12.7 ft    TOTAL SQUARE FEET: 2,427.3 ft<sup>2</sup>    MAXIMUM CAPACITY: 230    POWER OUTLETS: 10

Fieldhouse Lane I Marlow, SL7 1GJ United Kingdom | +44 8704448940

\*Multiple layout options available for this space.

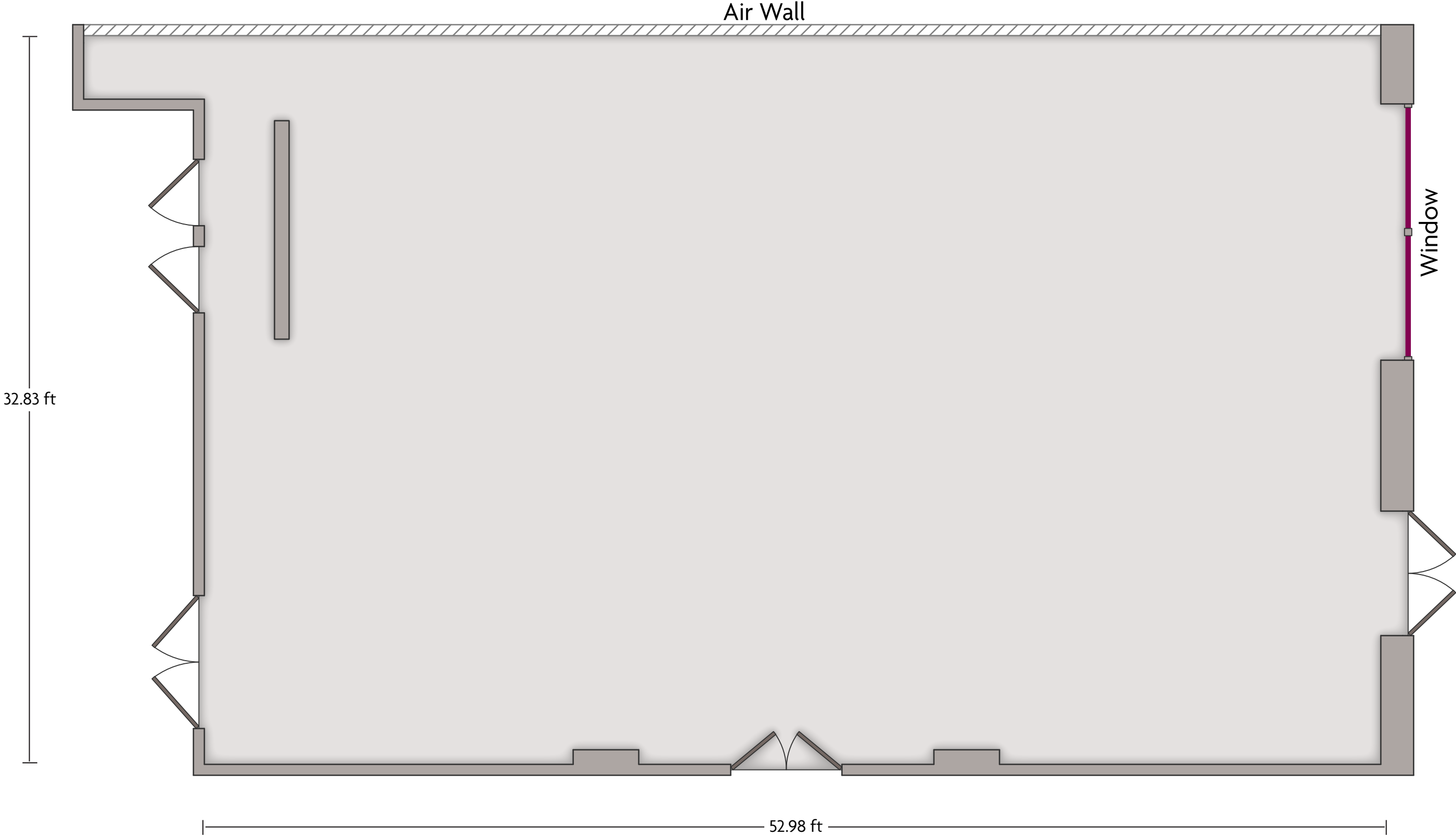

LENGTH: 53 ft    WIDTH: 32.8 ft    HEIGHT: 12.8 ft    TOTAL SQUARE FEET: 1,743.8 ft<sup>2</sup>    MAXIMUM CAPACITY: 220    POWER OUTLETS: 6

Fieldhouse Lane | Marlow, SL7 1GJ United Kingdom | +44 8704448940

\*Multiple layout options available for this space.

# Crowne Plaza® Marlow - Winterlake Suite

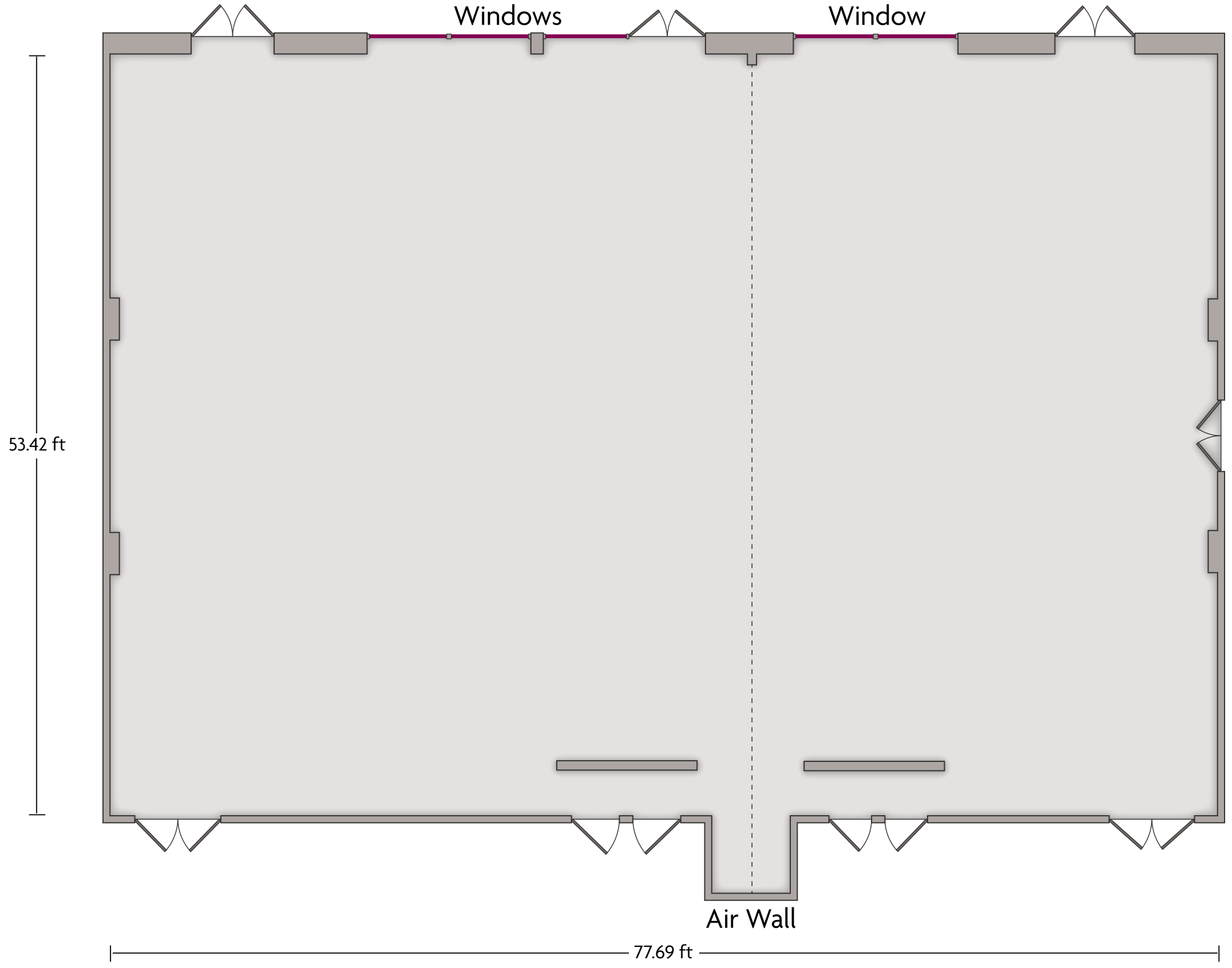

LENGTH: 77.7 ft    WIDTH: 53.4 ft    HEIGHT: 12.8 ft    TOTAL SQUARE FEET: 4,169.7 ft<sup>2</sup>    MAXIMUM CAPACITY: 450    POWER OUTLETS: 16

Fieldhouse Lane | Marlow, SL7 1GJ United Kingdom | +44 8704448940

\*Multiple layout options available for this space.