



CROWNE PLAZA®
AN IHG® HOTEL
GENEVA

WHERE BUSINESS AND HOME MEET IN STYLE



A contemporary-designed four-star hotel enclosed in lush greenery and conveniently located close to the Geneva airport, between majestic mountains and Léman Lake. Like a home away from home, our brand-new flexible and cozy spaces accentuate a sense of intimacy whether you are travelling for business or pleasure.

DARE TO CONNECT

Crowne Plaza Geneva stands out from the crowd, offering a new and distinct experience for travelers and locals with a modern, purposeful design featuring multi-functional zones where guests can switch effortlessly between work and socializing.

Our Dare to Connect service style enhances satisfaction by ensuring our staff have quality personal interactions with guests throughout their stay.

-  366 rooms including 97 twin beds rooms
-  16 modular meeting spaces - 2'000m2
-  Maximum capacity : 800 pax
-  1700 m2 of green spaces
-  Club Lounge
-  Fitness Center
-  Free airport shuttle, every 20 min

BE PRODUCTIVE IN ANY TIME ZONE

We are a business-class accommodation and meetings center that creates an energizing hub for modern business, by providing an unmatched focus on the holistic needs of business travelers from productivity to restoration to inspiration.

We genuinely understand the Modern Traveler. We know that for them, while productivity is important, so are experiences that restore and inspire.

GUEST ROOM BREAKDOWN

ROOM TYPE	No
Standard Room	309
Premium Room	22
Premium Top Floor	24
one Bedroom Suite	4
Junior Suite High Floor	6
Suite Mountain View	1
Total	366



DINING



LE JARDIN

Buffet Breakfast at its best

Location -1
Capacity 120 inside | 30 terrace

🕒 6:30am - 10:30am



SEVENTY5

Contemporary brasserie open for lunch and dinner

Location Lobby Floor
Capacity 75 inside | 28 terrace

🕒 Monday till Friday : noon - 2pm
7pm - 10pm

Saturday : Closed
Sunday : 7pm - 10pm



LE BAR

Trendy bar, friendly atmosphere and cosy setting

Location Ground Floor
Capacity 60 inside | 30 terrace

🕒 Monday to Sunday : 7:30am-00:00



LE CHALET

Swiss specialties are in the spotlight

Location Outside, close to the terrace
Capacity Private dining for 2 to 8 pax

🕒 Everyday from 12pm - 2pm
from 6pm - 10pm



CLUB LOUNGE

Relax in total tranquillity, Club Room access

Location Top floor

🕒 Open 7 days a week
From 6:30 am - 10:30



MEETINGS

You need to be connected to be productive; whether it's great WiFi, integrated technologies (AV, sound system and projection) or just well-positioned power sources, we have it covered.

Flexible meetings, no hidden cost

A range of different furniture settings creating on-demand workspaces, ideal for the meetings that happen around the meetings.



- Lift
- Comfort zone
- Power table
- Minibar
- Coffee
- Drinks & snacks
- WC

CONFIGURATIONS

MEETING ROOMS	AREA	DIMENSION	HEIGHT	THEATRE	CLASSROOM	"U" SHAPE	BOARDROOM	CABARET	BANQUET	COCKTAIL	NATURAL DAYLIGHT
INTERNATIONAL	558 m ²	38 x 14.70m	4.6	675	350	120	110	288	500	675	no
ZÜRICH	185 m ²	14.70 x 12.60m		250	130	51	40	96	150	200	no
LONDRES	188 m ²	14.70 x 12.80m		250	130	51	40	96	150	200	no
NEW YORK	185 m ²	14.70 x 12.60m		250	130	51	40	96	150	200	no
EUROPE	245 m ²	25.60 x 9.60m	2.8	200	120	80	80	78	160	200	no
LISBONNE	65 m ²	9.60 x 6.80m		50	30	24	28	24	40	50	no
COPENHAGUE	61 m ²	9.60 x 6.40m		50	30	24	28	24	40	50	no
PARIS	61 m ²	9.60 x 6m		50	30	24	28	24	40	50	no
MÜNICH	58 m ²	9.60 x 6m	50	30	24	28	24	40	50	no	
FOYER INTERNATIONAL	360 m ²	38 x 6m	2.8	-	-	-	-	-	-	300	no
GENÈVE	163 m ²	21.85 x 5.70m		-	-	-	-	-	100	180	yes
COINTRIN	90 m ²	--		40	42	18	14	18	40	50	yes
CORNAVAIN	36 m ²	6.30 x 5.70m		36	24	15	14	12	24	20	yes
SERVETTE	37 m ²	6.55 x 5.70m		36	24	15	14	12	24	20	yes
LEMAN	30 m ²	--		-	-	-	14	-	-	-	no
MONT BLANC	17 m ²	5.7 x 3.05m		-	-	-	10	-	-	-	yes
SALON : A / B / C	15 m ²	5 x 3m		-	-	-	8	-	-	-	no
RESTAURANT Le Jardin	266 m ²	--		-	-	-	-	-	130	80	yes
Mon BUREAU Lobby	17 m ²	5.20 x 3.3m		2.6	-	-	6	-	-	-	yes

OUTDOOR SPACE LAYOUT

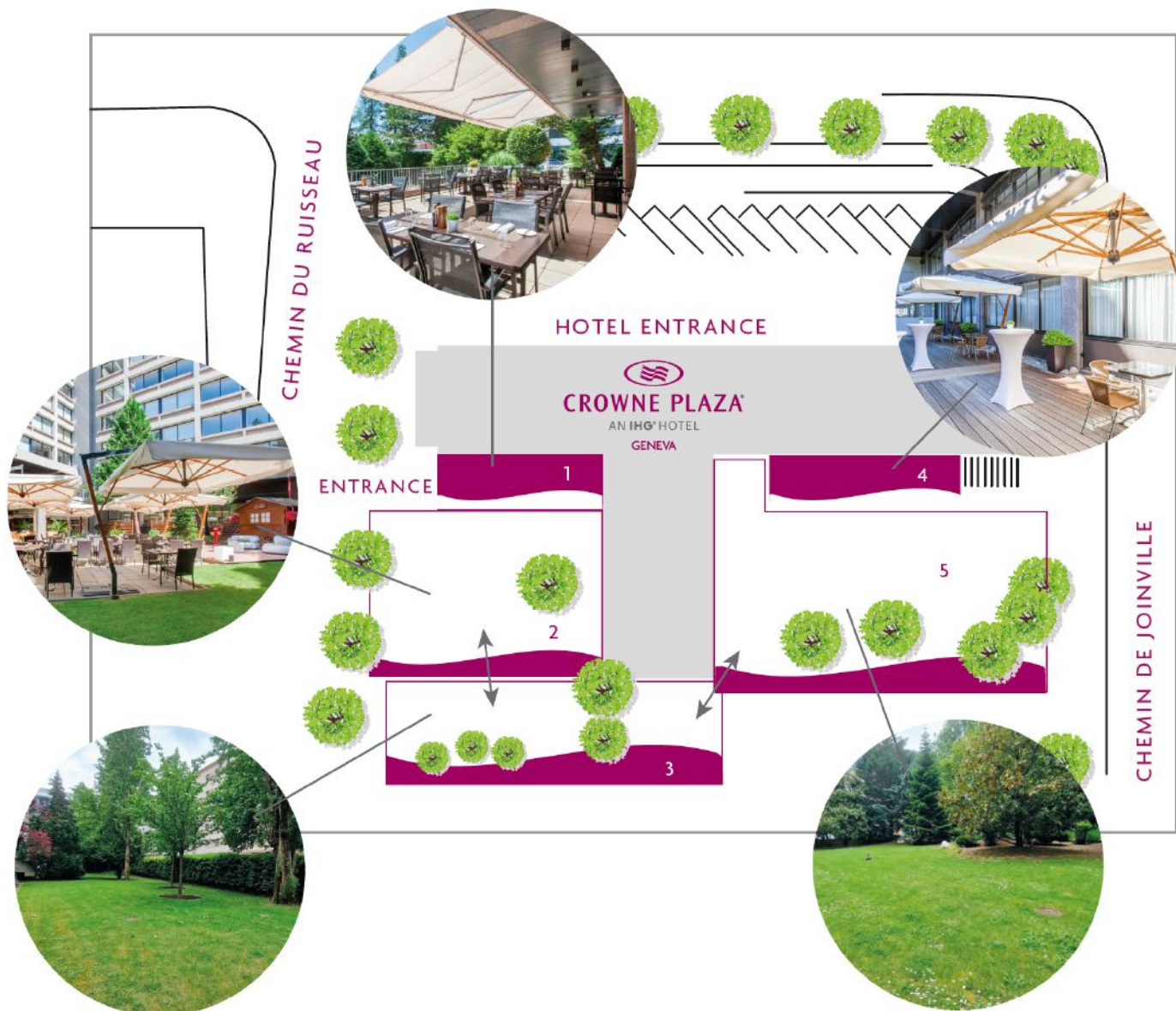

1. SEVENTY5 TERRACE - 1 507 SQ FT

ACCESS VIA THE RESTAURANT

COCKTAIL: 50 PAX

BUFFET: 50 PAX

BANQUET: 50 PAX (EXISTING SET UP)

2. «LE JARDIN» TERRACE - 3 272 SQ FT

ACCESS VIA «LE JARDIN»

COCKTAIL: 80 PAX

BUFFET: 80 PAX

BANQUET: 50 (EXISTING SET UP)

3. UPPER TERRACE OF «LE JARDIN» - 2 906 SQ FT

ACCESS VIA «LE JARDIN» TERRACE

COCKTAIL: 100 PAX

BUFFET: 100 PAX

BANQUET: 60 PAX

4. BANQUET TERRACE - 2 153 SQ FT

COCKTAIL: 90 PAX

BUFFET: 60 PAX

COCKTAIL: 60 PAX

5. GRAND JARDIN - 12 917 SQ FT

ACCESS VIA «LE JARDIN» UPPER TERRACE

COCKTAIL: 200 PAX

BUFFET: 110 PAX

BANQUET: 110 PAX

3 + 5. UPPER TERRACE OF «LE JARDIN»

+ GRAND JARDIN - 1 5823 SQ FT

COCKTAIL: 300 PAX

SERVICE CHARGES: CHF 3'000



CONNECTING OUTDOOR SPACES

FOR ALL AREAS,
DJ POSSIBLE UNTIL 09:30PM



We know that sustainability is as important to you as it is to us – and that’s why we’ve made it easy for you to stay at a hotel that shares your values. By staying in Crowne Plaza Geneva it means that you are part of a worldwide effort to protect our environment.



ENVIRONMENT

We have adopted IHG Green Engage, alongside a commitment to rolling out thermal solar panels on the roof, Paperless Check-in, Linen reuse policy, Straw-Free Restaurants and Bars, Biodegradable Coffee Cups, EV Chargers.



COMMUNITY

Perhaps one of the most important parts of creating a company built on sustainability is the social fabric that surrounds it: the community. Giving to those in need through programmes that reduce waste and repurpose it for a greater good is an excellent way to give back in a way that helps those who need it as well as the environment.



ENGAGEMENT

At Crowne Plaza Geneva, we don’t believe it’s enough to simply preach sustainability, we actively work towards it in engaging ways. By implementing recycling bins, soap, amenities, caps and cups and programs like Greener Stay, Giving for Good Month, Bike to Work, Sustainable Tourism and to tasty cuisine crafted from regionally sourced produce, we’re making a difference by reducing waste, conserving energy and water.

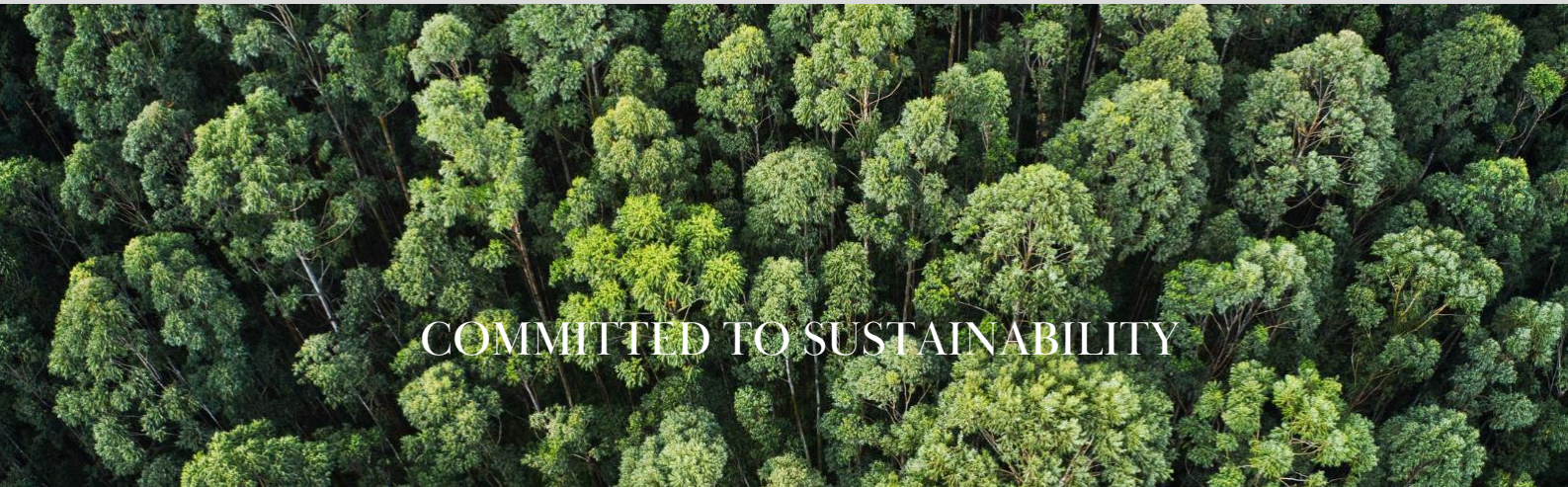

COMMITTED TO SUSTAINABILITY

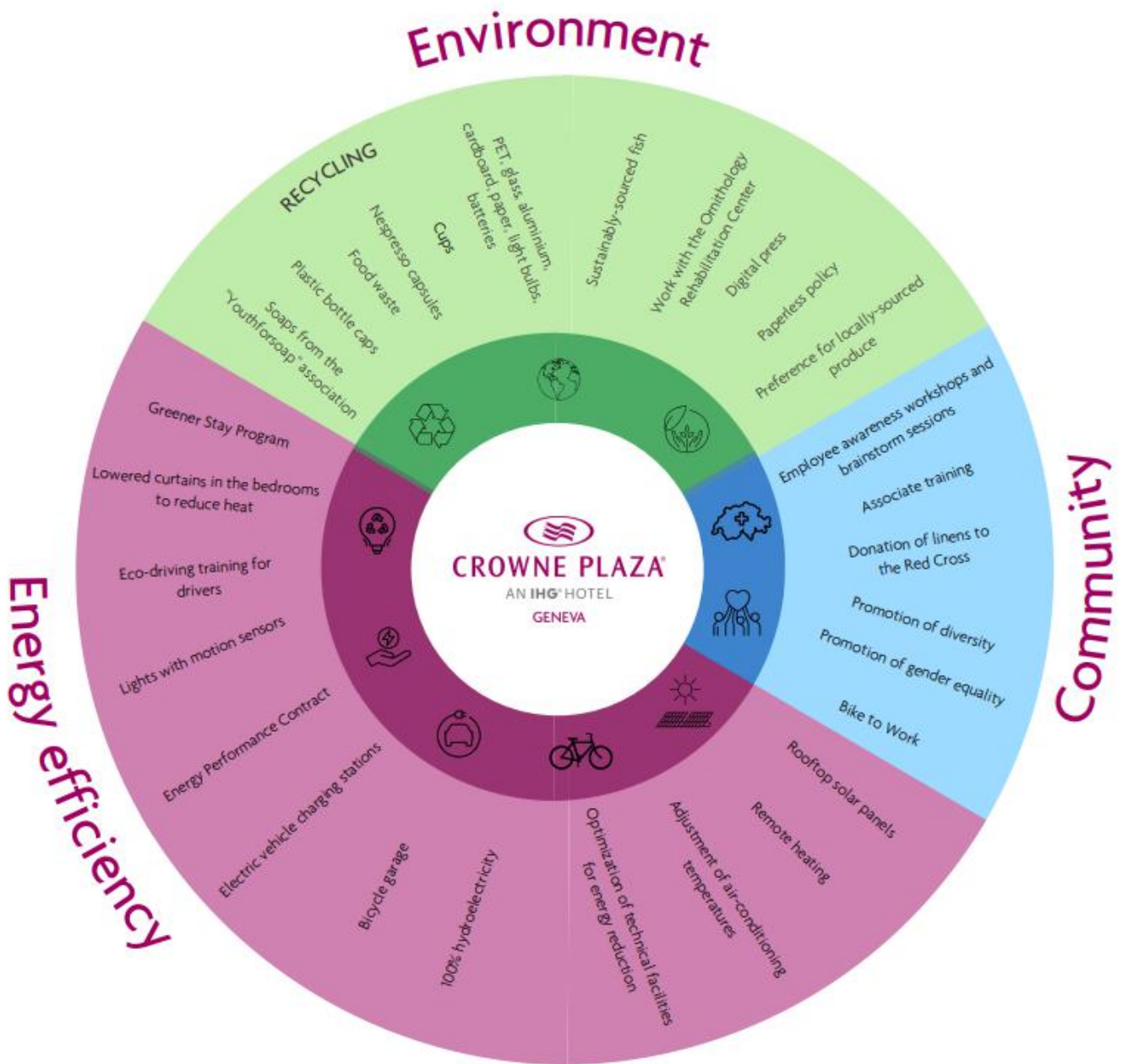



STRATEGIC LOCATION

Located near Geneva Airport and the Palexo International Exhibition and Convention Center, the hotel connects you to everything that counts.

Exploring Geneva is made easy since we are only fifteen minutes away from the city center.



5 minutes from airport



15 minutes away from city center



On-site Parking : 125
2 electric cars charging station



3 available parking spaces for buses

CROWNE PLAZA GENEVA

Avenue Louis Casai, 75-77
1216 Genève, Suisse

w:geneva.crowneplaza.com tel: +41 22 710 30 00

