

# Crowne Plaza® Beijing International Airport Lincoln Ballroom

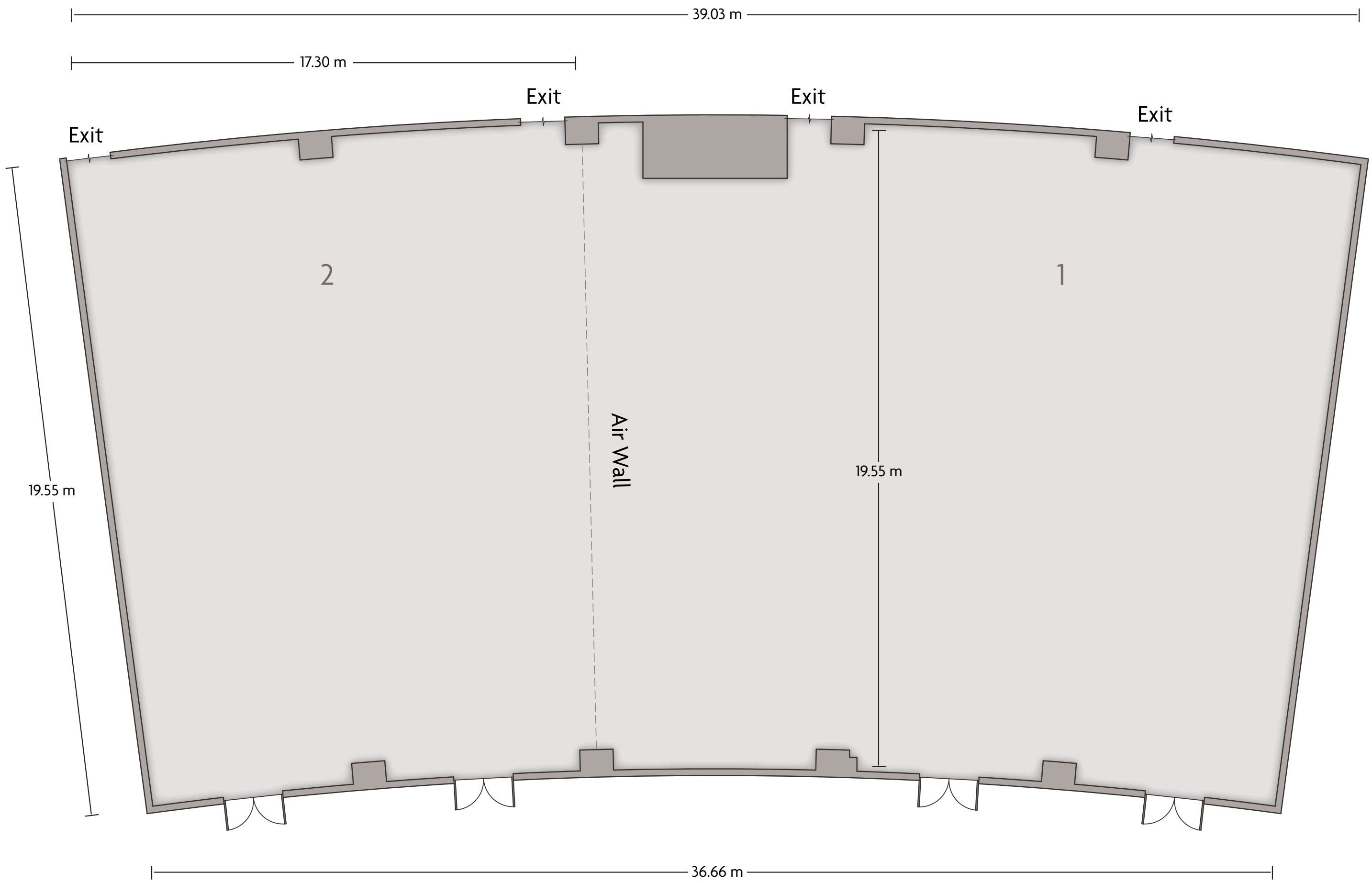

LENGTH: 39.03 m    WIDTH: 19.55 m    HEIGHT: 6.67 m    TOTAL SQUARE METERS: 740.00 m<sup>2</sup>    MAXIMUM CAPACITY: 700    POWER OUTLETS: 22

60, Fuqian 1 St., Tianzhu, Shunyi District, Beijing 101312, P.R. China | (86) 10 58108888

\*Multiple layout options available for this space.

# Crowne Plaza® Beijing International Airport

## Meeting Room 1

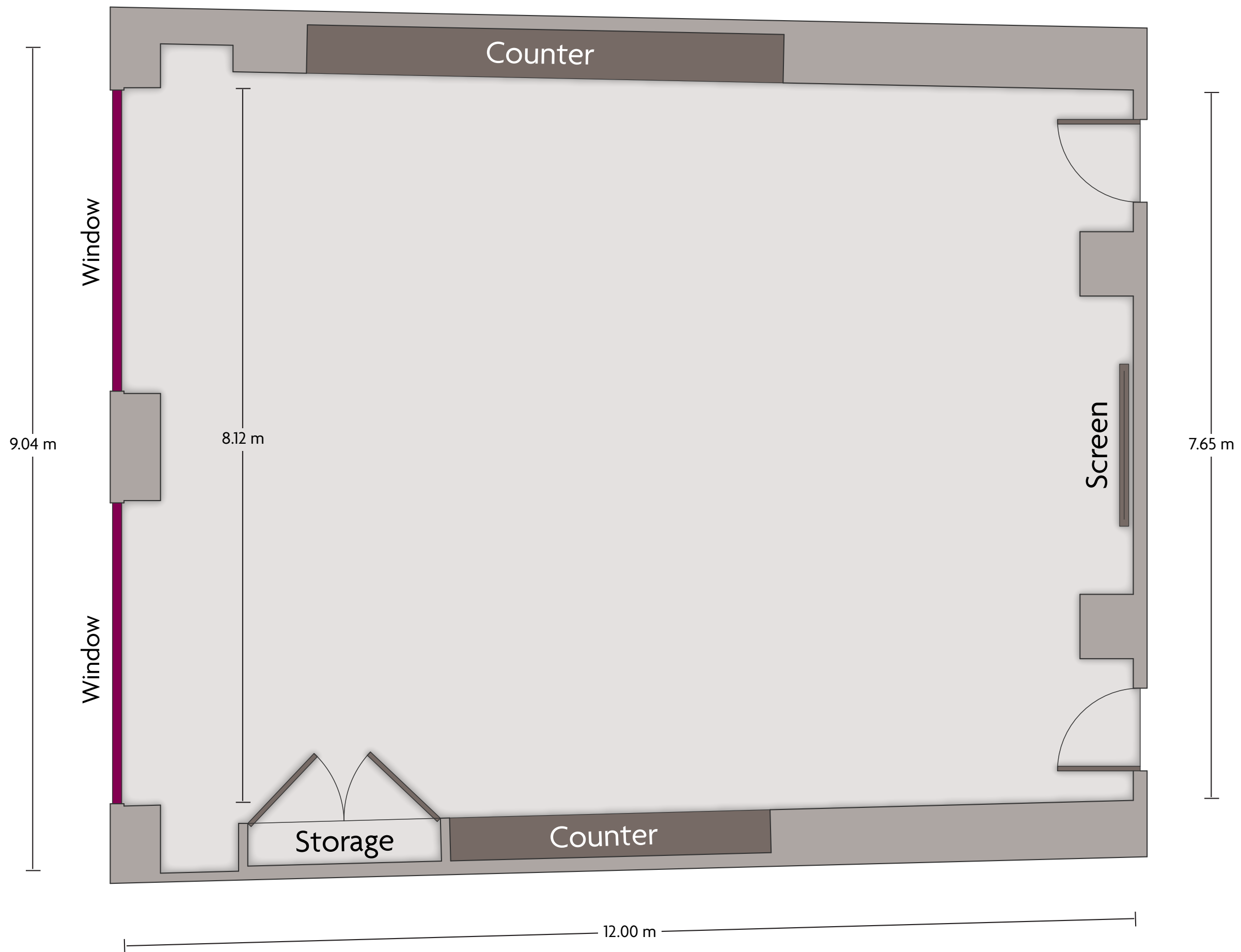

LENGTH: 12.00 m    WIDTH: 9.04 m    HEIGHT: 3.30 m    TOTAL SQUARE METERS: 100.00 m<sup>2</sup>    MAXIMUM CAPACITY: 140    POWER OUTLETS: 7

60, Fuqian 1 St., Tianzhu, Shunyi District, Beijing 101312, P.R. China | (86) 10 58108888

\*Multiple layout options available for this space.

# Crowne Plaza® Beijing International Airport

## Meeting Room 2

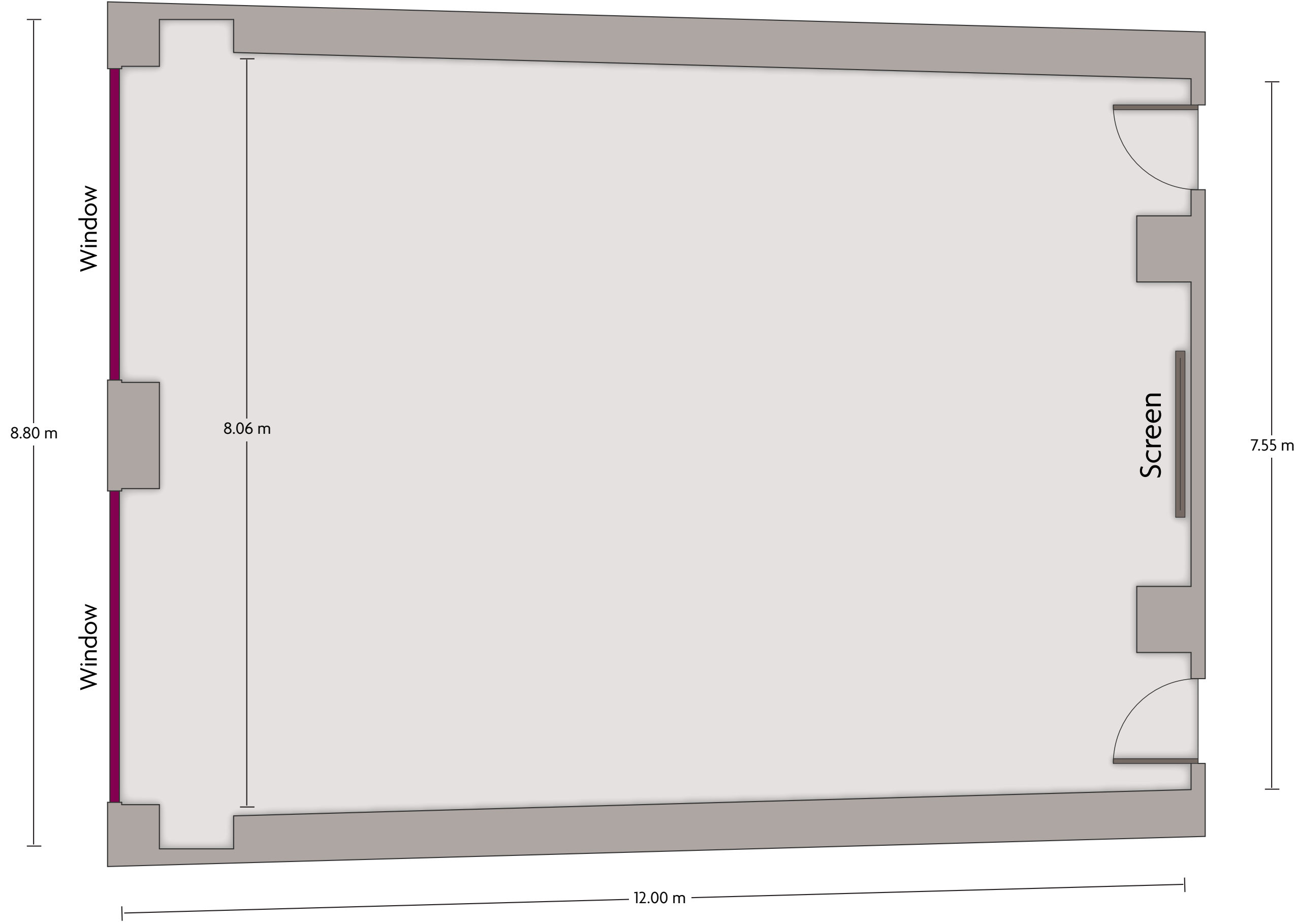

LENGTH: 12.00 m    WIDTH: 8.80 m    HEIGHT: 3.30 m    TOTAL SQUARE METERS: 98.00 m<sup>2</sup>    MAXIMUM CAPACITY: 140    POWER OUTLETS: 9

60, Fuqian 1 St., Tianzhu, Shunyi District, Beijing 101312, P.R. China | (86) 10 58108888

\*Multiple layout options available for this space.

# Crowne Plaza® Beijing International Airport

## Meeting Room 3

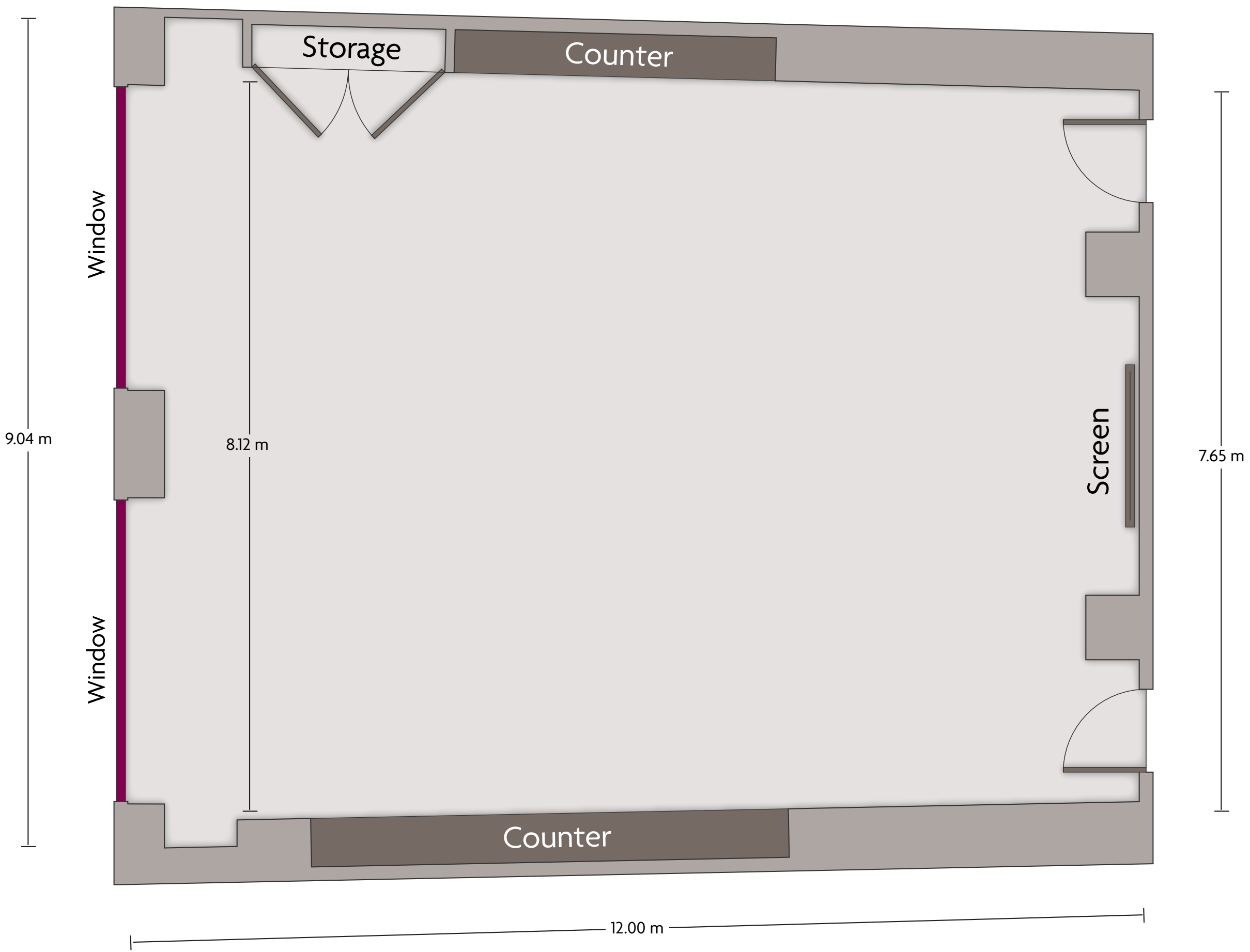

LENGTH: 12.00 m    WIDTH: 9.04 m    HEIGHT: 3.30 m    TOTAL SQUARE METERS: 100.00 m<sup>2</sup>    MAXIMUM CAPACITY: 140    POWER OUTLETS: 7

60, Fuqian 1 St., Tianzhu, Shunyi District, Beijing 101312, P.R. China | (86) 10 58108888

\*Multiple layout options available for this space.

# Crowne Plaza® Beijing International Airport

## Meeting Room 4



LENGTH: 7.68 m    WIDTH: 6.00 m    HEIGHT: 3.30 m    TOTAL SQUARE METERS: 45.00 m<sup>2</sup>    MAXIMUM CAPACITY: 45    POWER OUTLETS: 3

60, Fuqian 1 St., Tianzhu, Shunyi District, Beijing 101312, P.R. China | (86) 10 58108888

\*Multiple layout options available for this space.

# Crowne Plaza® Beijing International Airport

## Meeting Room 5

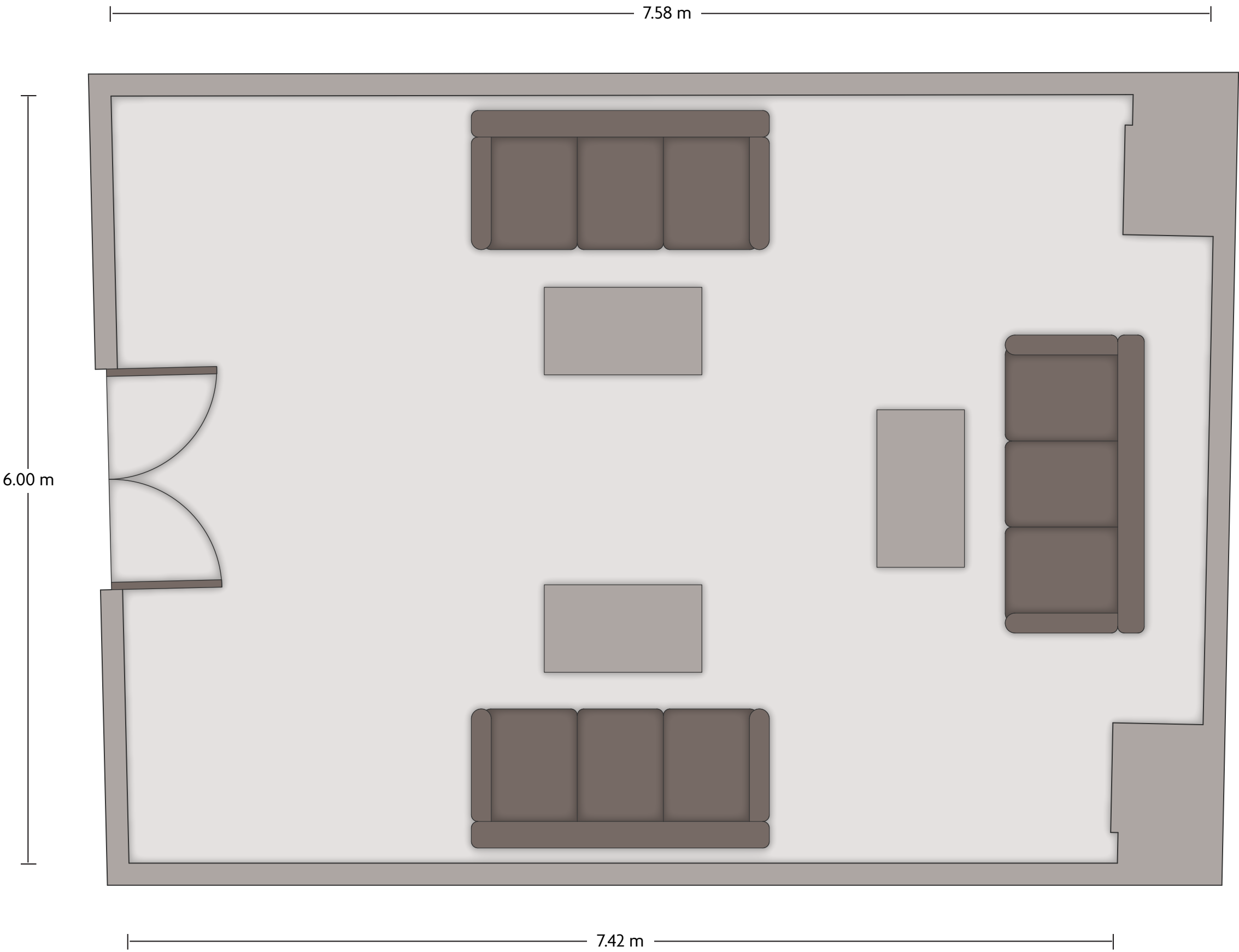

LENGTH: 7.58 m    WIDTH: 6.00 m    HEIGHT: 3.30 m    TOTAL SQUARE METERS: 45.00 m<sup>2</sup>    MAXIMUM CAPACITY: 30    POWER OUTLETS: 4

60, Fuqian 1 St., Tianzhu, Shunyi District, Beijing 101312, P.R. China | (86) 10 58108888

\*Multiple layout options available for this space.

# Crowne Plaza® Beijing International Airport

## Meeting Room 6

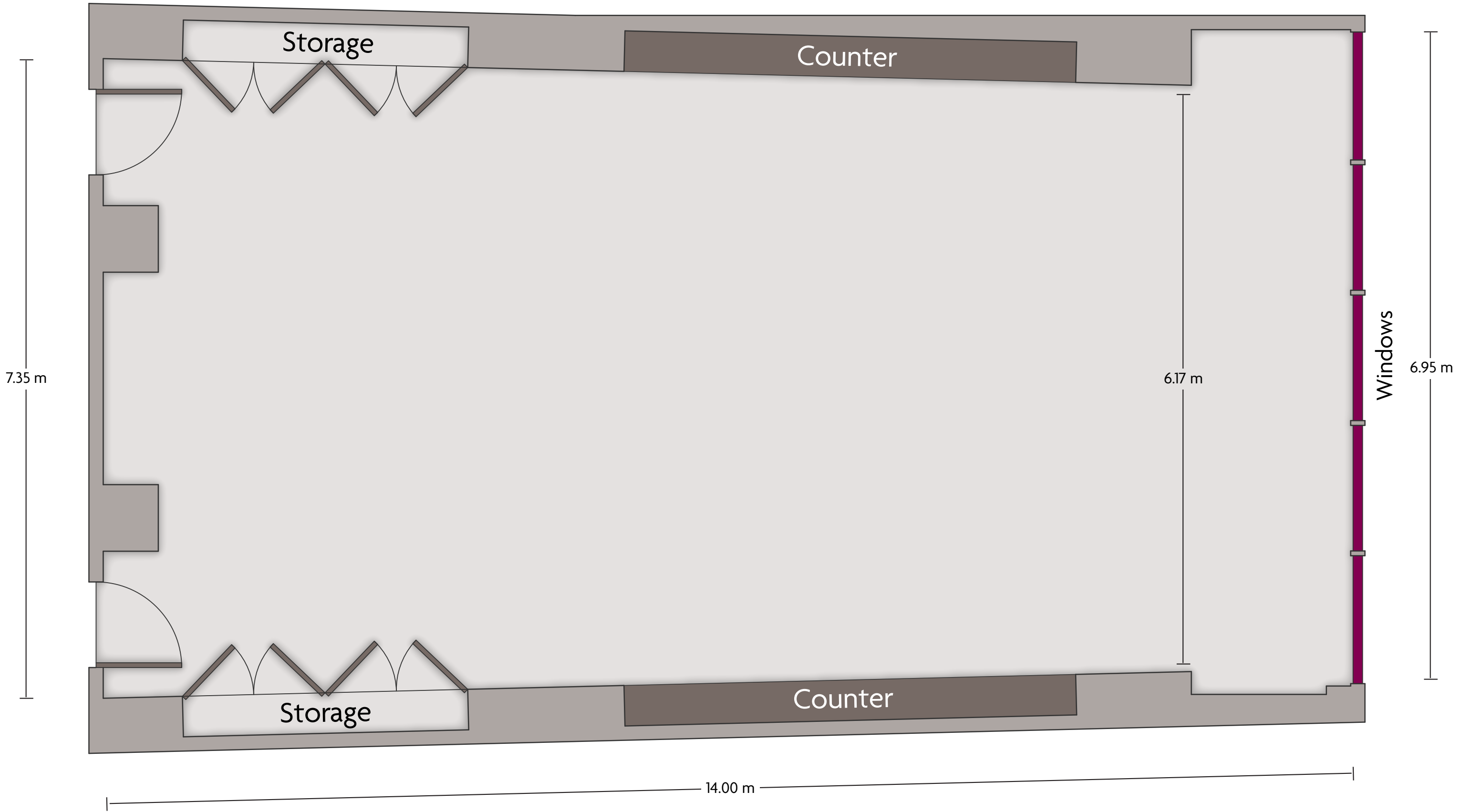

LENGTH: 14.00 m    WIDTH: 7.35 m    HEIGHT: 2.50 m    TOTAL SQUARE METERS: 100.00 m<sup>2</sup>    MAXIMUM CAPACITY: 150    POWER OUTLETS: 7

60, Fuqian 1 St., Tianzhu, Shunyi District, Beijing 101312, P.R. China | (86) 10 58108888

\*Multiple layout options available for this space.

# Crowne Plaza® Beijing International Airport

## Meeting Room 7

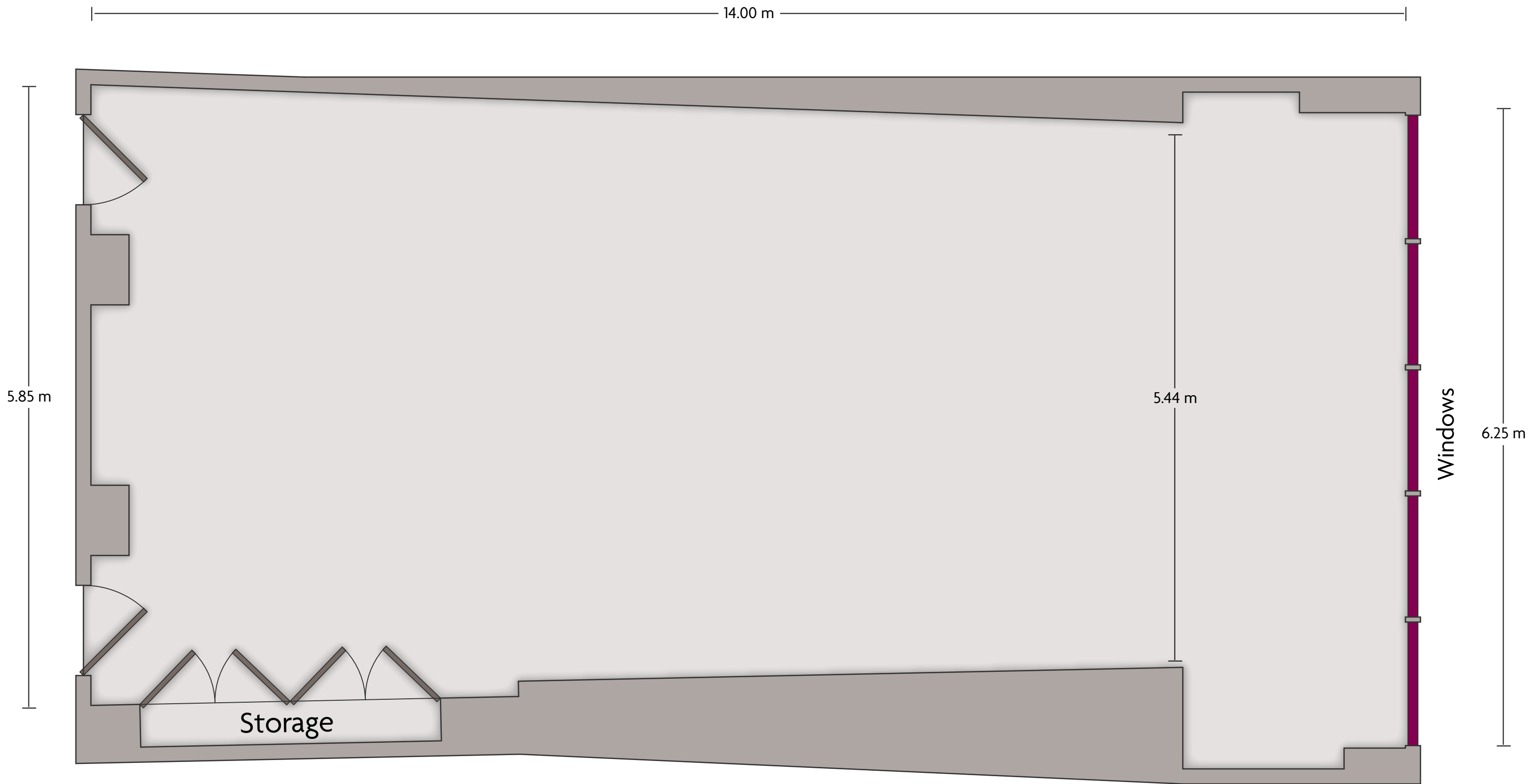

LENGTH: 14.00 m    WIDTH: 6.25 m    HEIGHT: 2.50 m    TOTAL SQUARE METERS: 85.00 m<sup>2</sup>    MAXIMUM CAPACITY: 150    POWER OUTLETS: 7

60, Fuqian 1 St., Tianzhu, Shunyi District, Beijing 101312, P.R. China | (86) 10 58108888

\*Multiple layout options available for this space.



# Crowne Plaza® Beijing International Airport

## Meeting Room 8

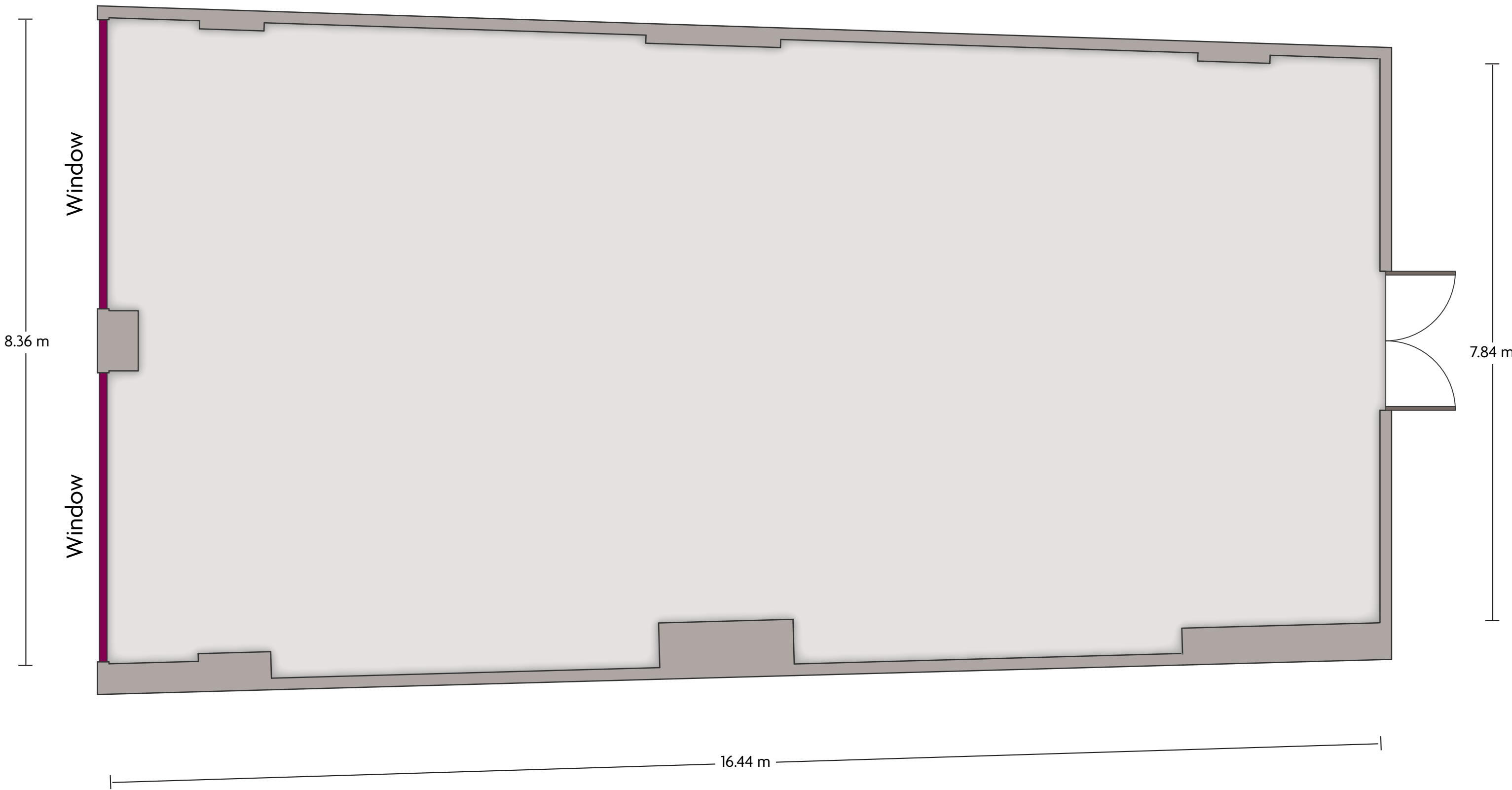

LENGTH: 16.40 m    WIDTH: 8.40 m    HEIGHT: 3.17 m    TOTAL SQUARE METERS: 133.00 m<sup>2</sup>    MAXIMUM CAPACITY: 120    POWER OUTLETS: 15

60, Fuqian 1 St., Tianzhu, Shunyi District, Beijing 101312, P.R. China | (86) 10 58108888

\*Multiple layout options available for this space.

# Crowne Plaza® Beijing International Airport

## Meeting Room 9

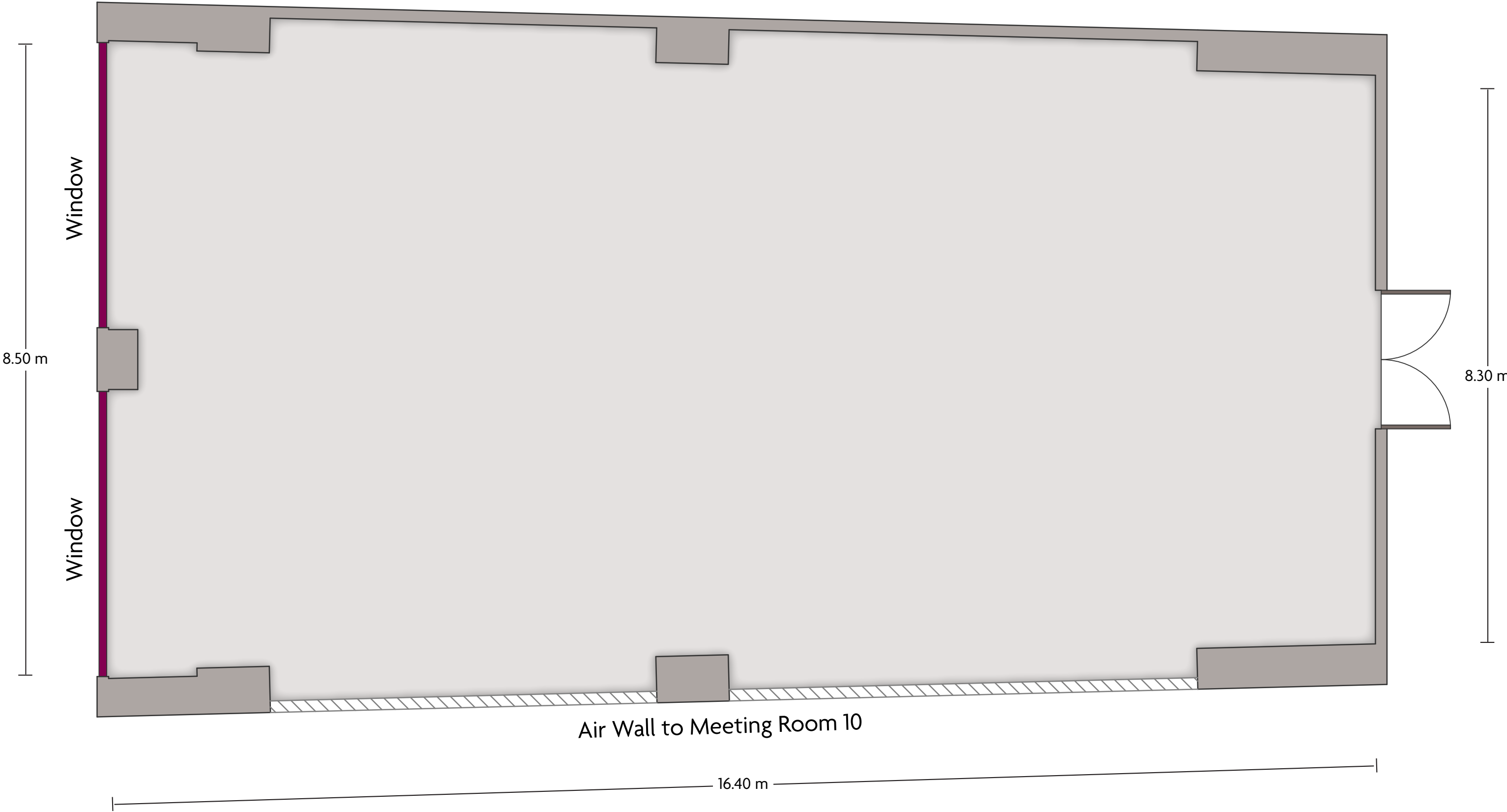

LENGTH: 16.40 m    WIDTH: 8.40 m    HEIGHT: 3.17 m    TOTAL SQUARE METERS: 138.00 m<sup>2</sup>    MAXIMUM CAPACITY: 120    POWER OUTLETS: 8

60, Fuqian 1 St., Tianzhu, Shunyi District, Beijing 101312, P.R. China | (86) 10 58108888

\*Multiple layout options available for this space.

# Crowne Plaza® Beijing International Airport

## Meeting Room 10



**CROWNE PLAZA®**

BEIJING INTERNATIONAL AIRPORT

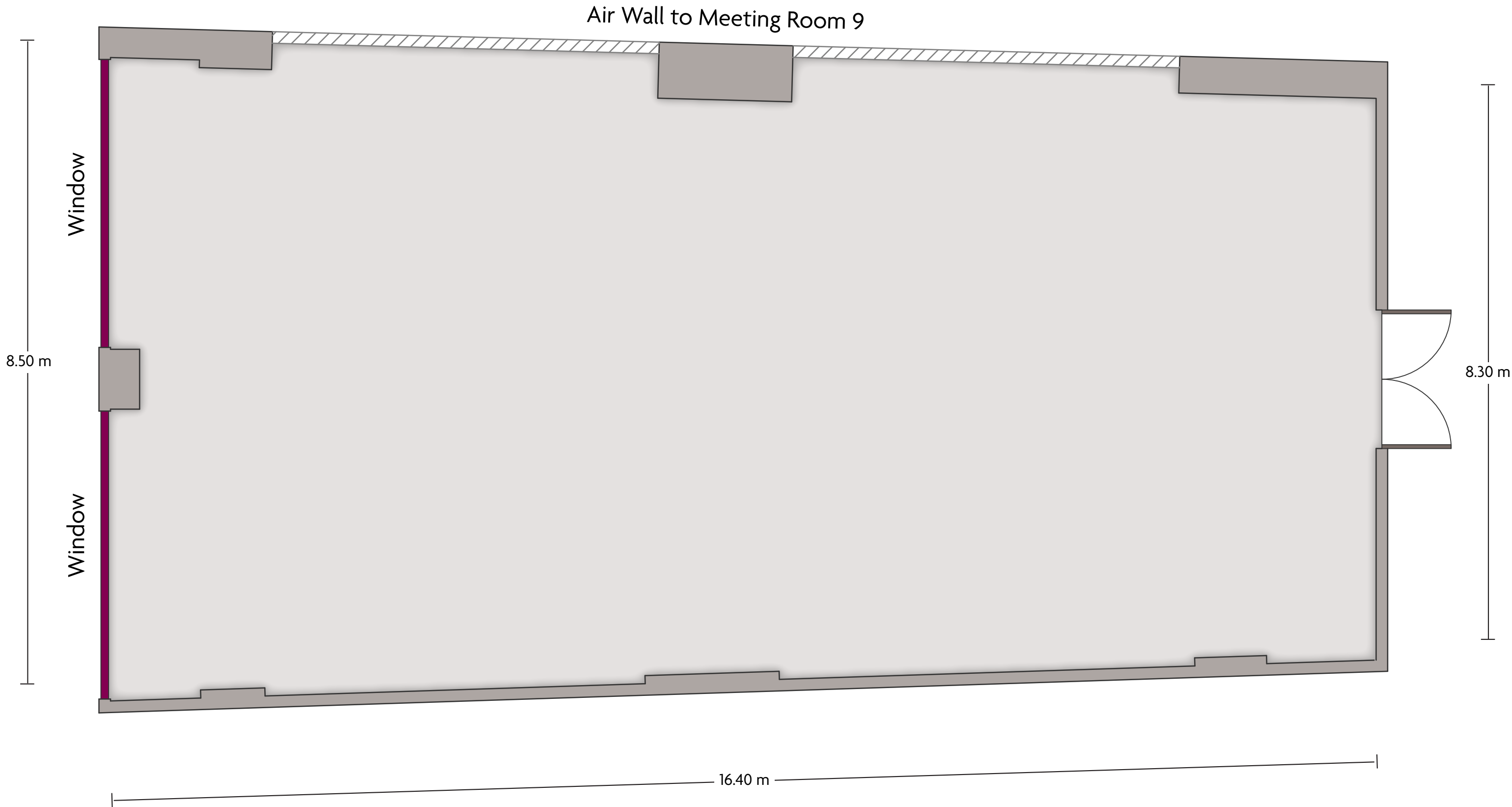

LENGTH: 16.46 m    WIDTH: 8.40 m    HEIGHT: 3.17 m    TOTAL SQUARE METERS: 138.00 m<sup>2</sup>    MAXIMUM CAPACITY: 120    POWER OUTLETS: 8

60, Fuqian 1 St., Tianzhu, Shunyi District, Beijing 101312, P.R. China | (86) 10 58108888

\*Multiple layout options available for this space.