

LENGTH: 25.20 m    WIDTH: 6.75 m    HEIGHT: 2.96 m    TOTAL SQUARE METERS: 153 m<sup>2</sup>    MAXIMUM CAPACITY: 70    POWER OUTLETS: 13

16-3 Showa-Machi I Kanazawa-shi Ishikawa, Japan - 920-8518 | 81-76-2246111 \*Multiple layout options available for this space.

# ANA Crowne Plaza® Kanazawa - C'est La Vie

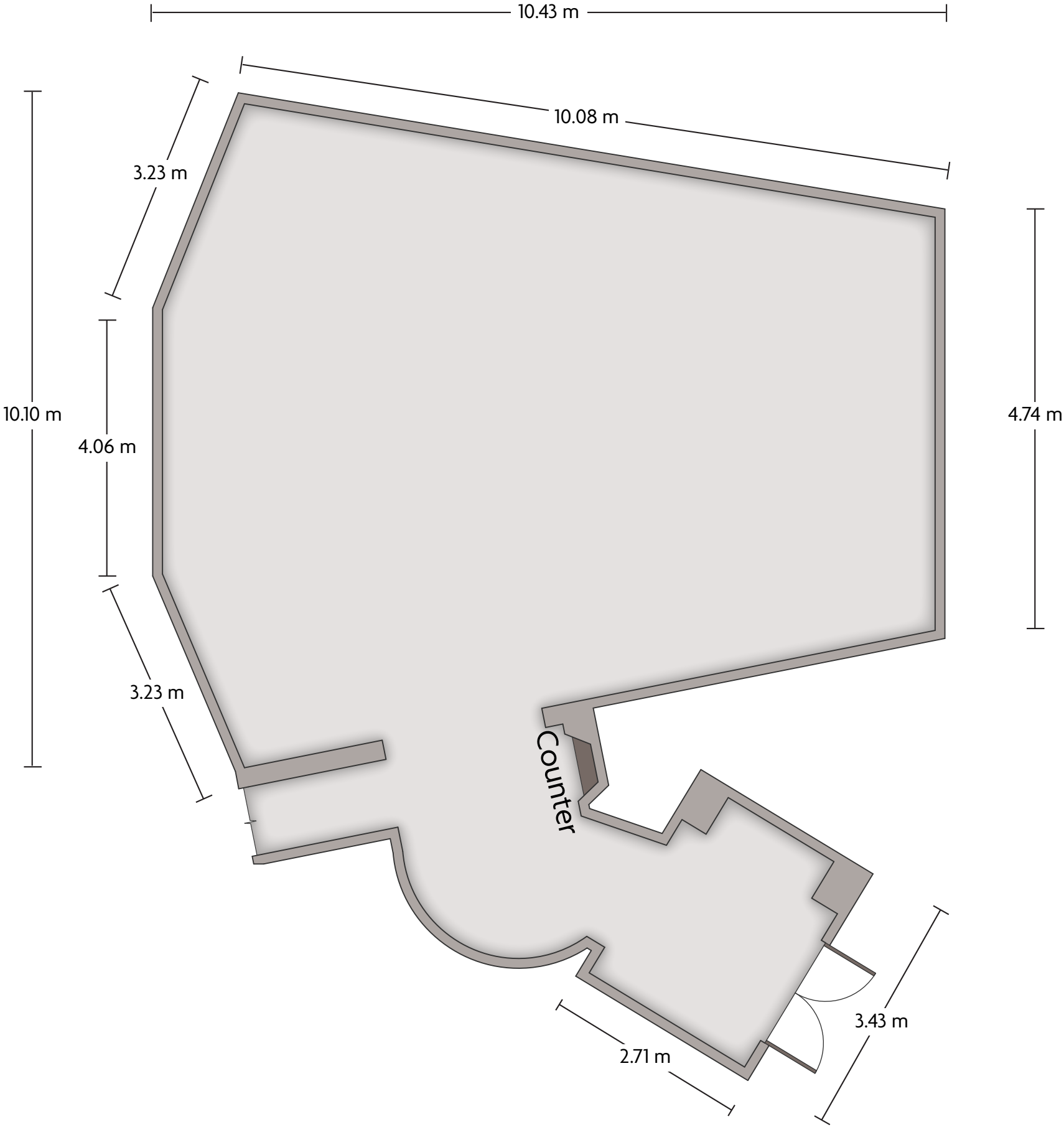

LENGTH: 10.43 m    WIDTH: 10.10 m    HEIGHT: 2.40 m    TOTAL SQUARE METERS: 83 m<sup>2</sup>    MAXIMUM CAPACITY: 100    POWER OUTLETS: 7

16-3 Showa-Machi I Kanazawa-shi Ishikawa, Japan - 920-8518 | 81-76-2246111 \*Multiple layout options available for this space.

# ANA Crowne Plaza® Kanazawa - Kujoyaku

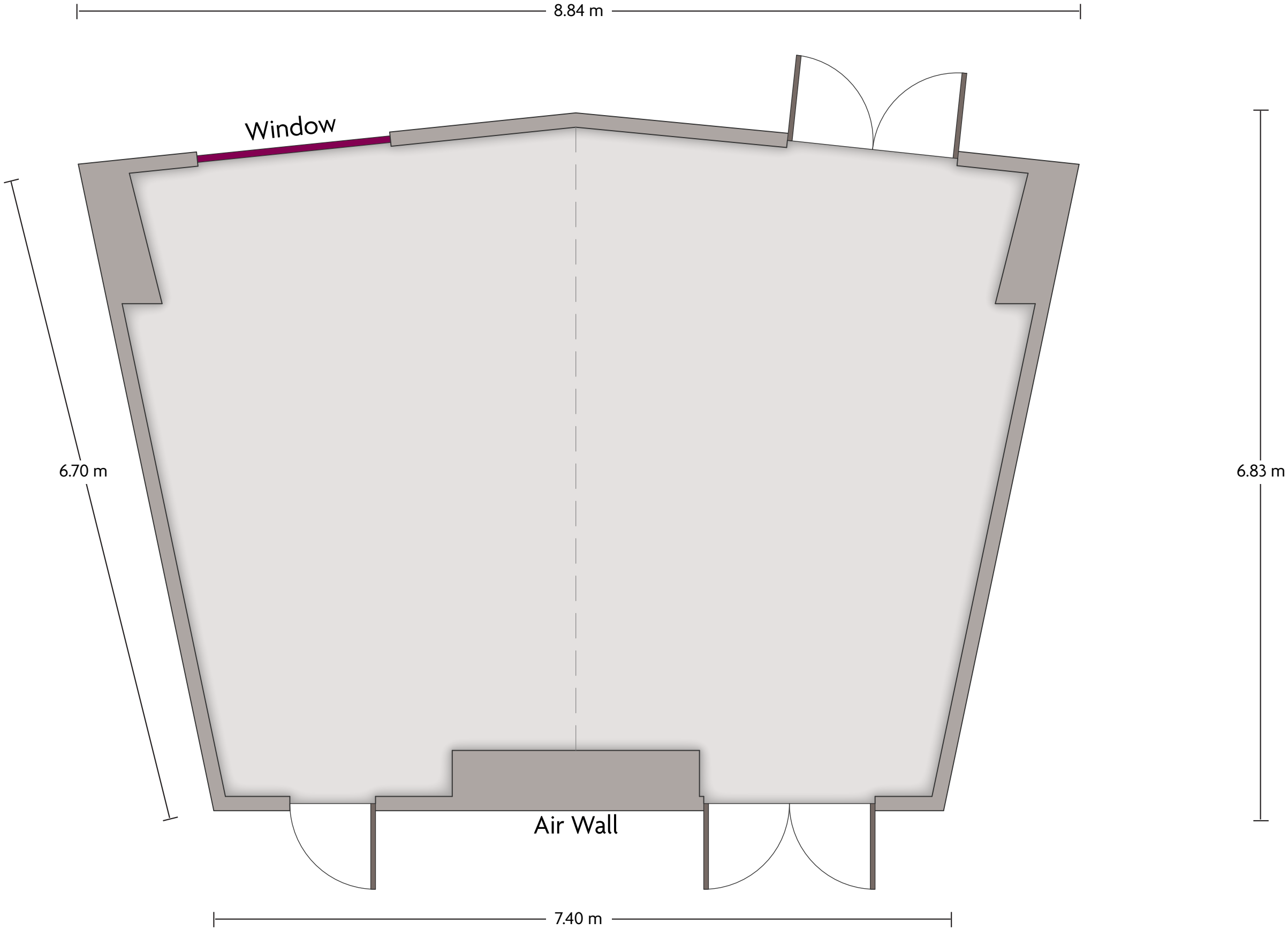

LENGTH: 8.84 m    WIDTH: 6.83 m    HEIGHT: 2.70 m    TOTAL SQUARE METERS: 58 m<sup>2</sup>    MAXIMUM CAPACITY: 50    POWER OUTLETS: 4

16-3 Showa-Machi I Kanazawa-shi Ishikawa, Japan - 920-8518 | 81-76-2246111 \*Multiple layout options available for this space.

# ANA Crowne Plaza® Kanazawa - Ootori (Full)

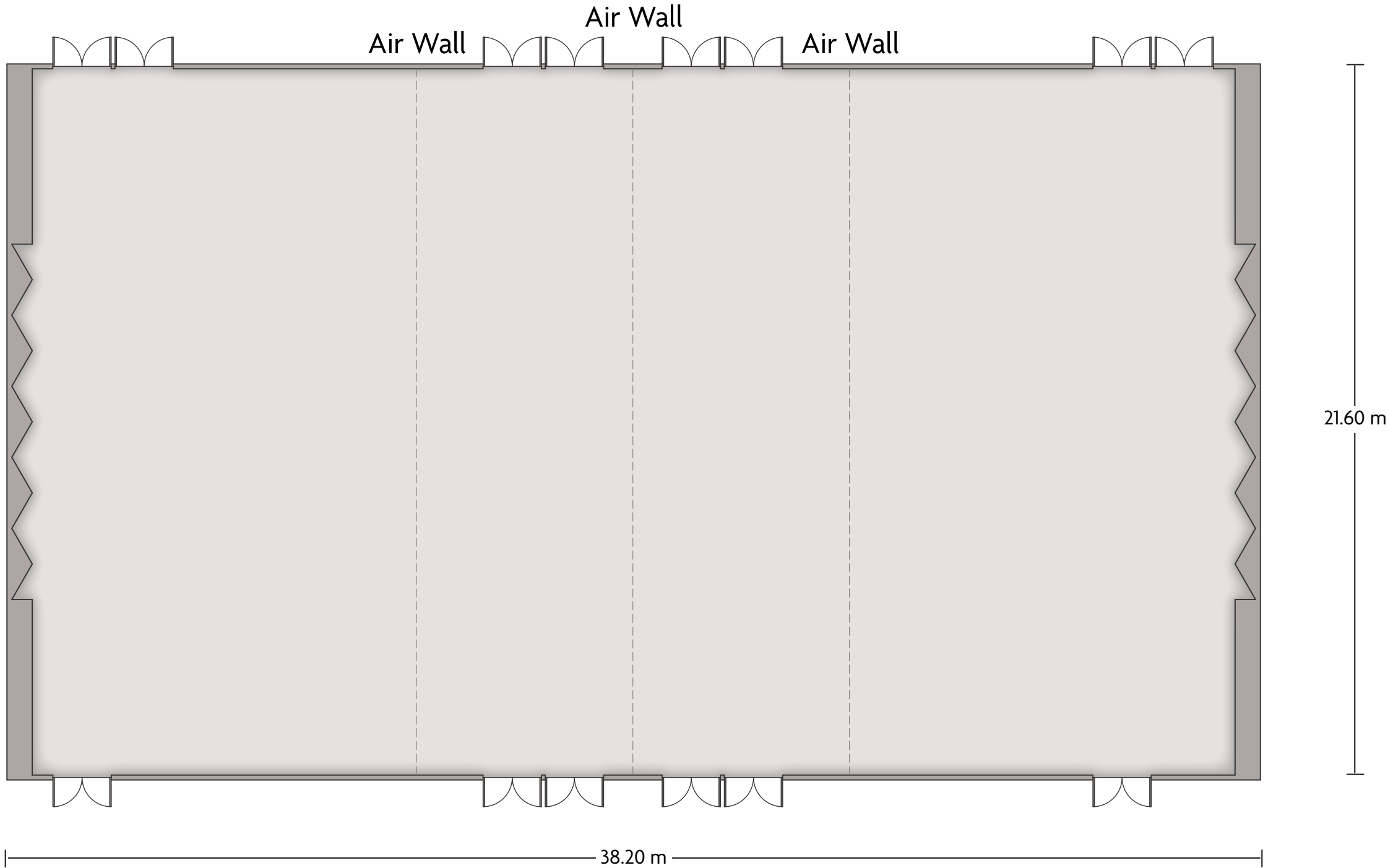

LENGTH: 38.20 m    WIDTH: 21.60 m    HEIGHT: 6.00 m    TOTAL SQUARE METERS: 1000 m<sup>2</sup>    MAXIMUM CAPACITY: 1200    POWER OUTLETS: 14

16-3 Showa-Machi I Kanazawa-shi Ishikawa, Japan - 920-8518 | 81-76-2246111 \*Multiple layout options available for this space.

# ANA Crowne Plaza® Kanazawa - Ootori (Center 1/3)



LENGTH: 21.60 m    WIDTH: 12.40 m    HEIGHT: 6.00 m    TOTAL SQUARE METERS: 330 m<sup>2</sup>    MAXIMUM CAPACITY: 300    POWER OUTLETS: 2

16-3 Showa-Machi I Kanazawa-shi Ishikawa, Japan - 920-8518 | 81-76-2246111    \*Multiple layout options available for this space.

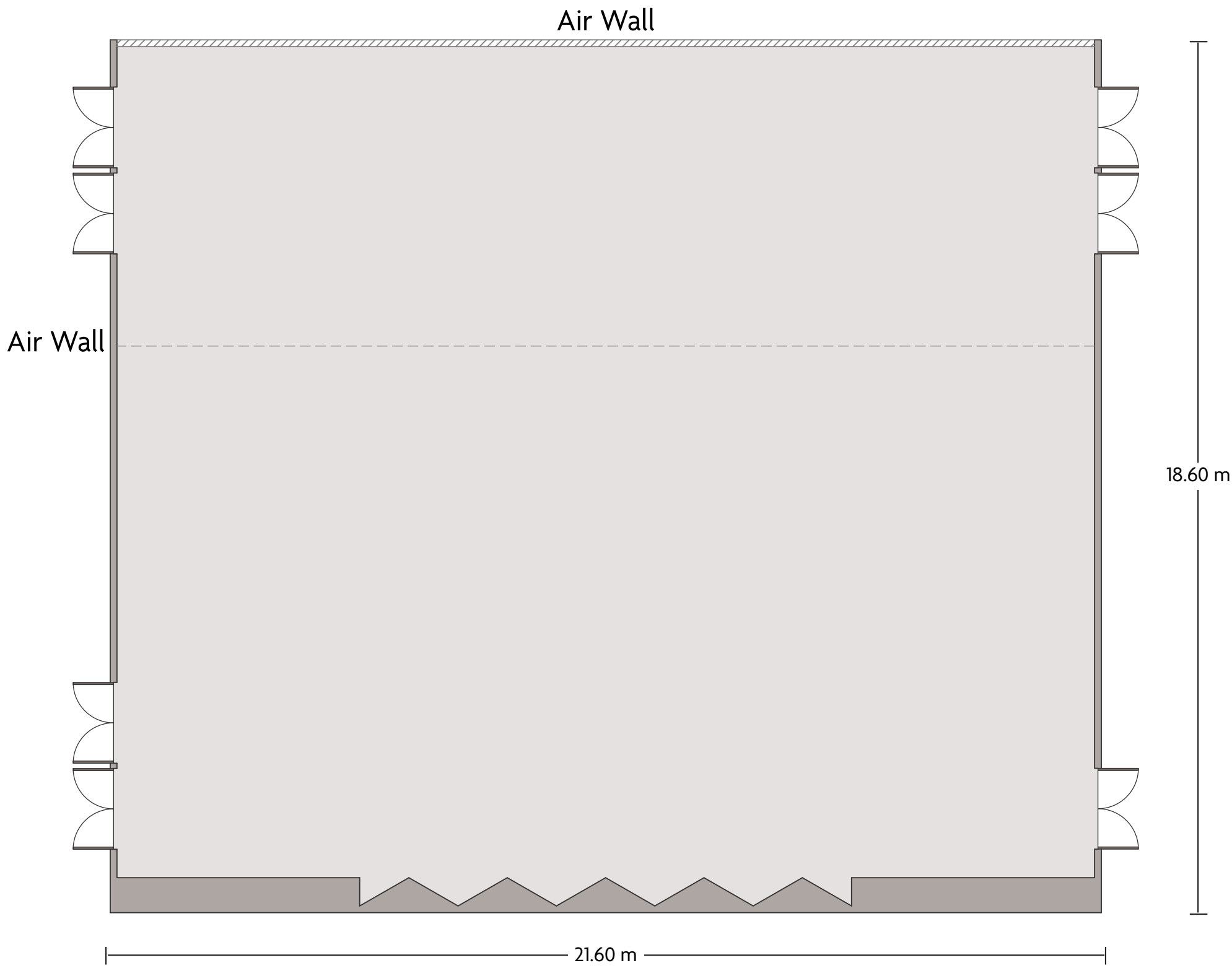

LENGTH: 21.60 m    WIDTH: 18.60 m    HEIGHT: 6.00 m    TOTAL SQUARE METERS: 490 m<sup>2</sup>    MAXIMUM CAPACITY: 500    POWER OUTLETS: 4

16-3 Showa-Machi I Kanazawa-shi Ishikawa, Japan - 920-8518 | 81-76-2246111 \*Multiple layout options available for this space.

# ANA Crowne Plaza® Kanazawa - Ootori (West 1/2)

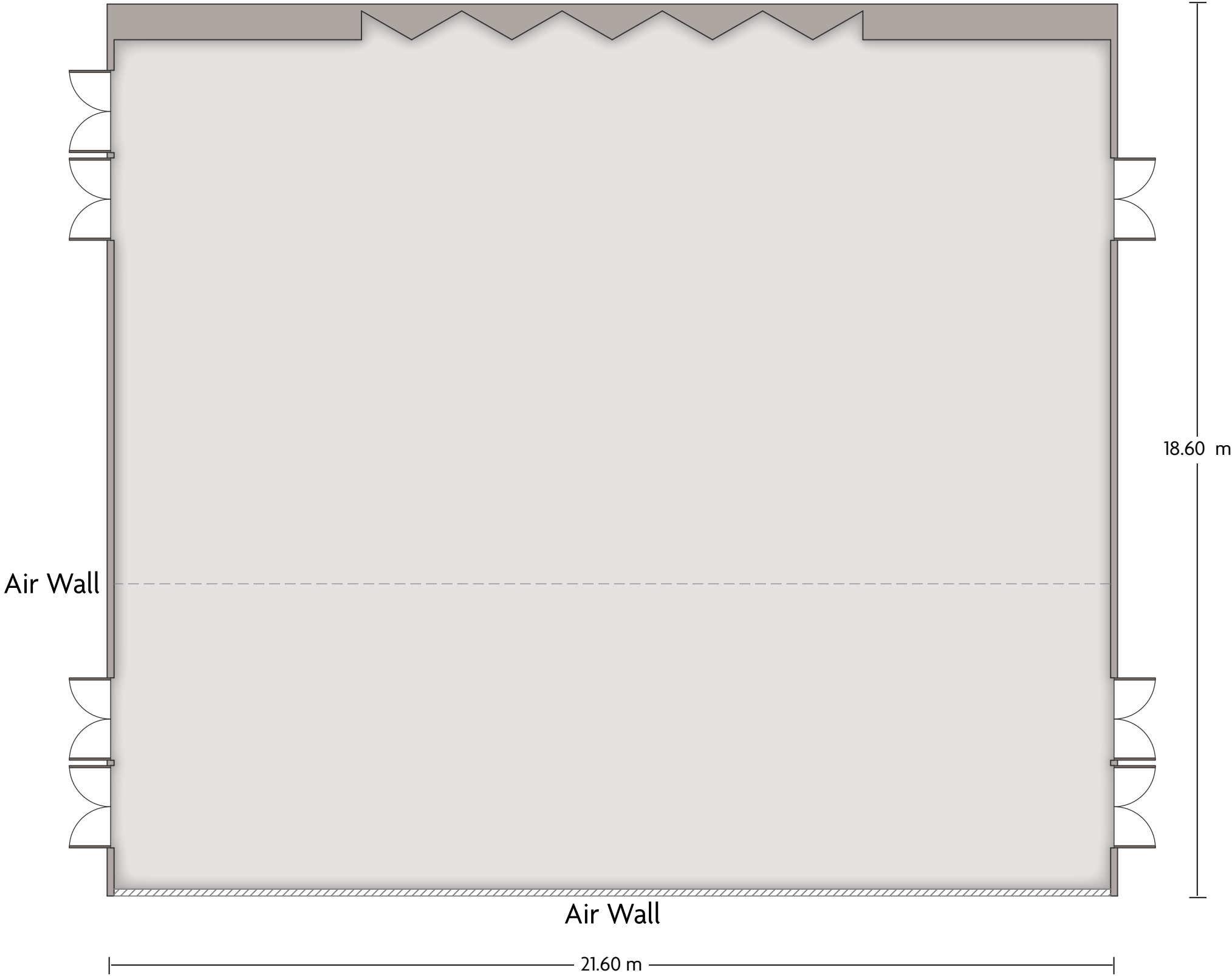

LENGTH: 21.60 m    WIDTH: 18.60 m    HEIGHT: 6.00 m    TOTAL SQUARE METERS: 490 m<sup>2</sup>    MAXIMUM CAPACITY: 500    POWER OUTLETS: 4

16-3 Showa-Machi I Kanazawa-shi Ishikawa, Japan - 920-8518 | 81-76-2246111 \*Multiple layout options available for this space.

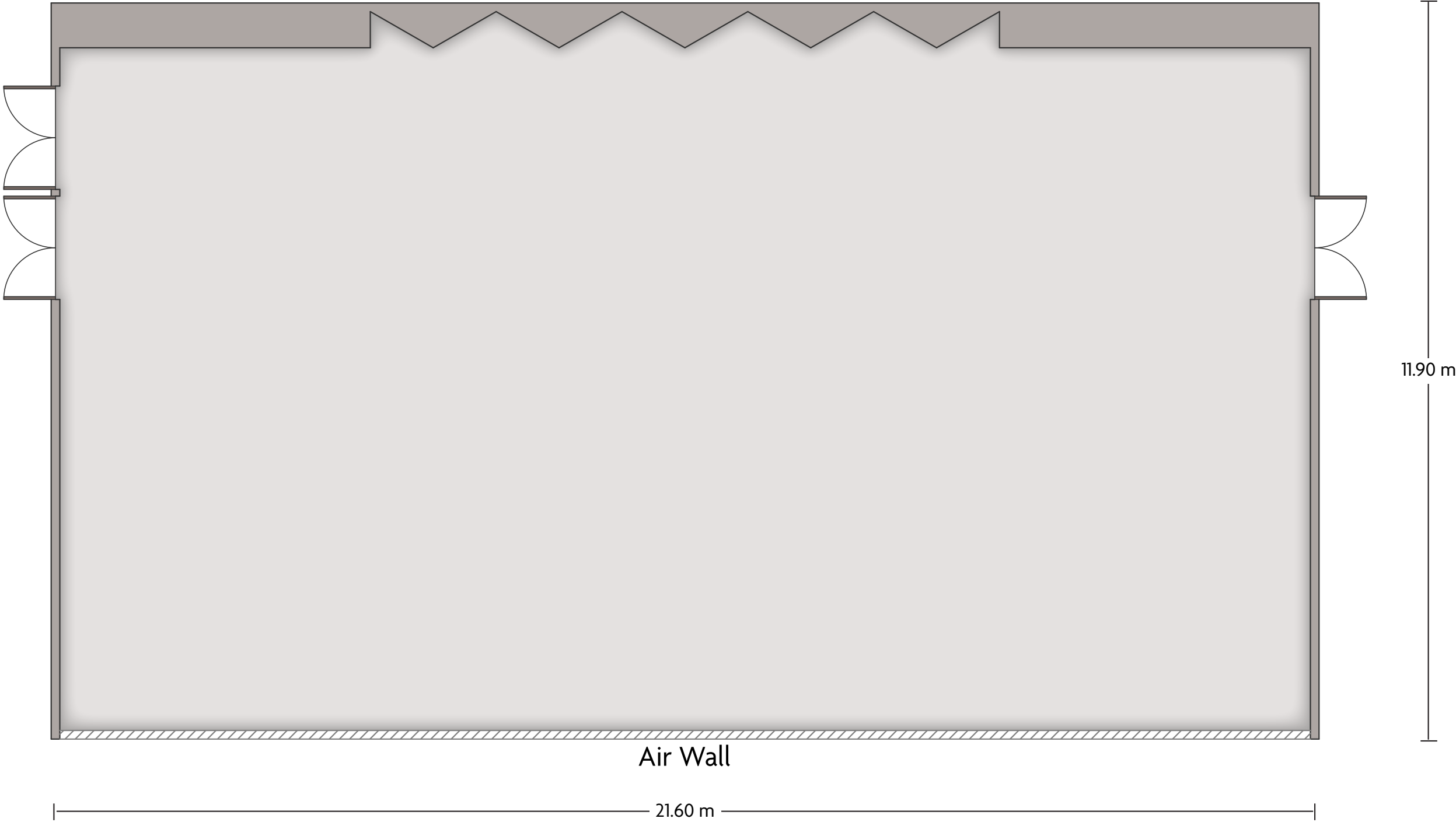

LENGTH: 21.60 m    WIDTH: 11.90 m    HEIGHT: 6.00 m    TOTAL SQUARE METERS: 330 m<sup>2</sup>    MAXIMUM CAPACITY: 300    POWER OUTLETS: 4

16-3 Showa-Machi I Kanazawa-shi Ishikawa, Japan - 920-8518 | 81-76-2246111 \*Multiple layout options available for this space.



# ANA Crowne Plaza® Kanazawa - Zuiun (I)

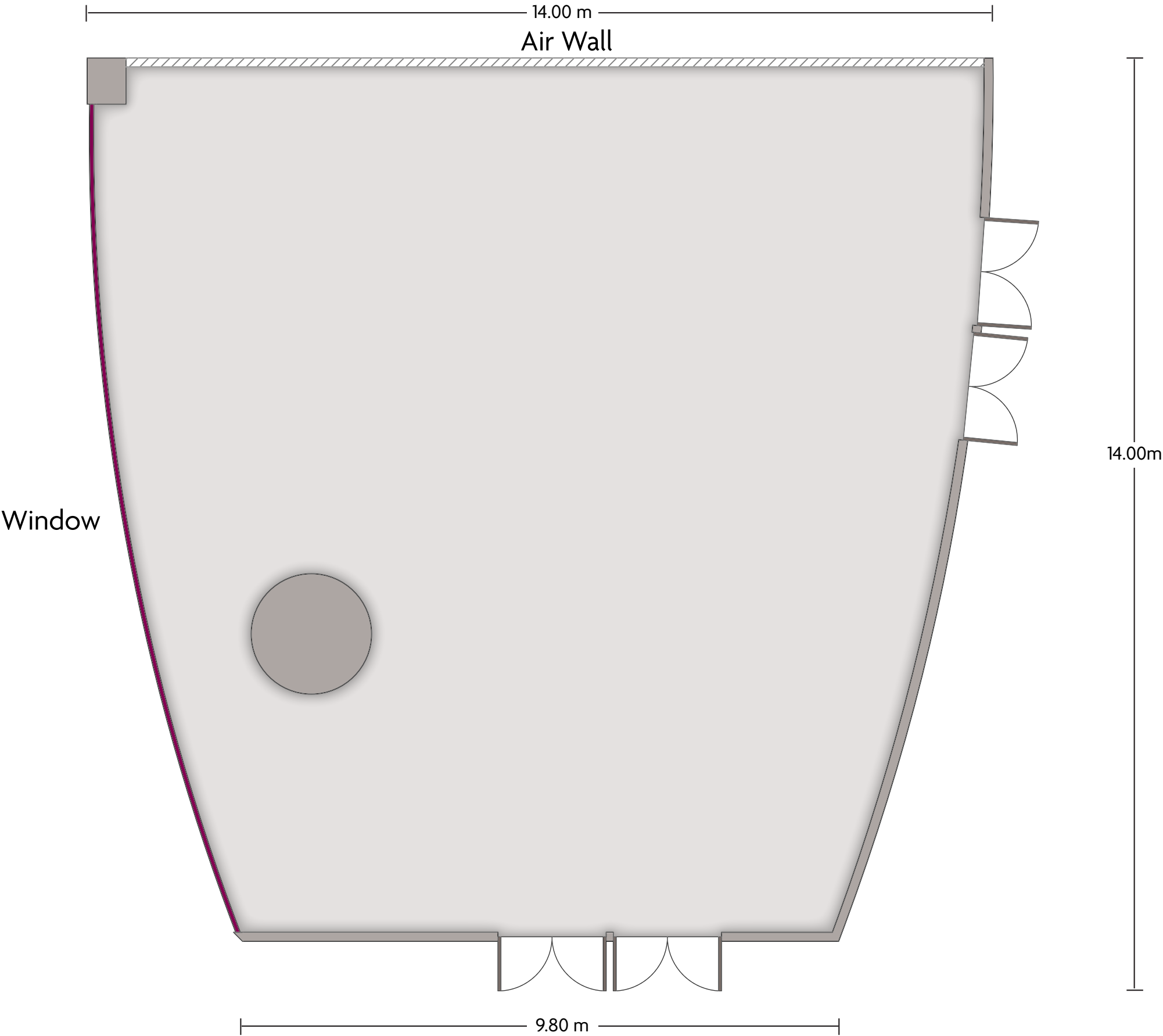

LENGTH: 14.00 m    WIDTH: 14.00 m    HEIGHT: 3.00 m    TOTAL SQUARE METERS: 185 m<sup>2</sup>    MAXIMUM CAPACITY: 140    POWER OUTLETS: 3

16-3 Showa-Machi I Kanazawa-shi Ishikawa, Japan - 920-8518 | 81-76-2246111 \*Multiple layout options available for this space.

# ANA Crowne Plaza® Kanazawa - Zuiun (II)

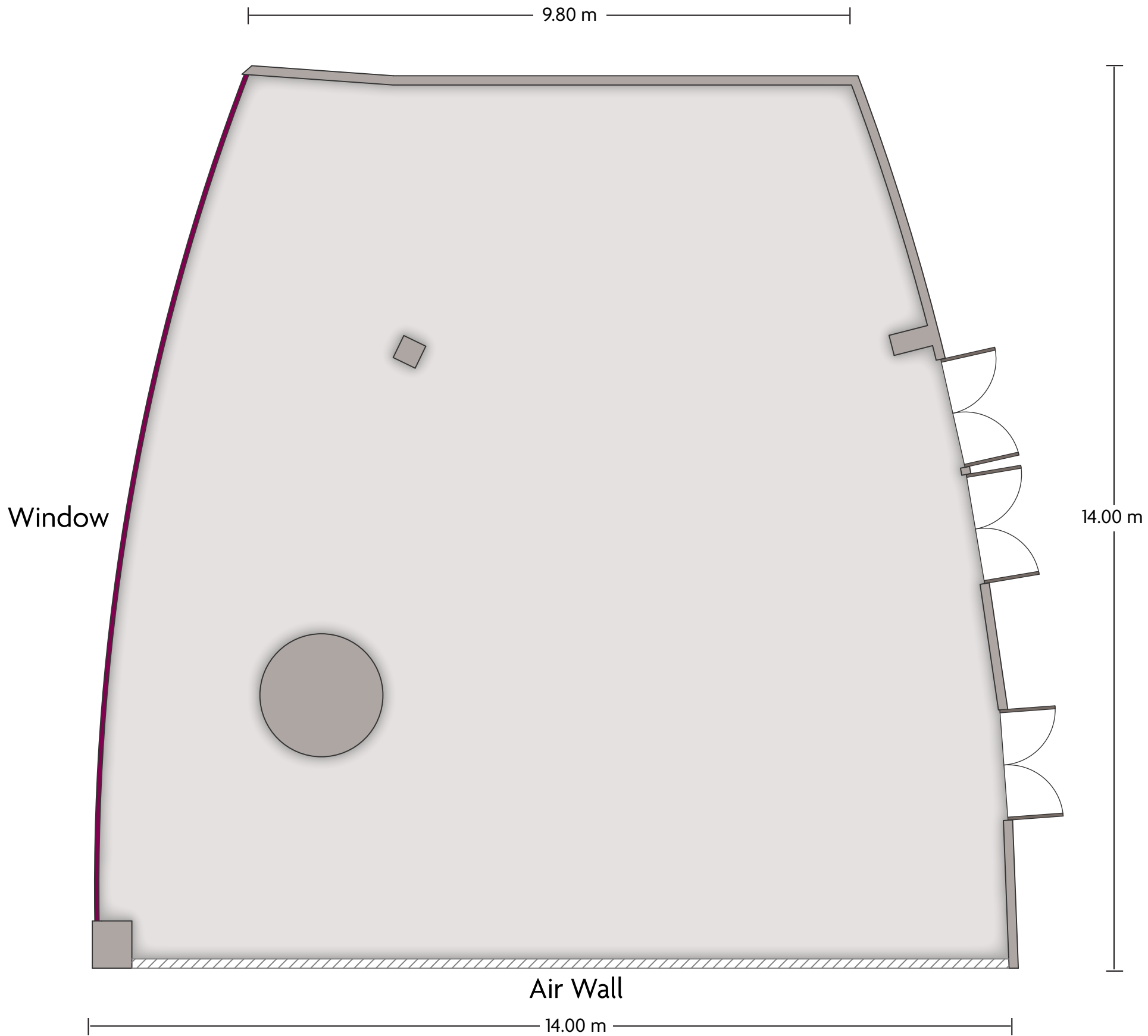

LENGTH: 14.00 m    WIDTH: 14.00 m    HEIGHT: 3.00 m    TOTAL SQUARE METERS: 185 m<sup>2</sup>    MAXIMUM CAPACITY: 140    POWER OUTLETS: 4

16-3 Showa-Machi I Kanazawa-shi Ishikawa, Japan - 920-8518 | 81-76-2246111    \*Multiple layout options available for this space.

# ANA Crowne Plaza® Kanazawa - Zuiun (Full)

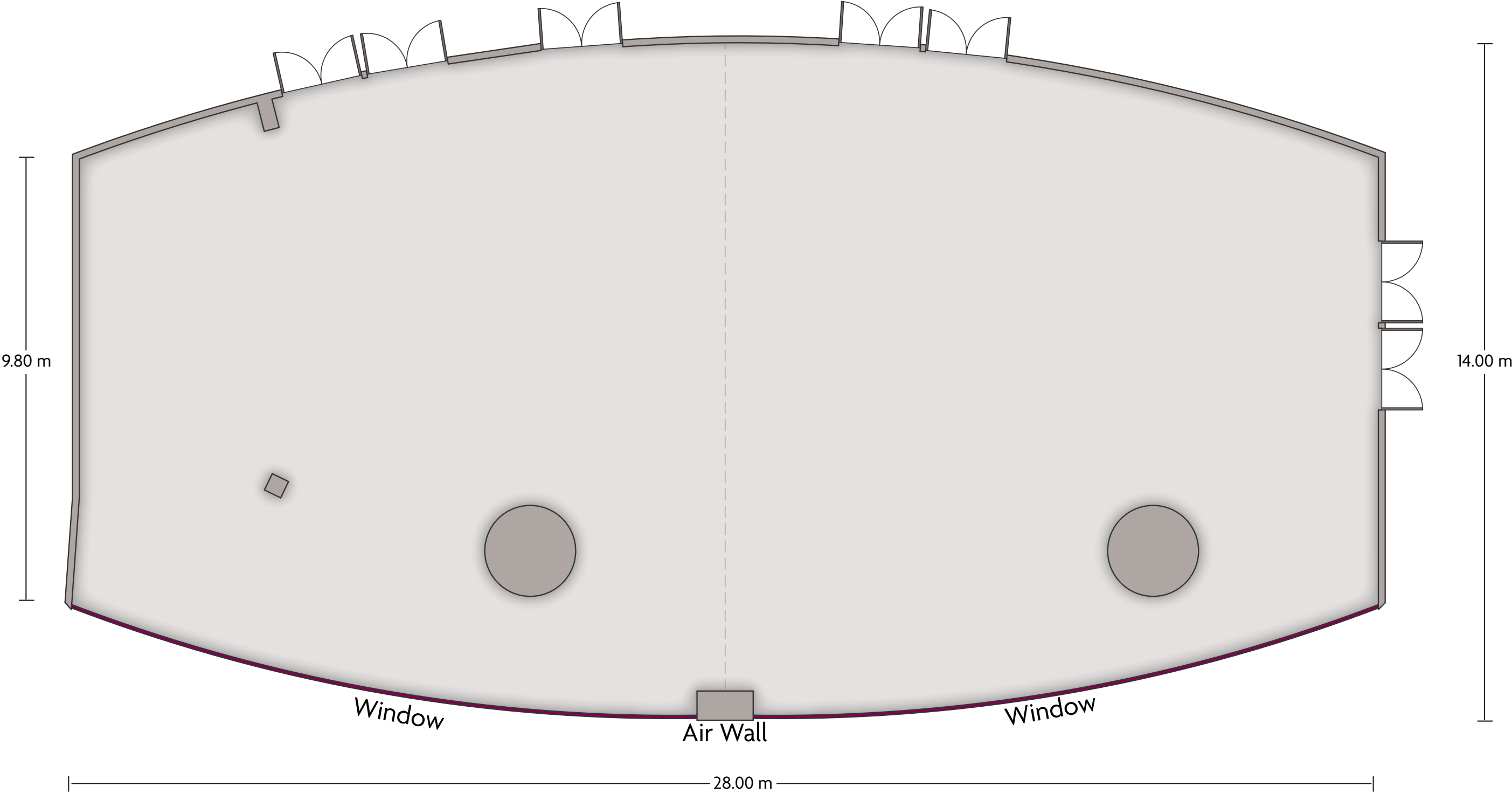

LENGTH: 28.00 m    WIDTH: 14.00 m    HEIGHT: 3.00 m    TOTAL SQUARE METERS: 370 m<sup>2</sup>    MAXIMUM CAPACITY: 350    POWER OUTLETS: 7

16-3 Showa-Machi I Kanazawa-shi Ishikawa, Japan - 920-8518 | 81-76-2246111 \*Multiple layout options available for this space.