



CROWNE PLAZA®
LOS ANGELES - INT'L AIRPORT

MEET WITH CONFIDENCE | EVENT SPACE

Whenever and wherever you travel, IHG® Hotels & Resorts is ready to meet you there. When you are ready to plan your next meeting or group event, you can book with confidence with our new flexible meeting offer.

Providing a safe, healthy, and clean stay for every traveler has always been important to us and this allows you to stay focused on your meeting objectives. Giving you the additional confidence in our approach is more critical to us than ever before. IHG will continue to refine and update the plan as guidance continues to evolve from global health organizations including the World Health Organization (WHO) and Central for Disease Control (CDC), and state and local authorities.

MEETING & FUNCTION SPACE			CAPACITY				
	Floor/Rm #	Unit (SF)	Classroom 1 per 6'	Theater	U Shape or Conference	Reception	Banquet RD of 4
Continental Ballroom	1st Floor	5,876	73	131	26	131	100
Salon A	1st Floor	1,482	18	33	7	33	25
Salon B	1st Floor	1,456	18	32	6	32	25
Salon C	1st Floor	1,456	18	32	6	32	25
Salon D	1st Floor	1,482	18	33	7	33	25
Burgundy-Bordeaux	1st Floor	1,408	17	31	6	31	24
Burgundy	1st Floor	704	9	16	3	16	12
Bordeaux	1st Floor	704	9	16	3	16	12
Colombard-Moselle	1st Floor	1,408	17	31	6	31	24
Napa-Sonoma	2nd Floor	1,008	12	22	4	22	17
Napa	2nd Floor	504	6	11	2	11	9
Sonoma	2nd Floor	504	6	11	2	11	9
Santa-Barbara	2nd Floor	504	6	11	2	11	9
Monterey-Mendocino	2nd Floor	1,008	12	22	4	22	17
Monterey	2nd Floor	504	6	11	2	11	9
Mendocino	2nd Floor	504	6	11	2	11	9
Los Alamos	2nd Floor	504	6	11	2	11	9
Santa Ynez	2nd Floor	504	6	11	2	11	9
Temecula	2nd Floor	504	6	11	2	11	9
Santa Cruz	2nd Floor	456	6	10	2	10	8
Executive Boardroom	2nd Floor	456			10		

Subject to change without notice.



Click or tap here to enter text.



Click or tap here to enter text.



Click or tap here to enter text.



CROWNE PLAZA®

LOS ANGELES - INT'L AIRPORT

LOCATION

The Crowne Plaza is located 1/2 mile from LAX on Century Boulevard, near the El Segundo/South Bay business district and just 12 miles from downtown Los Angeles. We are close to major free-ways with easy access to all Southern California attractions. California's most beautiful coastal beaches are located just minutes from the hotel.



CLUB FLOOR

- 42 Crowne Plaza Club Level rooms on a private access floor
- Private Club Lounge - open Monday through Friday. Serves a lavish complimentary continental breakfast buffet, evening hors d'oeuvres and beer & wine
- Nightly turn-down service
- Luxurious bathrobes
- Bottled water
- Two 2-line speaker telephones with voicemail
- Upgraded bath amenities

GUEST SERVICES

- 24 hour complimentary airport transportation
- Scheduled shuttle to Manhattan Beach Pier, Manhattan Village Mall and Plaza El Segundo
- Outdoor heated pool
- Complete exercise facility
- Valet and laundry service available
- Safe deposit boxes
- Concierge desk
- Business services
- Gift shop
- Car rental available

GUEST ROOM FEATURES

- 613 newly renovated rooms including 4 suites
- Sleep advantage amenities
- Wireless internet access
- Magnified makeup mirrors
- Color flat screen TV with complimentary HBO
- CD player with AM/FM alarm clock radio
- Two 2-line speaker telephones with voicemail
- Hair dryers
- 100% Non Smoking
- Coffee maker with complimentary coffee and tea
- Iron and ironing board



MEETING ROOMS

- 18 meeting rooms accommodating from 10 to 600 people
- Experienced conference service staff
- In-house audiovisual services
- Individual climate control
- State of the art video conferencing available
- Crowne Meetings Director

DINING & ENTERTAINMENT

- **The Landings Restaurant**
Open daily for from 6 am - 10 am for breakfast, and breakfast buffets
- **Boulevard Market Cafe**
Cafe is open from 6 am - 12 midnight
Coffee, cold Beverages & Snacks to-go.
- **Century Taproom**
Restaurant and Gastro Pub serving extensive selection of draft beers, local micro brews, & cocktails. Our menu features steaks, pizzas & all day menu with fresh local ingredients. **Live Jazz entertainment** with world class musicians every Thursday evening.
- **Yokoso Sushi Bar**
Watch our master Japanese sushi chefs prepare fresh sushi, and rolls. Try our Sake tasting at the sushi bar, or socialize at the fun communal table.

AREA ATTRACTIONS

- Manhattan, Hermosa and Redondo Beaches
- Santa Monica
- Marina Del Rey
- Manhattan Village Mall, Plaza El Segundo, Beverly Center and Century City Shopping Center
- Universal Studios
- Disneyland
- Staples Center & LA Live

"Your Success Matters"



5985 West Century Boulevard
Los Angeles, CA 90045
Tel: (310) 642-7500 • Fax: (310) 342-7010
www.crowneplazalax.com
Email: cplosangelesreservations@ihg.com

MEETING AND BANQUET FACILITIES

Our professional Sales and Catering Team are available to ensure the success and comfort of your next company function, retreat, or social gathering.

We offer 14,000 square feet of flexible, column-free meeting space which can accommodate an intimate group of 5 to banquets for 500. All meeting rooms and each section of our Ballroom have built-in white boards and all first floor meeting rooms have built-in screens.

From Sales Meetings to Banquets to Executive Board Meetings, we have the space for your event.

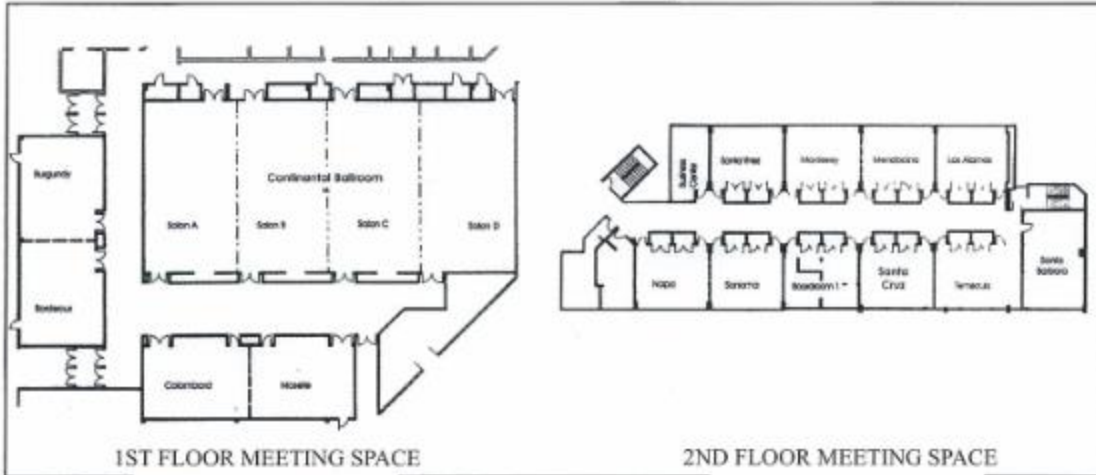

	Capacities						Dimensions			
	Theater	Classroom	Conf.	U	Banquet	Recpt.	Length & Width	Sq. Ft.	Ceiling	
Continental Ballroom	675	400	N/A	210	500	800-Flow	113'x52'	5876	10/12	
Salon A	150	100	62	52	120	200	52'x26.5'	1482	10/12	
Salon B	150	100	62	52	120	200	52'x26'	1456	10/12	
Salon C	150	100	62	52	120	200	52'x26'	1456	10/12	
Salon D	150	100	62	52	120	200	52'x26.5'	1482	10/12	
First Floor-Meeting Rooms										
Burgundy	65	40	25	30	60	75	32'x22'	704	10 1/2	
Bordeaux	65	40	25	30	60	75	32'x22'	704	10 1/2	
Combined	150	80	50	65	120	150	64'x22'	1408	10 1/2	
Colombard	65	40	25	30	60	75	32'x22'	704	10 1/2	
Moselle	65	40	25	30	60	75	32'x22'	704	10 1/2	
Combined	150	80	50	65	120	150	64'x22'	1408	10 1/2	
Second Floor-Conference Rooms										
Napa	40	24	15	18	40	40	24'x21'	504	9	
Sonoma	40	24	15	18	40	40	24'x21'	504	9	
Combined	80	48	15	36	80	80	48'x21'	1008	9	
Santa Barbara	40	24	20	18	40	40	27'x20'	504	9	
Monterey	40	24	15	18	40	40	24'x21'	504	9	
Mendocino	40	24	15	18	40	40	24'x21'	504	9	
Combined	80	48	30	36	80	80	48'x21'	1008	9	
Los Alamos	40	24	20	18	40	40	24'x21'	504	9	
Santa Ynez	40	24	20	18	40	40	24'x11'	504	9	
Temecula	40	24	20	18	40	40	24'x11'	504	9	
Board Room	Permanent Seating for 10							24'x11'	456	9
Santa Cruz							24'x11'	456	9	



CROWNE PLAZA®
LOS ANGELES - INT'L AIRPORT
1-800-2CROWNE

SABRE CP3360 ■ APOLLO CP2038 ■ WORLDSPAN CP1713 ■ SYSTEM ONE/ AMADEUS LAX6B1

www.crowneplazalax.com

Subject to change without notice.

Crowne Plaza Los Angeles International Airport

5985 W. Century Blvd • Los Angeles, CA 90045

Tel. 310-642-7500 | CPLosAngeles.com

IHG Travel Advisory Policy