



MEET WITH CONFIDENCE | EVENT SPACE

Whenever and wherever you travel, IHG® Hotels & Resorts is ready to meet you there. When you are ready to plan your next meeting or group event, you can book with confidence with our new flexible meeting offer.

Providing a safe, healthy, and clean stay for every traveler has always been important to us and this allows you to stay focused on your meeting objectives. Giving you the additional confidence in our approach is more critical to us than ever before. IHG will continue to refine and update the plan as guidance continues to evolve from global health organizations including the World Health Organization (WHO) and Central for Disease Control (CDC), and state and local authorities.

MEETING & FUNCTION SPACE			CAPACITY				
	Floor/Rm #	Unit (SF)	Classroom 1.5 per 6'	Theater	U Shape or Conference	Reception	Banquet RD of 6
The Range Ballroom	1st Floor	4,692	104	188	38	188	144
Torrey's	1st Floor	850	19	34	7	34	26
Oxford	1st Floor	1,360	30	54	11	54	42
Pikes Peak	1st Floor	1,224	27	49	10	49	38
Humboldt	1st Floor	1,258	28	50	10	50	39
Range Ballroom Pre-function Area	1st Floor	1,209				48	37
Ellingwood A&B	1st Floor	1,593	35	64	13	64	49
Ellingwood A	1st Floor	810	18	32	6	32	25
Ellingwood B	1st Floor	783	17	31	6	31	24
Red Cloud	1st Floor	960	21	38	8	38	30
Boardroom	1st Floor	630	14	25	5	25	19
The Studio	1st Floor	437	10	17	3	17	13
The Lockwood	1st Floor	1,148	26	46	9	46	35

Subject to change without notice.

Crowne Plaza Downtown Denver
 1450 Glenarm Pl • Denver, CO 80202
 Tel. 303-573-1450 | CPDenverowntown.com
[IHG Travel Advisory Policy](#)



Torrey's and Oxford



Pikes Peak



Humboldt

Subject to change without notice.

Crowne Plaza Downtown Denver
1450 Glenarm Pl • Denver, CO 80202
Tel. 303-573-1450 | CPDenverowntown.com
IHG Travel Advisory Policy

FUNCTION SPACE DIAGRAM

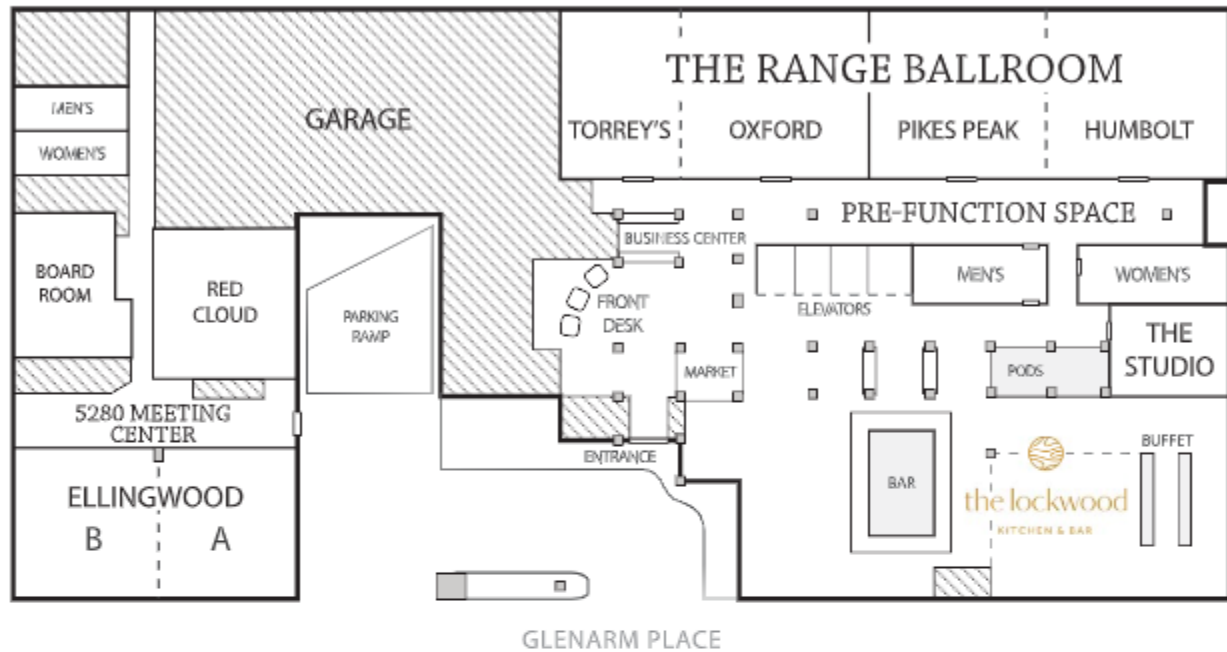

	Dimensions	Square Feet	Rounds	Theater	Classroom	U-Shape	Conference	Hollow Square
Range Ballroom	34' x 138'	4,692	290	420	300	144	132	150
Torrey's	34' x 25'	850	40	80	45	33	24	36
Oxford	34' x 40'	1,350	80	119	75	39	36	48
Pikes Peak	34' x 36'	1,224	80	105	75	39	30	48
Humbolt	34' x 37'	1,258	80	117	72	42	30	48
Ellingwood A	27' x 30'	797	50	65	56	29	27	30
Ellingwood B	27' x 59'	797	50	65	56	29	27	30
Red Cloud	32' x 30'	960	60	80	72	33	30	36
The Studio	19' x 23'	437	N/A	N/A	N/A	N/A	10	N/A
The Boardroom	30' x 21'	630	32	55	32	26	24	28

*Figures are at max capacity and do not include space for A/V or food and beverage set-up.



CROWNE PLAZA
DENVER

Subject to change without notice.

Crowne Plaza Downtown Denver
1450 Glenarm Pl • Denver, CO 80202
Tel. 303-573-1450 | CPDenverowntown.com
[IHG Travel Advisory Policy](#)