



INTERCONTINENTAL
HOTELS & RESORTS

MEET WITH CONFIDENCE | EVENT SPACE

Whenever and wherever you travel, IHG® Hotels & Resorts is ready to meet you there. When you are ready to plan your next meeting or group event, you can book with confidence with our new flexible meeting offer.

Providing a safe, healthy, and clean stay for every traveler has always been important to us and this allows you to stay focused on your meeting objectives. Giving you the additional confidence in our approach is more critical to us than ever before. IHG will continue to refine and update the plan as guidance continues to evolve from global health organizations including the World Health Organization (WHO) and Central for Disease Control (CDC), and state and local authorities.

2nd Floor Meeting Space	72" Rounds		Hollow					
	(6 per / 3 per)	Theatre	Classroom (1 per 6')	U-Shape (1 per 6')	Square (1 per 6')	Conference (1 per 6')	Crescent (3 per 72")	Reception
Abigail Adams Ballroom	168/84	90	60	26	32	24	72	90
Abigail Adams Pre-Function	-	-	-	-	-	-	-	85
Abigail Adams A	60/30	37	20	15	18	16	21	37
Abigail Adams B	60/30	34	20	15	18	16	21	34
Abigail Adams C	60/30	34	20	14	16	16	21	34
Abigail Adams AB	120 / 60	60	36	19	26	18	42	60
Griffin-Robinson	36/18	24	15	11	14	11	15	24
Griffin	18/9	11	8	8	8	7	9	14
Robinson	12, 6	11	6	6	6	7	6	11
Hutchinson	48/24	29	17	12	14	14	21	29
Wheeler	30/15	20	13	10	12	10	15	20
2nd Floor Coat Room	-	-	-	-	-	-	-	-

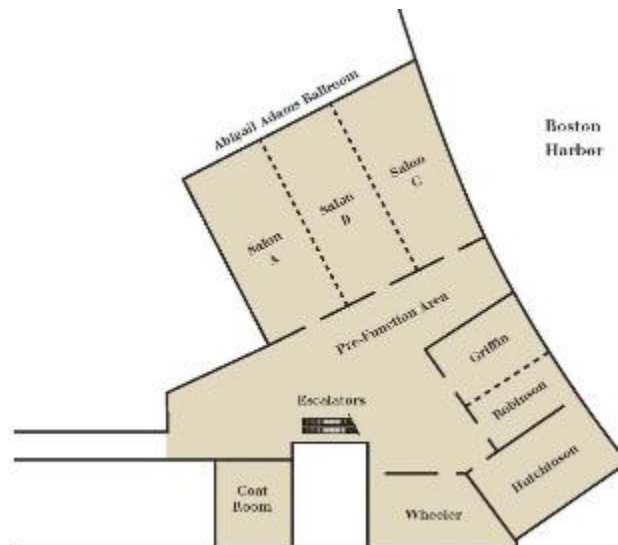

Subject to change without notice.

InterContinental Boston
510 Atlantic Avenue • Boston, MA
Tel. 617-747-1000 | ICBostonHotel.com
[IHG Travel Advisory Policy](#)

3rd Floor Space	72" Rounds	U-Shape Hollow Classroom					Crescent (3 per 72")	Reception
	Meeting (6 per / 3 per)	Theatre	(1 per 6')	(1 per 6')	(1 per 6')	(1 per 6')		
Rose Kennedy Ballroom	300/150	198	150	-	-	-	150	198
RKB 1	54/27	37	25	14	18	11	27	37
RKB 2	54/27	40	25	13	18	11	27	40
RKB 3	126/63	86	44	25	30	23	45	86
RKB 4	54/27	40	25	14	18	11	27	40
RKB 5	54/27	40	25	14	18	11	27	120
RKB 1,2	126/63	86	44	24	30	23	45	86
RKB 4,5	126/63	86	44	24	30	23	45	86
RKB 1,2,3	252/126	150	99	31	42	-	84	150
Dartmouth-Eleanor	48/24	30	20	15	18	13	21	30
Dartmouth	18/9	15	7	8	10	7	9	16
Eleanor	24/12	20	8	9	12	8	12	20
Sessions	-	-	-	-	-	7	-	-
Montague	-	-	-	-	-	4	-	-
Lexington	18/9	11	6	6	8	5	9	12

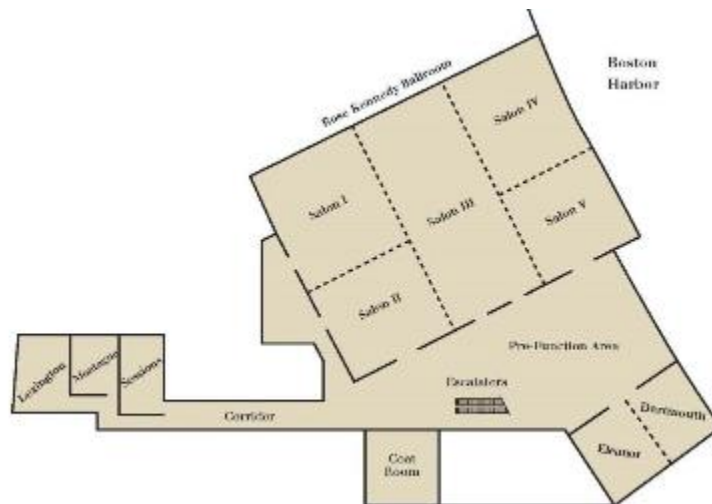

Subject to change without notice.

InterContinental Boston
 510 Atlantic Avenue • Boston, MA
 Tel. 617-747-1000 | ICBostonHotel.com
[IHG Travel Advisory Policy](#)



Abigail Adams Ballroom











Deluxe Bathroom

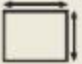
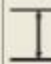

Deluxe King Waterview

Subject to change without notice.

InterContinental Boston
510 Atlantic Avenue • Boston, MA
Tel. 617-747-1000 | ICBostonHotel.com
[IHG Travel Advisory Policy](#)

Meeting Room										
	Dimensions	Height	Sq. Ft.	72" Rds 10 Banquet	Theater	3 per 6' Classroom	3 per 6' U-Shape	3 per 6' H-Square	3 per 6' Conference	Reception
Abigail Adams Ballroom	63 x 89	15.9'	4,922	320	476	268	-	-	-	518
Abigail Adams Foyer	88 x 126	-	5,216	-	-	-	-	-	-	549
Abigail Adams Ballroom Salon A	63 x 30	15.9'	1,675	100	110	81	36	42	42	176
Abigail Adams Ballroom Salon B	63 x 28	15.9'	1,622	100	96	81	42	42	42	170
Abigail Adams Ballroom Salon C	63 x 31	15.9'	1,625	100	110	81	42	42	42	171
Griffin / Robinson Room	34 x 44	13.1'	1,246	60	104	63	30	36	30	100
Griffin Room	34 x 24	13.1'	704	40	50	36	15	18	18	50
Robinson Room	31 x 20	13.1'	543	20	30	24	15	18	18	40
Hutchinson Room	28 x 48	12.6'	1,289	80	130	72	30	36	36	135
Second Floor Coat Room	22 x 23	9'	405	-	-	-	-	-	-	-
Wheeler Room	25 x 39	12.9'	883	60	70	54	24	30	24	92

SECOND LEVEL

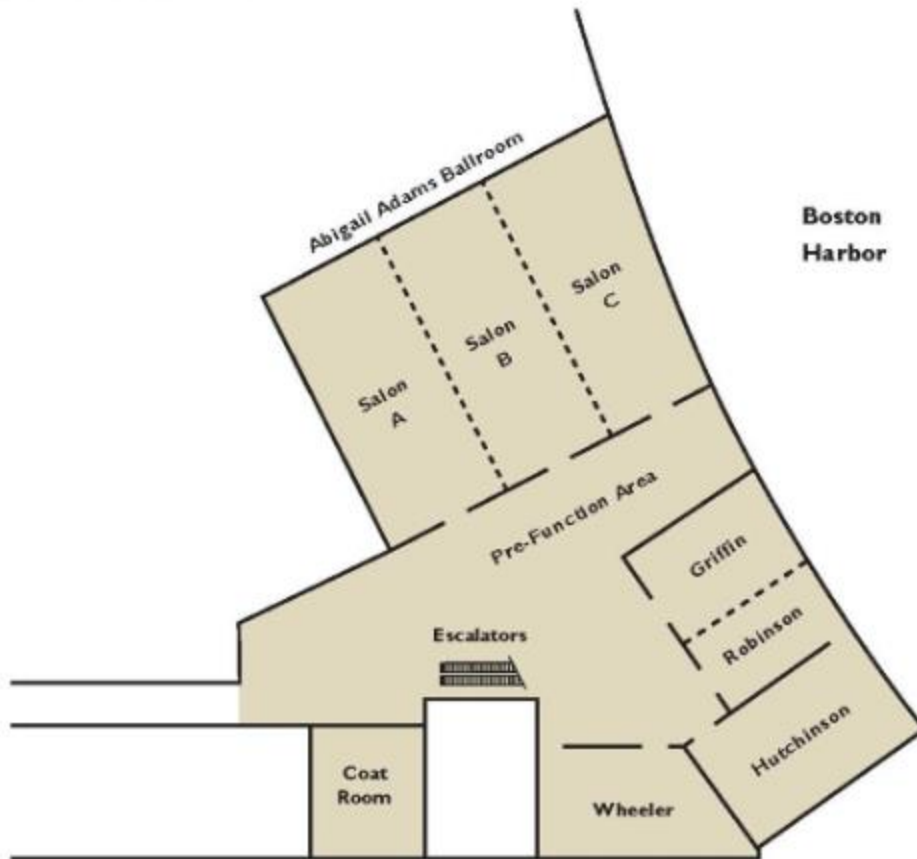

Subject to change without notice.

InterContinental Boston
 510 Atlantic Avenue • Boston, MA
 Tel. 617-747-1000 | ICBostonHotel.com
[IHG Travel Advisory Policy](#)

Meeting Room	Dimensions	Height	Sq. Ft.	72" Rds 10 Banquet	Theater	3 per 6' Classroom	3 per 6' U-Shape	3 per 6' H-Square	3 per 6' Conference	Reception
Dartmouth / Eleanor Room	33 x 53	9'	1,581	100	140	81	42	48	42	166
Dartmouth Room	33 x 25	9'	732	50	60	30	15	18	18	77
Eleanor Room	33 x 28	9'	849	60	48	36	24	30	18	89
Lexington Room	29 x 24	9.4'	564	30	30	24	15	18	20	59
Montague Room	18 x 18	9.1'	319	6	-	-	6	6	6	-
Rose Kennedy Ballroom	92 x 129	20.1'	10,653	770	912	690	-	-	-	1,121
Rose Kennedy Ballroom Foyer	82 x 173	-	5,803	-	-	-	-	-	-	610
Rose Kennedy Ballroom Salon I	52 x 45	20.1'	1,883	120	162	105	36	42	40	198
Rose Kennedy Ballroom Salon II	41 x 45	20.1'	1,750	120	144	105	36	42	40	184
Rose Kennedy Ballroom Salon III	93 x 42	20.1'	3,573	210	288	225	-	-	-	376
Rose Kennedy Ballroom Salon IV	51 x 42	20.1'	1,813	120	160	105	36	42	40	190
Rose Kennedy Ballroom Salon V	41 x 42	20.1'	1,635	100	126	72	36	42	40	172
Sessions Room	17 x 28	9.5'	450	12	-	-	11	12	12	-
Third Floor Coat Room	29 x 26	9'	673	-	-	-	-	-	-	-

THIRD LEVEL

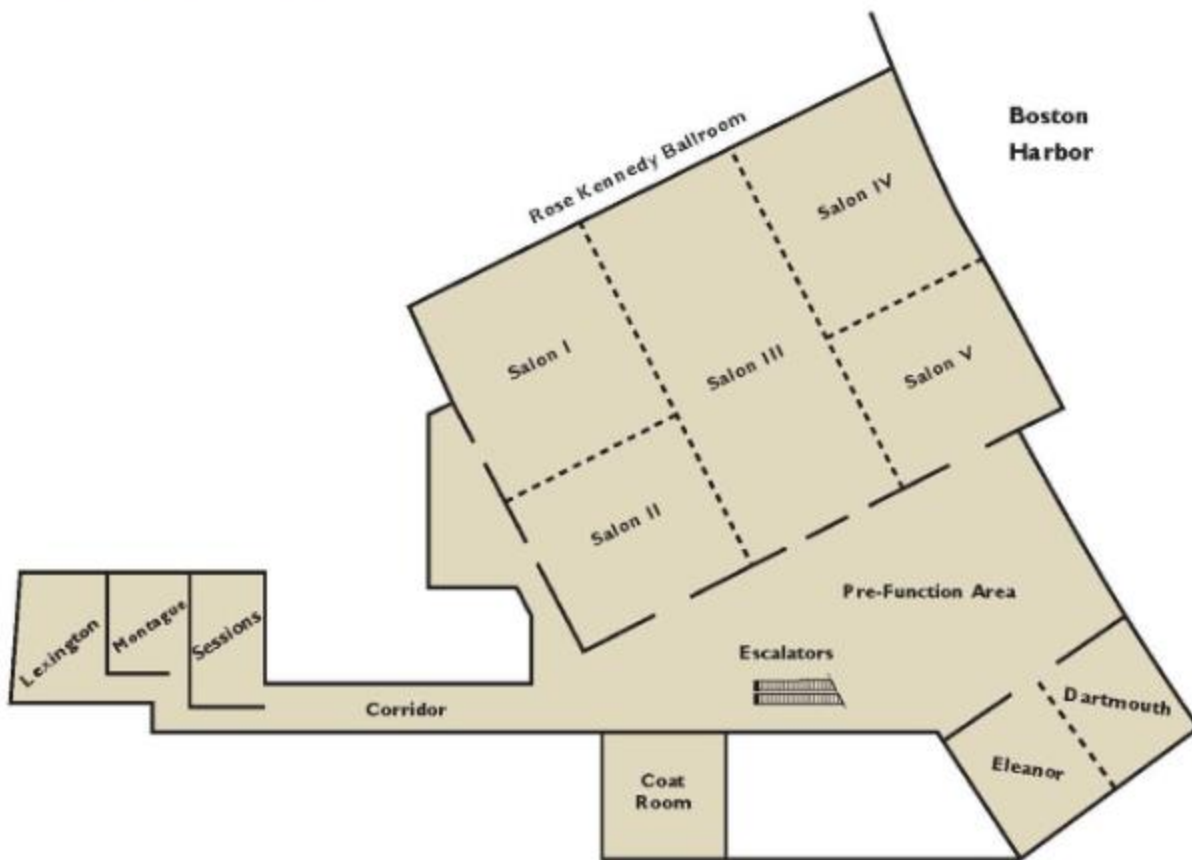

Subject to change without notice.

InterContinental Boston
 510 Atlantic Avenue • Boston, MA
 Tel. 617-747-1000 | ICBostonHotel.com
[IHG Travel Advisory Policy](#)