



INTERCONTINENTAL
HOTELS & RESORTS

MINDFUL MEETINGS | EVENT SPACE

Providing a safe, healthy, and clean stay for every traveler has always been important to us. Giving you additional confidence in our approach is more critical to us than ever before.

Because connection matters, IHG presents “Mindful Meetings” to provide physical distancing guidelines for Meetings & Events. IHG will continue to refine and update the plan as guidance continue to evolve from global health organizations including the World Health Organization (WHO) and Central for Disease Control (CDC), and state and local authorities.

MEETING & FUNCTION SPACE - LOBBY LEVEL		CAPACITY				
	Unit (SF)	Classroom	Theater	U Shape or Conference	Reception	Banquet
		1 per 6'				RD of 4
Windsor Ballroom	11,400	141	253	51	253	195
Windsor AB	3,700	46	82	16	82	63
Windsor C	4,000	49	89	18	89	68
Windsor DE	3,700	46	82	16	82	63
Windsor A	1,850	23	41	8	41	32
Windsor B	1,850	23	41	8	41	32
Windsor D	1,850	23	41	8	41	32
Windsor E	1,850	23	41	8	41	32
Venetian Ballroom	6,100	75	136	27	136	104
Venetian I	901	11	20	4	20	15
Venetian II	915	11	20	4	20	16
Venetian III	903	11	20	4	20	15
Venetian IV	863	11	19	4	19	15
Venetian V	874	11	19	4	19	15
Venetian VI	878	11	20	4	20	15
Trippe Room	2,565	32	57	11	57	44
Trippe 1	1,000	12	22	4	22	17
Trippe 2	1001	12	22	4	22	17
Trippe 3	564	7	13	3	13	10
Hope Room	2675	33	59	12	59	46
Hope 1	622	8	14	3	14	11
Hope 2	911	11	20	4	20	16
Hope 3	1142	14	25	5	25	20
Park Lane	1070	13	24	5	24	18
Willard Room	530			6		
Barclay Room	500			6		
OUTDOOR EVENT SPACE		CAPACITY				
	Unit (SF)				Reception	Banquet
						RD of 4
Windsor Garden	25,000				556	427

Subject to change without notice.

InterContinental Buckhead Atlanta
3315 Peachtree Road NE, Atlanta, GA 30326
Tel. 404-946-9000 | icbsales@ihg.com
IHG Travel Advisory Policy



Subject to change without notice.

InterContinental Buckhead Atlanta
 3315 Peachtree Road NE, Atlanta, GA 30326
 Tel. 404-946-9000 | icbsales@ihg.com
[IHG Travel Advisory Policy](#)

Name of Room	Theatre Style	Classroom	Cocktail Reception	Banquet	U-Shape	Conference Style	Square Feet	Length x Width (ft)	Height (ft)
Windsor Ballroom	1,100	680	1,000	750	40	40	11,400	147 x 79	20
Windsor AB	370	220	275	250	40	40	3,700	79 x 49	20
Windsor C	370	220	275	250	40	40	4,000	79 x 49	20
Windsor DE	370	220	275	250	40	40	3,700	79 x 49	20
Windsor A	180	100	150	120	40	40	1,850	49 x 39	20
Windsor B	180	100	150	120	40	40	1,850	49 x 39	20
Windsor D	180	100	150	120	40	40	1,850	49 x 39	20
Windsor E	180	100	150	120	40	40	1,850	49 x 39	20
Windsor Pre-Function	-	-	-	-	-	-	4,500	95 x 41	18
Windsor Office	-	-	-	-	-	-	225	-	-
Venetian Ballroom	600	300	450	320	40	40	6,100	81 x 76	17
Venetian I	90	45	75	60	24	26	901	32 x 27	17
Venetian II	90	45	75	60	24	26	915	32 x 27	17
Venetian III	90	45	75	60	24	26	903	32 x 27	17
Venetian IV	90	45	75	60	24	26	863	32 x 27	17
Venetian V	90	45	75	60	24	26	874	32 x 27	17
Venetian VI	90	45	75	60	24	26	878	32 x 27	17
Venetian Pre-Function	-	-	-	-	-	-	900	-	18
Venetian Office	-	-	-	-	-	-	100	-	-
Trippe	256	140	150	100	-	-	2,565	-	10
Trippe I	100	60	60	50	26	22	1,000	34 x 26	10
Trippe 2	100	60	60	50	26	22	1,001	34 x 28	10
Trippe 3	56	18	25	30	-	14	564	29 x 19	10
Hope	270	140	175	160	-	-	2,675	-	10
Hope 1	60	18	50	30	18	22	622	29 x 20	10
Hope 2	90	48	50	50	26	22	911	30 x 28	10
Hope 3	120	70	75	80	32	26	1,142	36 x 30	10
Hope/Trippe Pre-Function	-	-	-	-	-	-	1,000	-	10
Windsor Garden	-	-	500	-	-	-	25,000	-	-
Willard Boardroom	-	-	-	-	-	14	530	28 x 17	12
Barclay Boardroom	-	-	-	-	-	14	500	28 x 16	12
Park Lane	100	60	60	50	26	26	1,070	37 x 29	10

Subject to change without notice.

InterContinental Buckhead Atlanta
3315 Peachtree Road NE, Atlanta, GA 30326
Tel. 404-946-9000 | icbsales@ihg.com
[IHG Travel Advisory Policy](#)

INTERCONTINENTAL BUCKHEAD ATLANTA
LOBBY-LEVEL FLOORPLAN

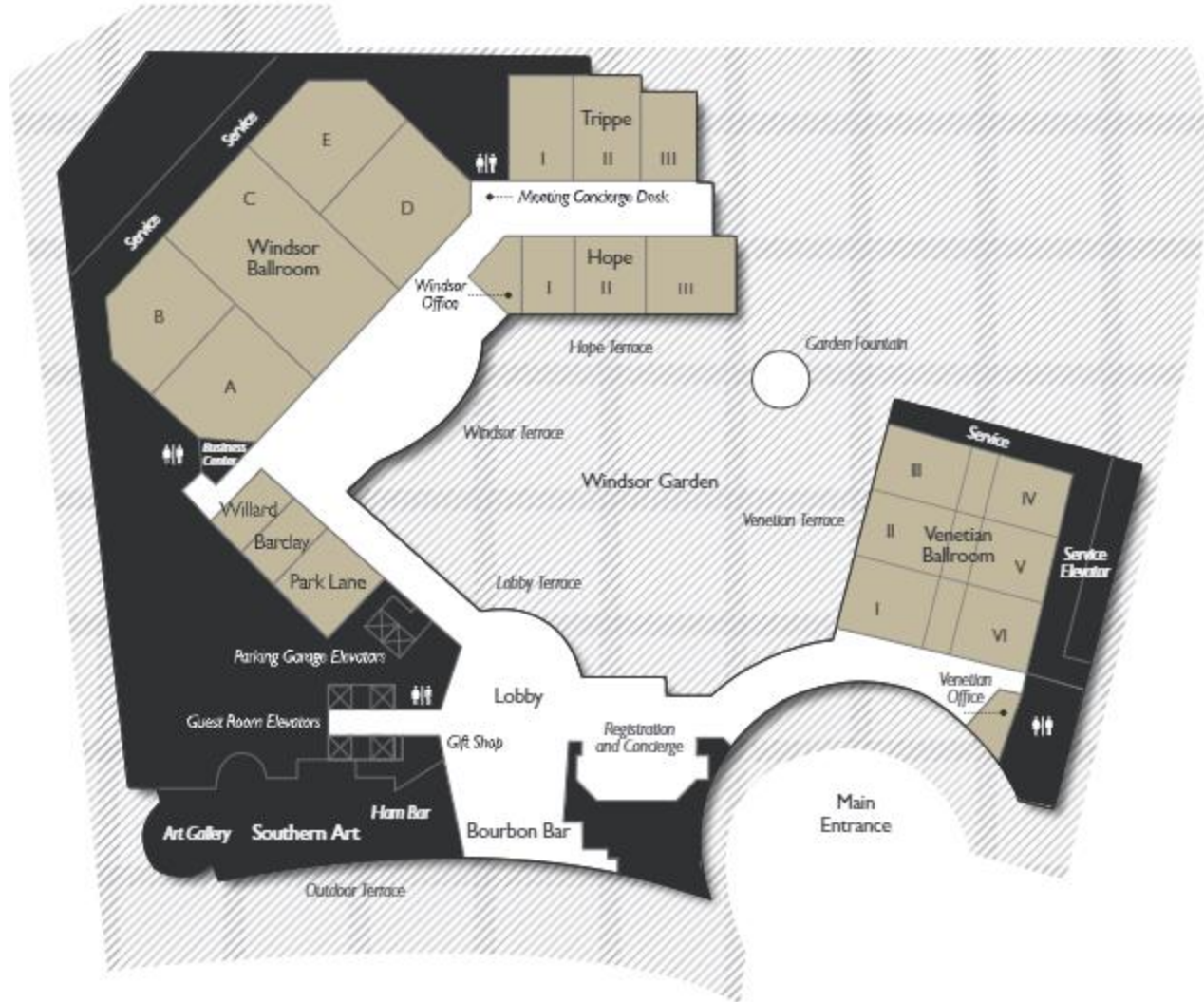

Windsor Ballroom

Subject to change without notice.

InterContinental Buckhead Atlanta
3315 Peachtree Road NE, Atlanta, GA 30326
Tel. 404-946-9000 | icbsales@ihg.com
[IHG Travel Advisory Policy](#)



Venetian Ballroom



Windsor Garden